

Hobie®  
Kayak Sail  
Furler Kit

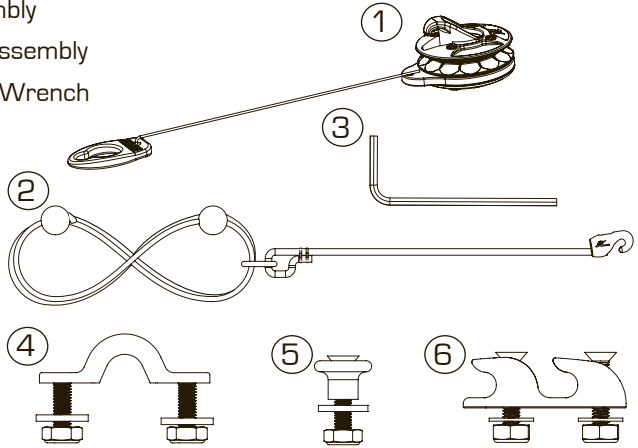

Please read through the instruction manual before using this product.

1. Furler Assembly
2. Furler Line Assembly
3. 7/64" Allen Wrench
4. Pad Eye
5. Eye Post
6. Fairlead



### 1 Furler Kit Installation

Slide furler assembly up the kayak sail mast. See FIG 1.

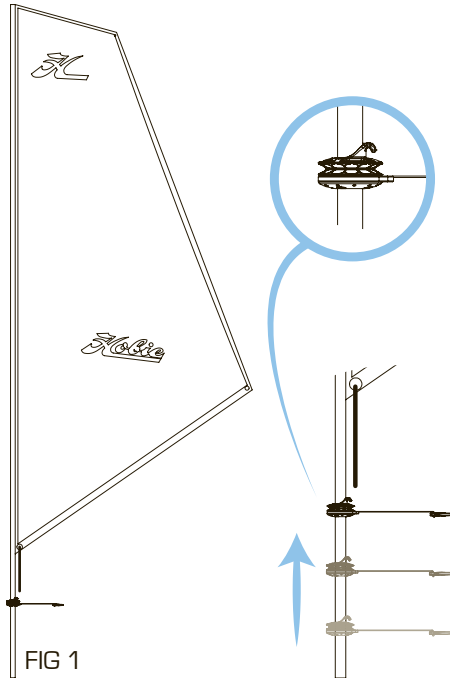

FIG 1

②

Locate the best height for the furler on the mast. This will vary depending on your kayak model. Tighten screws with the provided Allen Wrench once location is determined. Stretch shock cord attached to sail and loop around the hook on furler assembly. See FIG 2. **If the shock cord is not taut you will need to knot the shock cord to shorten the length.**

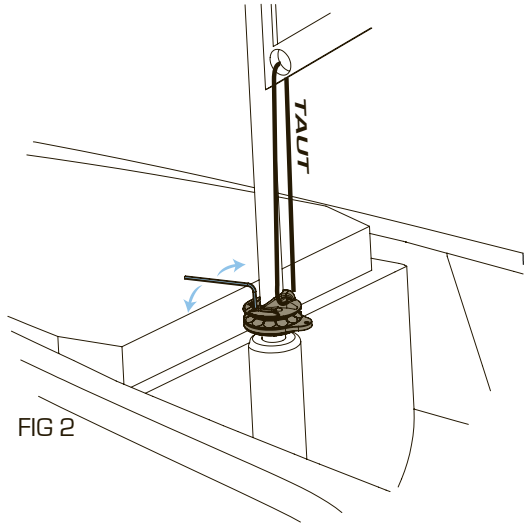

FIG 2

③

Mark the appropriate locations for the Fairlead and Eye Post before drilling and thru bolting.

### Fairlead

Mount to the rail of the kayak. Mark 5" behind mast base to the center point of the Fairlead. Use the Fairlead as a template to mark drilling locations. See FIG 3 & 5.

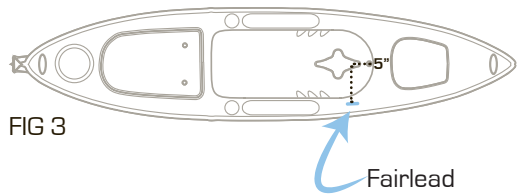

FIG 3

### Eye Post

Mark 7" to the side of the center of the mast base on the top of the firewall. Use the furler assembly to gauge the best location for the Eye Post. The downhaul line should be slack but without sag. See FIG 4 & 5.

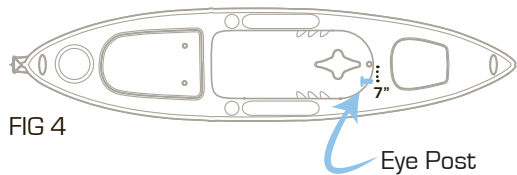

FIG 4

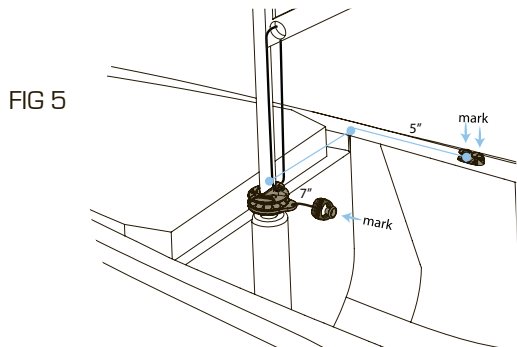
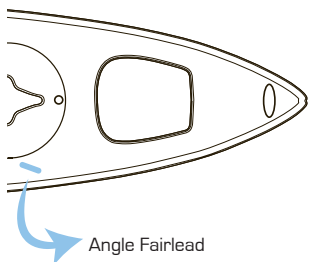
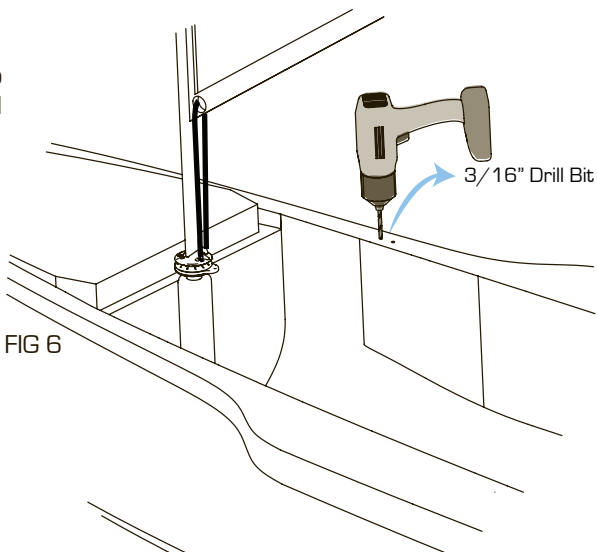

FIG 5

④

1. From the marked locations drill the two holes for the Fairlead using the  $3/16"$  drill bit. **Kayak depending, you may need to angle the Fairlead outward to eliminate furler lines from interfering with each other.** FIG 6  
See FIG 6.



2. Using a  $13/64"$  bit, proceed to drilling the hole for the Eye Post See FIG 7. FIG 7

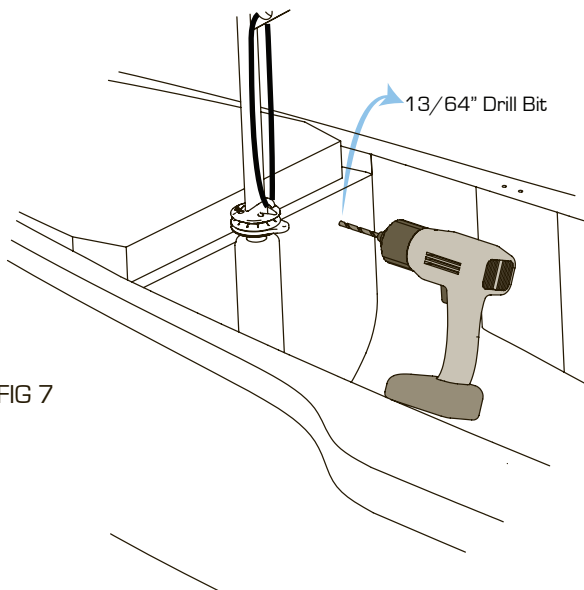

⑤

1. Thru bolt Fairlead to side rail. Access the inside of the hull through the front hatch. See FIG 8.

Wrench size  
11/32"

2. Thru bolt the Eye Post to the front firewall. Access the inside of the hull through the front hatch. See FIG 8.

Wrench size  
3/8"

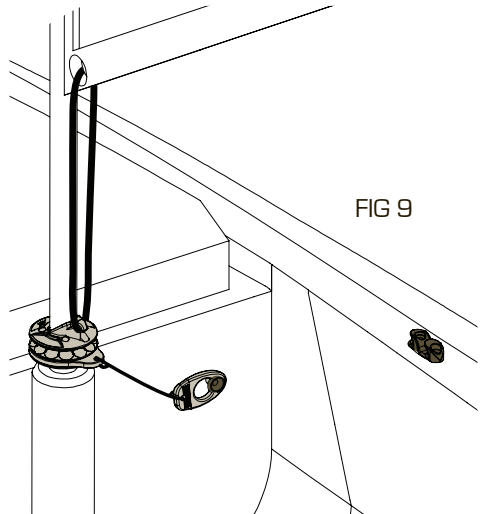
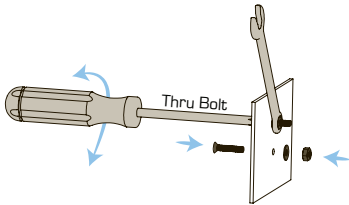
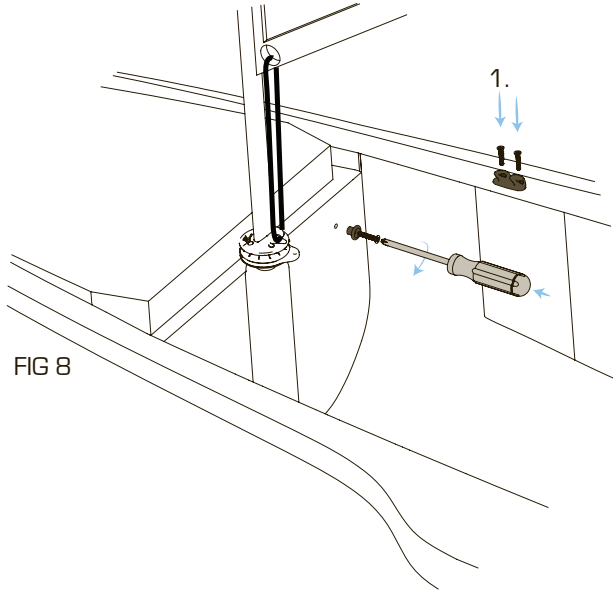

For the Pad Eye you will need to drill two holes on the side of the hull.

1. Measure the drill location by attaching the Furler Line Assembly to the Furler. Run the line through the Fairlead and straight back along the rail of the hull. Locate the hook at the end of the Furler Line Assembly and mount the Pad Eye 5" back of the hook. See FIG 10 & 12.

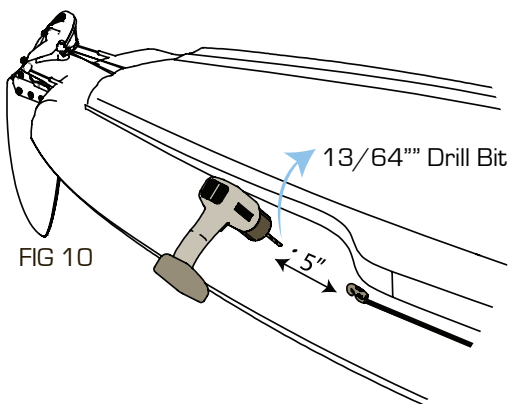

2. Thru-bolt the Pad Eye to the hull. Access the inside of the hull from the seat hatch or rear hatch depending on your kayak model.

3. Once the Pad Eye is mounted stretch the shock cord on the Furler Line Assembly and hook to the Pad Eye. See FIG 11. **This will keep the furler line taut allowing the furler to work as designed.**

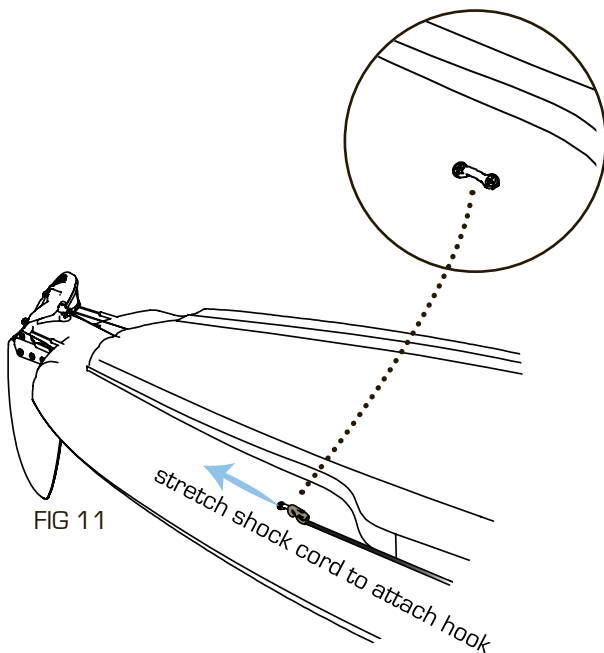

7

Furl

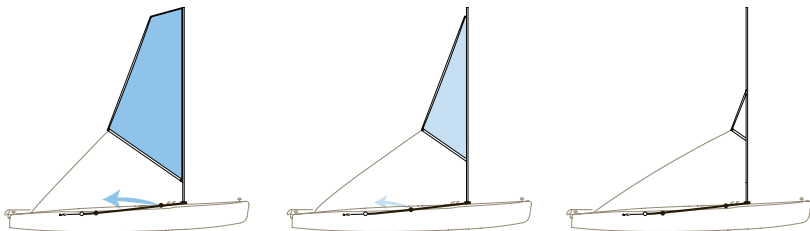

1. Furl your sail by pulling on one of the two lines running down the side of the boat. See FIG 12.

2. Unfurl by pulling the opposite line used to furl the sail. See FIG 12.

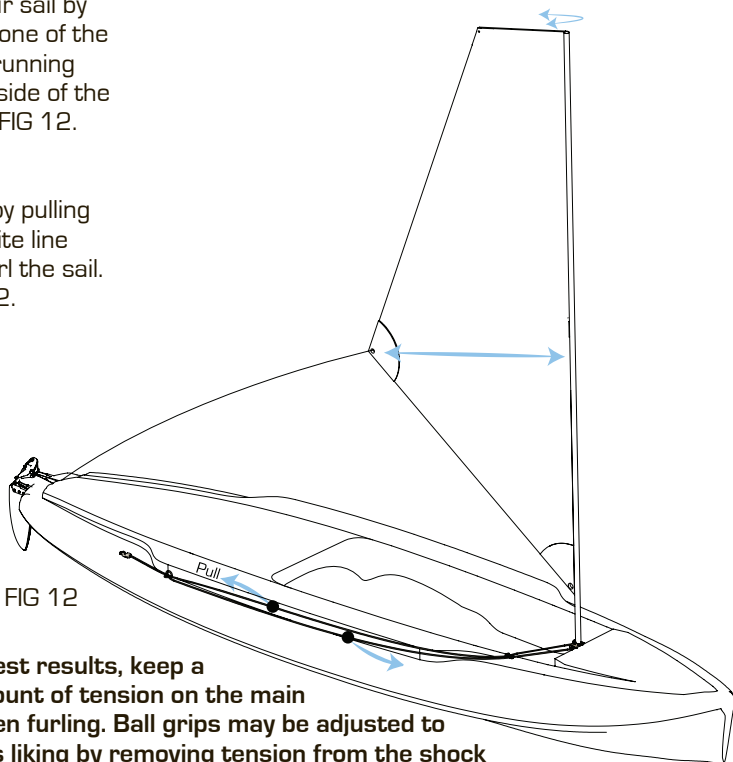
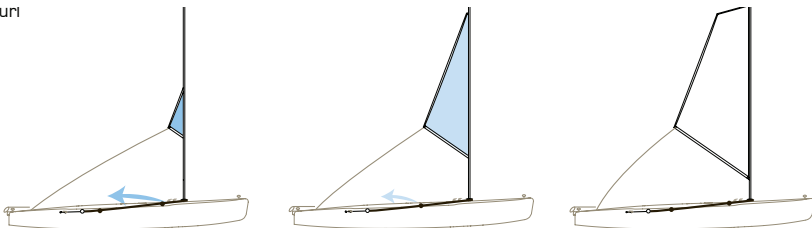

FIG 12

**For the best results, keep a small amount of tension on the main sheet when furling. Ball grips may be adjusted to the user's liking by removing tension from the shock cord and sliding the furling lines to the desired location. Add tension when location is set.**

Unfurl





Hobie Cat Company  
Oceanside, California, USA  
1-800-HOBIE-49  
hobiecat.com

Hobie Cat Australasia  
Huskisson, New South Wales, Australia  
1-800-4-HOBIE  
hobiecat.com.au

Hobie Cat Europe  
Toulon, France  
+33(0)494 08 78 78  
hobie-cat.net

Hobie Kayak Europe  
Stellendam, The Netherlands  
+31(0)187 499 440  
hobie-kayak.com

Hobie Cat Brazil  
Bahia  
Brazil  
+55 (73) 9982 2424  
hobiecat.com.br

PN 84517001  
REV 131023