

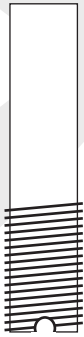

Tandem Mirage Sail Adapter



For serial numbers 1544
and larger.

Congratulations on purchasing the Tandem Mirage Sail Adapter Kit. Follow these simple installation instructions and you'll be out on the water in no time.

Step 1: Flip kayak so that the bottom is facing up.

Step 2: Insert threaded portion of adapter into the scupper hole that corresponds to the front seat. Note: The sail adapter is installed from bottom of the kayak.

Step 3: The adapter is self-tapping, but will require some leverage to screw in. Insert a screwdriver into designated slot to help with turning.

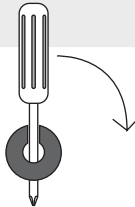
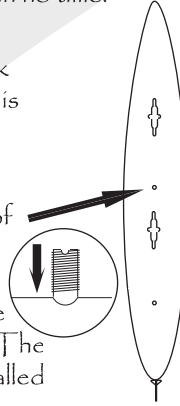

Step 4: Consult Sail Kit instructions for sail assembly.

Step 5: Slide down haul hook up the bottom of the mast approximately 10 inches, then tighten screw to secure the hook. Once tightened, stretch bungee at base of sail onto the down haul hook.

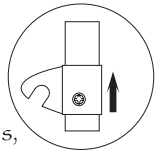

Step 6: Flip kayak over and insert mast into adapter.

Step 7: Run the main sheet from the sail side, through the rear pad-eye, and up through the left clip on your seat. This configuration allows you to steer with your right hand and control the sail with your left.

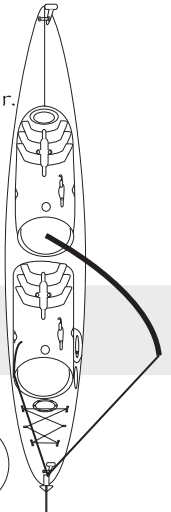

WWW.HOBIECAT.COM