



**KAYAKING / FISHING PARTS & ACCESSORIES  
FALL 2011**





## MEET HOBIE ALTER.

Hobie's story starts on a sun-bleached Southern California beach in the late 1940s. Surfing was the underground thing and a wave-obsessed Hobie dreamt of combining his two loves, woodworking and surfing. He started by designing and building Balsacored surfboards in 1950 in his parents' Laguna Beach garage at the age of just 16, and by 1954 he had opened Hobie Surfboards—SoCal's first surf shop—in nearby Dana Point. Business was good, but Hobie's first serious breakthrough didn't come until 1958, when he and Gordon "Grubby" Clark built the world's first foam-and-fiberglass surfboards. Lighter, faster, and more maneuverable, these revolutionary boards forever changed the sport and put Hobie Surfboards on the map.

Sailing became Hobie's next obsession. Not the stuffy yacht-club variety, but high-speed, high-octane fun that could be enjoyed right off a beach. Employing construction methods honed in his surfboard shop, and studying various traditional multihull designs, the Hobie 14, the world's first fiberglass "catamaran" was unleashed in 1968. This was followed in 1969 by the two-person Hobie 16, which is widely recognized as one of the most important sailboats of all time. Suddenly, high-speed sailing was accessible to everyone, and, thanks to company-organized regattas and now-infamous beach parties; a Hobie lifestyle of fun, family and friends was born. The slogan, "Have a Hobie Day" became a mantra.

Today, Hobie catamarans are as popular as ever but the story doesn't stop there. For the past 40 years we've been advancing design—and fun—in another direction: kayaks.

After carefully considering a kayaker's typical experience, we realized that the paddle was the sport's weak link. The breakthrough came in 1997 with a brilliantly simple yet truly revolutionary idea. Instead of subjecting your arms to a trip to the gym, why not mount fins under the hull and connect them to your kayak via pedals? The MirageDrive®, as this pedal-powered design was dubbed, was a hit and was recognized by Popular Science magazine's "Best of What's New" award in 1998. Suddenly, kayakers could enjoy newfound speed, range and silence. Much like how the Hobie 16 exposed millions of people to the joys of high-speed multihull sailing, the MirageDrive has helped countless kayakers have more fun on the water.



Also in the mid-90s, we began angling for a new market, namely fishing. Compared to powerboats, Hobie fishing kayaks are nearly silent, draw almost no water (allowing users to enjoy skinny-water fishing haunts) and produce zero CO2 emissions or water pollution. Plus, the advent of the MirageDrive freed fishermen to focus on landing their catch, not their paddling. We now make several fishing-specific models, including the Outback, the Revolution® and the new Pro Angler. These boats—like all Hobie kayaks—are designed to meet NMMA certification requirements for flotation.

By the mid 2000s, new kayak models were coming online that fused two of our most successful innovations. The Adventure Island, released in 2006, adds aka crossbars and ama floats and a sailing kit to a MirageDrive-powered kayak, creating a modern version of a traditional Polynesian sailing kayak. In 2010, we introduced our two-man version, the Tandem Island. These boats represent a special co-evolution between our history of designing and building the world's best-loved catamarans, and our desire to create the most innovative and enjoyable kayaks afloat.

The company's newest big idea involved combining the simplicity of an inflatable with the fun of a sailing rig and the ease of a MirageDrive. These inflatable kayaks, introduced in 2007, make kayaking easier, more accessible and infinitely more transportable. In fact, the same fun-minded DNA that made Hobie's first foam-and-fiberglass surfboards so successful is the exact genetic material that makes our kayaks the best ride on the water. Now, even more people can enjoy the Hobie lifestyle.

What's next? With the Hobie Cat Company this could be anything. But given our sixty-plus year history and our dedication to inventing, innovating and improving people's on-the-water experience, you can bet next summer's vacation that it will be big.

**LIFE** "The Cat That Flies"  
February 6, 1970





ITEM	PAGE
T SHIRTS / HATS / LOGO GOODS	2-3
WATER WEAR	4-5
LIFE VESTS / PFD	6-7
SAFETY	7
Hobie eVolve Electric Motor Kit	8-9
SIDEKICK AMA	10
ST TURBO FINS	10
SUN BIMINI / DODGER	12
SAILING KITS	14-15
ISLAND TRAMPOLINES	15
DRIFT CHUTE	16
ANCHOR TROLLEY	16
ROD LEASH	16
STAKEOUT POLE	16
ACCESSORY PACKS	16 & 23
ROD HOLDER EXTENSIONS	17
LIVWELL	18
HATCHES / GEAR BUCKETS	19
DRY BAGS	19
FISHING ROD HOLDERS	20-23
ELECTRONICS	24-25
COMPASS	24
DOLLY CARTS	26
TRAILER	27
STORAGE BOX	27
RACK PADS / STRAPS	27
MIRAGEDRIVE BAG	28
COVERS / BAGS	28-29
MISC ACCESSORIES	30-31
REPAIRS / MAINTENANCE	28-31
TOOLS	31
HARDWARE	31-33
KAYAK SUPPORT	35
KAYAK FAQ	35
WARRANTY INFO	35
LIVWELL PARTS	35
PARTS DIAGRAMS	35-44
NUMERICAL PARTS LIST	45-48

**Note: Freight to dealers is not included in pricing.**

No portion of this catalog may be reproduced without the express permission of the Hobie Cat Company. Printed in USA.  
Prices and specifications subject to change without notice.  
All rights reserved. ©2011 Hobie Cat Company. Oceanside, CA 92056



5023TS  
Boa



5023TO  
Oar Washed



5023PP  
Pumpkin



5023VS  
Visor



5018TG  
Tan Green



5019BK  
6 Panel Low Pro



5018GM  
Gray Mesh



5018BK  
Black



5018RM  
Red Mesh



5018BL  
Blue

**HOBIE HATS**

5018BK / 5018GM / 5018TG / 5018 RM / 5018BL / 5019BK / 5023PP / 5023TO / 5023TS / 5023VS



**HOBIE AUSSIE HAT**  
5024LG (23.6" - 60cm)  
5024MD (22.8" - 58cm)

**HOBIE MICROFIBER HAT WITH NECK FLAP**

5025MF



**HOBIE BEANIE**  
5026BW (Women's White)  
5026BM (Men's Black)



**LID LATCH**  
Don't let that fancy new hat blow away. Secure it to your shirt or life vest with a Lid Latch.  
1553L



5130xx Hobie Mirage Kayaking (Gray)



5129XX Hobie Mirage Kayaking (Black)



5131xx Hobie Mirage Fishing (Tan)



**HOBIE "T" SHIRTS** All shirts are 100% cotton with screened graphic designs on the back and chest.  
(xx = size) md, lg, xl [xxl available in fishing version]

**HOBIE SUNGLASSES**

Hobie® Polarized Sunglasses are designed to improve your vision by eliminating glare, a problem that has been around since the first sunrise. Once you wear Hobie sunglasses you will never want to be without them! By cutting all glare, our sunglasses make it easier to see the wind on the water, the fish in the water and any obstacles in your way. When you put on Hobies it's like a vacation for your eyes! See the complete line of Hobie Sunglasses at [hobiepolarized.com](http://hobiepolarized.com)



Playa - 1562BLK



Escondido- 1565BLK



Boomer - 1564BLK



**HOBIE CROAKIES**

Keep your glasses in place! Made from wetsuit fabric that will not stretch or lose shape when wet. Remains secure whether worn normally, raised, or lowered.  
1553CR Each



**BOOK - FROM PENGUIN WINGS TO BOAT FLIPPERS**

Great book about taking ideas from nature to use in products. All about the Hobie Mirage pedal system. Written by Toney Allman from the series "Imitating Nature".  
615 Each



**HOBIE KEY FLOATS**

Don't lose those keys! Keep a few bucks dry, inside the small compartment, while on the water.  
72010 Each



**HOBIE FISH THE WORLD DVD**

Join us as we fish Australia, France, Holland, the Oxbows of the Mississippi, the Lower Owens in the Eastern Sierras, the Louisiana bayous, Noth Carolina, Corsica, and down the west coast of Baja Mexico.  
84431001 Each



**SPORTS BOTTLE**

Show your Hobie spirit with the "just right" size sports bottle.  
71999011 16oz  
71997001 20oz  
71998001 32oz  
(Check parts pages for correct bottle fit)

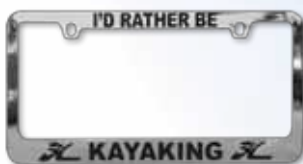

**LICENSE FRAME "KAYAKING"**

3044 Chrome



**LICENSE FRAME "HOBIE"**

3043 Chrome

**STAINLESS WATER BOTTLE**

71995001 20oz



12451031 / 12451021



12451050 / 12451051



36601000 / 36601011 / 13001001



12453021



12453011



12453031



79545001

**STICKERS**

- 12451031 "Hobie Diamond" Turq 36"
- 12451021 "Hobie Diamond" Red 36"
- 12451050 "Script" Black 24"
- 12451051 "Script" White 24"
- 12453011 Hobie Kayaks 5 1/2"
- 12453021 Hobie Kayak Fishing 5 1/2"
- 12453031 Hobie "Teq Sunrise" Dome 4 1/2"
- 13001001 Hobie "Flying H" Black 12 5/8"
- 36601000 Hobie "Flying H" Black 6"
- 36601011 Hobie "Flying H" White 6"
- 79545001 Hobie "H" Dome 2 1/4"

# HOBIE WATER WEAR

Be more comfortable and extend your kayaking / sailing season by dressing appropriately for the conditions. Hobie water wear is designed for both kayaking and sailing needs.



## HOBIE SPRAY TOP

Designed for active kayaking and sailing. Can be worn with swim trunks or over a wetsuit. Mix and match layers to get the comfort you desire. Spray and wind protection. Beautiful styling and extra durable construction. Construction Features: Neck and wrist seals, Neoprene waist seal, Breathable 5000cm<sup>3</sup> nylon shell, Offset chest pocket, Arm patch pocket.

### HOBIE SPRAY TOP

3850SM / 3850MD / 3850LG / 3850XL

## HOBIE SPORT TEE

Designed for active kayaking and sailing. Quickdry performance fabric with UV protection. Mix and match layers to get the comfort you desire. Quickdry 100% polyester mesh (Polyester yarn with wicking dry and anti-bacteria function) UPF50+ Men's available in long or short sleeve. Women's version has a V-Neck.



### HOBIE SPORT TEE MEN'S LONG SLEEVE

3857SM / 3857MD / 3857LG / 3857XL

### HOBIE SPORT TEE MEN'S SHORT SLEEVE

3858SM / 3858MD / 3858LG / 3858XL

### HOBIE SPORT TEE WOMEN'S SHORT SLEEVE V-NECK

3859SM / 3859MD / 3859LG

**THE VISICARBON PRO™** combines a high visibility light and safety flag with a light weight, low drag, and portable style. Insert foam base into molded-in or Live Well rod holders.

**A quick look at the features:**

- The ultra thin mast and redesigned flag combine to offer excellent performance with low wind drag.
- Main mast section designed with carbon fiber tubing for high strength and ultra light weight.
- The VISICarbon Pro™ weighs in at just 14 ounces, complete with 3 AA batteries.
- The 48" long VISICarbon Pro™ breaks down to 14" long in seconds.
- The Silent Snap™ flag attachment system provides a secure attachment that allows the flag to be removed in seconds.
- The folded unit can be stored inside the nylon flag which doubles as carry bag.

**72020040 SAFETY FLAG/LIGHT COMBO**



**SAFETY FLAG** Be Seen! When out on your kayak, you are very low to the water. Add to that any wave or swell action and you are often hidden from other boaters view. The 4' tall safety flag will help other boaters see you. Very important in areas with mixed boating traffic! For mounting in areas with internal access, you can use large washers and the provided nuts. Otherwise, in areas with no internal access, use the mount which includes bolts and well nuts.

**72020002 SAFETY FLAG 4'**  
**72020012 DELUXE MOUNT**

**MOUNT**

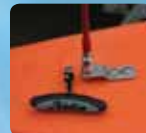

**TELESCOPING**

**PADDLE** is a good spare paddle that can be stored within most Hobie kayak models. 6 1/2" wide blade will fit into an 8" hatch opening. Measures just 20" in closed position (45" when fully extended). Lightweight, easily portable yet with durable construction of high grade plastic paddle and anodized aluminum shaft. Corrosion resistant design. Floats too!

**3091 TELESCOPING PADDLE**



**HOBIE SAFETY KIT** has many useful items for added safety when boating. Includes first aid and some basic survival materials. Hobie Gear Bucket with Orange safety lid. Ready access is assured by hanging the safety kit on the inside lip of an 8" Hobie Twist and Seal hatch. Includes a 33 piece first aid kit, water proof flash light, signal mirror, space blanket, whistle, utility tool, waterproof matches, duct tape, gauze bandage, gauze pads, cloth tape (specific items subject to change).

**72020010 HOBIE SAFETY KIT**

**BILGE - HAND PUMP** Water over the bow while you have a hatch open can leave you with a flooded hull. This light weight pump is security for long trips on the water. Features super-comfortable, easy-grip rubber overmolded handle and a high-visibility neon yellow stock for extra safety.

**72020032 BILGE - HAND PUMP**



**HYDROSTAR - S.O.S DELUXE "HOBIE"**

Whether you're paddling, sailing, camping, fishing, hunting or just changing your tire the Hydrostar offers an unmatched combination of features that makes it a must-have for all your water sports, outdoor and travel needs. Everything you need for lighting in one compact waterproof package.

- |                             |                             |
|-----------------------------|-----------------------------|
| <b>Hydro Star Features:</b> | Suction cup base            |
| 2-way LED FLASHLIGHT        | Strong magnetic base        |
| Emergency XEON STROBE       | Twist action control switch |
| Programmed S-O-S SIGNAL     | Safety leash                |
| Waterproof up to 50 feet    | Batteries included          |

**72020003 HYDRO STAR SOS LIGHT**



**HOBIE GLOVES**

Protect your hands while increasing your grip strength. Gloves add grip strength on lines which can ease up on the amount of force you need to exert. Available in

small, medium, large & extra-large. (xx = size)

**3188xx** Hobie Glove

**RONSTAN GLOVES**

'Amara' synthetic leather for maximum durability, minimum stretch and shrinkage. Double Aramid stitching in high wear areas. Double thickness palm and fingers for protection and grip. UPF 50 (Ultra-Violet Protection Factor). Mesh panels for flexibility, comfort and quick drying. Low cut neoprene wrist band for secure fit and clear access to start watch. Sticky gloves reduce fatigue by minimizing the physical effort required to hold rope. (xx = size XS/SM/MD/LG/XL)

**THUNDERWEAR COLD WEATHER GLOVES**

Full fingered glove for watersports. Made of Neoprene and Thunderhide, an amazing synthetic leather that is completely wetttable and

washable. Keeps your hands warm. These gloves run large and are men's sizes. (xx = size - XXS/XS/SM/MD/LG/XL)

**3187xx** Gloves



**RONSTAN SHORT FINGER GLOVES**

**RF4850xx** Short Finger Glove



**RONSTAN THREE FINGER GLOVES**

**RF4851xx** Three Finger Glove



**HOBIE HI-BACK MESH** by Stohlquist

This front entry vest was designed just for Hobie Kayaks! The flotation in the back is up high and away from the seatback (less bulk down low). Short length does not “ride up” around your neck when you are sitting. There is a mesh panel across the back. Front zip entry for easy on and off. A zipper keeper to prevent the zipper from slipping down when in use. Large mesh pockets on the front for easy storage and access of small items. Stretchy neoprene adjustable padded shoulders. Ventilated mesh side panels. High waistline cut. Huge arm cutouts and a short waist allow excellent freedom of movement. Adjustable side straps offer enough size variation for many layers underneath or none!

SMD / LXL / XXL (Mango Yellow or Forest Green)

**S6143xxx Mango** (xxx = size)

**S6144xxx GREEN** (xxx = size)

(UL - Approved) for use in USA Only

**S6145xxx ULC - Mango** (xxx = SMD / LXL)

(ULC - Approved) for use in Canada Only

S6143-4-5 Sizes (Chest): SMD 30" - 42"  
LXL 42" - 52" / UNIVERSAL 30" - 54"



**BACK FLOTATION ABOVE SEAT BACK**



**WOMENS HOBIE HI-BACK** by Stohlquist

Many of the same features as the Hi-Back Mesh, but shaped and contoured specifically to fit Women. Foam layering inside the vest is countoured for a better fit. XSS - MLG - PS

**S6146xx POWDER BLUE** (xx = size)

**S6147xx MANGO** (xx = size)

S6146 Sizes (Chest): XS/S 30" - 36"  
M/L 36" - 42" / Plus Size 40" - 46"

**HOBIE SHORT-PROFILE VEST** by Stohlquist

This side entry design has set the standard for streamlined pfd fit. Cool mesh side panels and reflective accents. Stretchy neoprene adjustable padded shoulders. Roomy mesh pocket with “D” ring for keys. Ventilated mesh side panels. High waistline cut. Huge arm cutouts and a short waist allow excellent freedom of movement. Extra short length does not “ride up” around your neck when you are sitting. Adjustable side straps offer enough size variation for many layers underneath or none!

SM / MD / LG / XL / XXL

(UL - Approved) for use in USA Only

**S6142xx** (xx = size)



S6142 Sizes (Chest): Small 32" - 36" / Medium 36" - 40"  
Large 40" - 44" / XLarge 44" - 48" / XXLarge 48" - 52"



**STEARNS' CHILD/YOUTH VESTS**

Our children's life vests meet the same functional requirements as those for adults. We've selected the, easier to put on, three clip model. These are easy to adjust for different size crews.

(Vest colors vary)

**SBV3120YEL** 30 to 50 lbs

**SBV3122YEL** 50 to 90 lbs



**HOBIE HI-BACK FISHERMAN** by Stohlquist

Ready and loaded, this new fishing and hunting vest is the ideal PFD for the sit-on-top kayaker, providing comfort and water safety with all the necessities, close at hand. Put to work, while you play, the FISHERMAN provides excellent cockpit management with places for the little things like pliers and extra tackle. The EVA front pockets fold down to provide a work station and are sized to fit small tackle boxes. The FISHERMAN'S outer platform provides mounting locations for tippets, retractors, nippers, leader-line, hemastats, and pliers. Choose between low-vis Cactus color or hi-vis Mango with 3M reflective strip. Safety, comfort, storage and utility make this the ultimate vest for fishing or hunting.



The Drawbridge...dual front-mounted tool pouch pockets have protective EVA stiffened outer shells to protect pocket contents when re-boarding the kayak from "over the rim".

- EVA inner platform - is a fold-down work surface.
- Velour (hook & loop style) -inner lining attachment surface.
- Sized to fit small plastic lure boxes.
- Inside accessory pockets and stowage for tools.

Outer Platform....like an angling vest, the FISHERMAN vest has mounting locations for tippets, retractor(s), nippers, leader-line, hemastats, and pliers.

**FEATURES:**

- Choose low-vis Cactus color or hi-vis Mango with 3M reflective.
- Open sides for ventilation.
- Neoprene padded shoulders and lower back waistband.
- 1-1/2" webbing belt with dual side adjustments.
- Multiple pockets, all with drainage.
- High-back flotation rides above back rest.
- Adjustable 1-1/2" webbing shoulder and side adjustments.
- Cinch harness adjustment for zero ride-up.
- New PVC-free Gaia foam.

SMD / LXL / XXL (Cactus / Mango)  
**S6149xxx Hi Back Fisherman Cactus** (xxx = size)  
**S6148xxx Hi Back Fisherman Mango** (xxx = size)

(UL - Approved) for use in USA Only

**SAFETY TIP!**

**LIFE VESTS** Get a good, comfortable life vest and WEAR IT! A life vest does you little good stored on your boat, especially if you get tossed into the water and away from your boat. Accidents happen and by their nature, they happen when you are not prepared. A life vest can keep you afloat until you can rescue yourself or you can be rescued by others. In the worst cases when injuries or cold water are involved, your life vest can make all the difference! Be sure everyone onboard your boat wears a life vest too! Pass the word! Federal law now requires that all persons below the age of 13 must wear a life jacket while aboard a boat.



- **Buoyancy:** 26 Pounds
- **Inflator Type:** Halkey Roberts 3F
- **Primary Inflation:** MANUAL
- **Auxiliary Inflation:** Oral
- **Size and U.S.C.G. Wearer Requirements**
- **Adult Universal:** For persons 16 years or older, weighing more than 80 lbs., with chest size of 30 - 52 inches
- **U.S.C.G. Approval Type:** U.S.C.G. Type III
- **Durable Ripstop Nylon Front Shell**
- **Waist Belt Width:** 1"
- **Zippered External Pocket**

**NOTE:**  
**AIR SHIPPING RESTRICTIONS**  
 CO2 / DANGEROUS GOODS



**INFLATABLE BELT PACK PFD**

Extremely lightweight and comfortable belt carried PFD design is cooler and more comfortable than typical PFDs. Functional design for multiple types of water sports from fishing, kayaking, sailing to stand up paddling (SUP). Belt pack style stays out of the way till you inflate and put the bladder on over your neck. Adjustable waist. Buoyancy: 26 Pounds. USCG Approved Type III PFD, approved for use by persons 80 lbs and 16 years of age or older. Size: Universal Adult Size. Durable ripstop nylon pack. 2" wide, adjustable, nylon waist belt. Includes (1) CO2 Cylinder and instructions.

**S6780RG RED/GRAY**

**HOBIE INFLATABLE PFD**

Light weight and comfortable. Ready when you need it, manual CO2 inflation or buy mouth inflator allows for swimming, wading and intentional immersion.

Available in Red/Grey or Tan/Grey.  
**S6779RG RED / GREY**  
**S6779TG TAN / GREY**

**S6779R PFD INFLATABLE REARM KIT**



# HOBIE eVOLVE v2 POWERED BY TORQEEDO

Whether you're augmenting your MirageDrive or using the Hobie eVolve as your primary power source, this quiet and efficient electric motor will dramatically expand your horizons. Maybe there's a ripping tidal current or a series of fast-flowing eddies that you must negotiate before reaching that pristine shoreline. Maybe it's a bay that's always been a little too far to explore. Or maybe it's just been a long day and your tired muscles could use a break. Either way, the clean, quiet, eVolve system is there for you.

This tidy German-engineered electric motor kit fits any MirageDrive kayak and it comes with two mounting options—one midship, the other stern hung. With the Hobie eVolve, you can either maintain steady cruising speeds of two knots (motor only) for hours, or you can open the throttle for short sprints. Best yet, depending on your set-up, you can use the eVolve to augment your boat speed while also using your MirageDrive. And thanks to its cockpit-mounted Remote Throttle, you always know how much juice you have left in the system's 320 Wh Lithium-Manganese battery. Runtime estimated as 8 hr 20 min at 2.6 mph / 48 min full throttle.

If you thought the MirageDrive made kayaking sweeter, wait until you try the eVolve v2 system. The eVolve v2 offers increased battery capacity, longer range and solar charge / run capability (solar panel accessory not yet available). Life only improves with power.

- 72022030 EVOLVE v2 TORQEEDO MOTOR KIT - Kayak
- 72022040 EVOLVE v2 TORQEEDO MOTOR KIT - i Series

**EVOLVE V2 KIT INCLUDES:**

- Ready-to-go Mirage well-mounted Hobie eVolve v2
- All cables for the motor and throttle units
- All mounting hardware
- Assembly that integrates the motor with a Twist and Stow rudder
- Sealed/Waterproof Lithium-Manganese high-performance battery 320 Wh (charger included)
- Remote throttle system displays speed and distance information generated by an onboard GPS unit
- Magnetic safety key
- Waterproof fittings and cable connectors
- Solar charging port (Solar panel accessory not yet available)
- Corrosion-resistant materials ensure durability and performance
- Lightweight power: Total weight of installed kit is 18 lbs (8.16 kg) or less, depending on the configuration



## 2 for 1

**BOTH MOUNTS INCLUDED**

For all Mirage Series except no Rudder Mount for Inflatables, Island Series, and Pro Angler

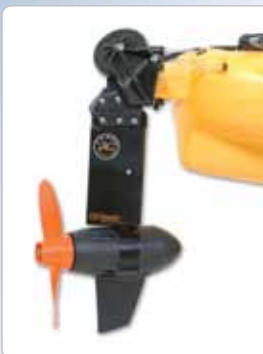

**RUDDER POSITION MOUNT**

The rudder-mounted eVolve is the ultimate tool for extending your range and exploration options. This slick system uses a lightweight aluminum assembly to easily integrate an eVolve motor with a Twist and Stow rudder. Pedal and motor; motor, or simply pedal. When off, the engine becomes your rudder or it can be brought on deck via the Twist and Stow controls. (Rudder Mount not included in kit for Pro Angler and Inflatables.)



**MIRAGE WELL MOUNT**

A clever option for mounting the eVolve motor package is to swap out your MirageDrive for this electric unit. Just slot the well-mounted Hobie eVolve into any MirageDrive kayak and instantly enjoy powered propulsion. Ready to use fresh out of the box, the Mirage-mounted eVolve weighs a scant 6.4 pounds—that's 0.2 pounds less than the MirageDrive—and is built to take years of exploration and adventure.



**REMOTE THROTTLE**

While the outboard might be transom-hung, the driver doesn't have to sit astern thanks to our Remote Throttle, which attaches via a RAM mounting unit (included) to provide throttle control from your favorite seating position. The LCD screen displays all the trip info you need (such as speed and range) while you're underway. For safety, the unit features a magnetic key-to-throttle connection; break this magnetic connection and the motor immediately stops.



**LITHIUM BATTERY V2**

A lightweight, 6.6-pound, 320 Wh Lithium-Manganese battery (11Ah at 29.6V) powers the system's featherweight Torqeedo motor. The battery is buoyant and completely waterproof, ensuring safety and there-when-you-need-it performance. Its built-in GPS unit generates pertinent information such as speed and range. Solar charge / run port.

# ST PERFORMANCE FINS ST or ST TURBO!

ST FINS ...and you thought the Hobie MirageDrive was the most amazing propulsion system ever seen! Now you can make your Hobie MirageDrive a **SUPER PERFORMER!**

Hobie Mirage kayak users report as much as 10% increase in speed and more using ST TURBO Fins. But its not all about speed, you can get top end speed and a slower cadence for cruising (Less pedals per mile). All achieved with these larger and more efficient fin designs. Increase your performance or increase your fitness routine, you choose the fin that is right for you: Standard, ST or ST Turbo... low, medium or a higher gear! The standard fins, supplied with our kayaks, are the easiest pedaling fins, but many users feel that the standard fins do not offer enough resistance. This is very evident when using our sailing kits. The added power and speed of the sail often outpaces the standard fins (similar to pedaling a bike down hill in first gear). Want to go really fast? Add the ST TURBOs for sailing! The longer fins can also increase lateral resistance for sailing upwind.

These ST (Square Tip) designs will require a bit more effort to pedal. The added effort is commonly compared to pedaling a bike up a slight incline. In addition, the included fin tension screw allows adjustment to achieve lower end torque or top end speed to meet the desires of the pedaler.

ST Fins fit any Hobie MirageDrive. If you prefer the ST fin, order 2 per drive. The ST TURBO fins require longer masts. The ST TURBO fin kit comes with 2 fins, 2 masts and all needed fittings.

- 72066001** ST TURBO Fin Kit V2 (2009 and Newer Threaded Sprocket)
- 72065** ST TURBO Fin Kit (Older SS or Set-screw Sprocket)

**80013001** MirageDrive with ST Turbo fins

- 81193001** ST Fin / Single (Requires 2 per MirageDrive)
- 81192001** ST TURBO Fin / Single (replacement)



ST FIN

ST TURBO  
FIN KIT

72065 ST TURBO V1 KIT SHOWN



## SIDEKICK AMA KIT

Whether you are a pro or a novice, you will enjoy the sense of security from the extra amount of stability offered by the SideKick ama kit. Great for use when sailing, fishing, standing when site fishing, shooting photos! The SideKick ama kit is simple, light weight and effective! The SideKick's cross arms adjust the float height with a simple "click-twist-click". Just like a paddle shaft adjustment. Three positions offer you high - medium - low positions. Set the floats high for cruising (less drag) or secondary stability. Use the medium or low settings for primary stability (less initial roll). Fine adjustments for float height are done by twisting the main crossbar within its mounts and tensioning with the fastening hardware. Set up and use right off the beach or disassemble and deflate to store inside the hull. Then assemble and inflate when you get to your dive or fishing spot. Inflation is simple. Just blow a few breaths into each float through their one-way valves. Valve cap unscrews for rapid deflation. Installs with 4 bolts using expanding nuts.

- 72062101** SIDEKICK AMA KIT - Light Gray
- 72063101** SIDEKICK AMA KIT - Dark Green
- 72062061** SIDEKICK +07 ADVENTURE MOUNTING ADAP PLATE SET
- 72062062** SIDEKICK - MOUNT KIT W/CENTER BAR



**SIDEKICK AMA KIT** Extra stability for your kayak. Fits most Hobie models and most other kayaks. Whether you sail, fish, shoot pictures, dive or just want to feel a bit more stable when using your kayak, the SIDEKICK AMA KIT will do it. Light weight and simple to install. The floats are inflatable.

OFFICIAL SUNGLASS SPONSOR



US SAILING



ABA



USLA



# POLARIZED

WORLD'S BEST POLARIZED SUNGLASS



HOBIE ESCONDIDO  
SHINY BLACK / GREY LENS

The Motion Series was designed for demanding sports enthusiasts who are unwilling to compromise on either function or style, featuring HydroClean™ lens technology. Our advanced hydrophobic coatings are applied under the most controlled conditions resulting in a lens that sheds water, resists dust and grime and is easy to clean.

[WWW.HOBIEPOLARIZED.COM](http://WWW.HOBIEPOLARIZED.COM)



CHARCOAL

BLUE

GREEN



**72710** Mount fits all Hobie models and most other kayaks (3 piece expandable). Attaches with included (4) bolts and expanding nuts.

# HOBIE BIMINI SUN SHADE

We all love the sun, but it can be a bit much at times. Protect yourself with a Hobie Bimini Sun Shade. The Bimini is easily attached to most Hobie Kayaks. With the Hobie mount installed, a simple flick of a finger can attach, adjust or remove the Bimini. It can be easily folded out of the way or set up to block the sun. Simple adjustments can tilt the shade from side to side or to different heights and angles for best protection from the sun's rays. Requires Hobie mount. The Hobie Mount will attach to just about any kayak. It extends or retracts for a perfect fit.



- HOBIE BIMINI SUN SHADE** (\*Requires mount)  
**72700** Bimini Charcoal\*  
**72701** Bimini Blue\*  
**72702** Bimini Green\*  
**72710** Hobie Mount

# HOBIE DODGER

The Hobie Dodger is a spray, cool breeze or sun shade for your lower body. Deflect bow spray, block cool breezes and stay warmer in cold conditions.

Works like a small pop-up tent. Loops of bungee connect to the boat via small fittings installed along the rails. Small internal battens give the Dodger its shape. The Dodger extends aft to just in front of the pedaler. A Velcro strip seals up the center in front of the pedaler. The entire dodger folds forward to enter or exit the kayak, to make pedal adjustments or reach items in the cockpit. An access panel is built-in for using the sailing rig. A great combination when there is wind and spray!

Great for hunters, animal and bird watchers as the Dodger conceals your legs movement. The Hobie Dodger makes your kayak a sit-inside sit-on-top!

Installs in minutes initially, but installs in moments once the fasteners are in place. Packs away into a small stow bag 5" round by 24" long (1.8 lbs).

Mirage Dodger Fits the Hobie Mirage Outback, Sport, Adventure and Revolution kayaks (May fit other models with some modification to hardware placement).

## HOBIE MIRAGE DODGER

- 72720 Dodger Camo
- 72721 Dodger Silver
- 72722 Dodger Yellow

## HOBIE ISLAND DODGER

- 72730001 Island Dodger Yellow
- 72730002 Island Dodger Silver

Tandem Island: Island Dodger forward / Mirage Dodger aft

## HOBIE PRO ANGLER DODGER

- 72730003 Pro Angler Dodger Camo



SILVER



YELLOW



SAIL RIG MAST ACCESS



PRO ANGLER CAMO

# Serious Fun



**Hobie is thrilled to introduce an exciting new member of our fleet.**

The **Hobie Mirage Tandem Island** is the big brother of our Hobie Mirage Adventure Island and twice the fun. Plenty of room for the skipper and crew, with total control of the roller furling sail and the large Twist and Stow rudder from either high back padded seat. Inspired by Polynesian multihulls, this 18' 6" trimaran "sail-yak" includes state-of-the-art features and comfort, plus two patented MirageDrives with Turbo Fins. So choose a partner and enjoy the ride.



POWERED BY



**HOBIE**  
MirageDrive®



[hobiecat.com](http://hobiecat.com)

# SAIL KITS

ADD SAILING TO YOUR HOBIE MIRAGE KAYAK EXPERIENCE!

## MIRAGE KAYAK SAIL RIG

Add sail power to Hobie Mirage Kayaks! (Fits all current models of Hobie Mirage Kayaks). The Patented MirageDrive pedal system allows you to pedal while sailing which helps you to maintain forward motion through turns and obtain higher speeds. Sail with ease maintaining excellent speed with or without pedaling while sailing. Easily pedal out to sail or pedal home when the wind is too light. Add a SideKick ama kit for additional stability if desired.

## HOBIE MIRAGE KAYAKS... THE ONLY KAYAKS THAT CAN DO IT ALL

Paddle kayaks do not have the necessary lateral resistance needed nor do they typically have a rudder for steering. Paddle kayaks require hands-on paddling which prohibits use of rudder and sail controls for sailing. The MirageDrive pedal system allows you to pedal out onto the water to sail and pedal back if needed. You can also pedal the boat through a tack (turn). The MirageDrive pedal system's fins act as a keel or centerboard when in the down position offering the lateral resistance needed for upwind sailing. Hobie Mirage kayaks are equipped with a hand-controlled rudder. The MirageDrive allows hands to be free for sail and rudder controls.

**SAIL KIT** includes two piece mast, sail (20.25 sq ft.), lines, fittings and storage bag.

Add the large rudder #81397001 for more responsive rudder control. Adventure models can add the dagger board for enhanced upwind performance.



i-Series 79052203  
84515001

i-Series 79052204  
84516001

84514001

i-Series 79052202  
84513001

- 84513001 Sail Kit (Turq/Papaya)
- 84514001 Sail Kit (White/Red)
- 84515001 Sail Kit (White/Turq)
- 84516001 Sail Kit (Silver/White)

- 79052202 i-Series Sail Kit (Turq/Papaya)
- 79052203 i-Series Sail Kit (White/Turq)
- 79052204 i-Series Sail Kit (Silver/White)

- 81397001 "Sailing" Rudder Blade (Lg TnS)
- 81397101 "Sailing" Rudder Blade i-Series
- 79502001 Adventure Sailing Daggerboard
- 84503 Replacement 2-piece mast
- 79052251 Replace 4-piece (i-Series) mast
- 84511 Replacement Sail Batten
- 84509001 Replacement Batten Cap
- RH112WHT Batten Tie Line (per foot)

### Adventure Daggerboard



Large Twist and Stow "Sailing" Rudders

81397001

81397101



Sailing with Dodger



Sailing with SideKick Ama Kit



For top sailing performance, add the ST TURBO fin kit and larger rudder!





### ADVENTURE ISLAND CONVERSIONS

The Hobie Mirage Adventure (2007 model and newer only) can be converted into an Adventure Island! These kits allow you to add just the amas or go all the way to Adventure Island with the amas and sail combined. Great sailing performance and excellent stability.

The complete kit includes: A boomless, roller-furling sail rig with plenty of sail area for excellent performance, completely manageable from the cockpit with the pull of a line. Two retractable amas that fold up against the side of the boat for easy docking, maneuverability, and transport. All 2007 and newer model year Adventure Kayaks, including the Fish model, have inserts molded into the hull. The Adventure Island kit is loaded with additional standard features such as a daggerboard; large "Twist and Stow" rudder; Mast and Sail Cover; and an Aka/Daggerboard Bag.

*Conversions kits are available in V1 crossbar / aka configuration only.*

**99503001** ISLAND CONVERSION KIT - PAPAYA

**99504001** ISLAND CONVERSION KIT-HIBISCUS

**99505001** ISLAND CONVERSION KIT - DUNE

**99600001** INSTALL TOOLS - MAST HOLE SAW

**(See part guide pages for replacement sails and parts)**

**Prices DO NOT include freight to dealer or assembly.**

### SAILING TIP!

**SAIL POWER** Watch the sail in order to pay close attention to the trim or adjustment of the sail. When the front of the sail, just behind the mast, luffs or flutters in the breeze, you lose power. To start moving, pull the sail in just enough to stop the sail from luffing or turn the boat away from the direction the wind is coming from. There are also short ribbons hanging on either side of the sail called "tell tails". The tell tails react to air flowing over the sail and will help you see that the sail is pulled in too tight or too loosely. If you pull the sail too tight you will stall the sail power. The tell tail on the back side of the sail will drop or do circles. Ease the sail out until it luffs, then pull it in just a little until it stops luffing. You will adjust the trim whenever the wind changes direction or you change course. See more on "Learn to sail the Hobie way" on our website in our "Support" area at:

<http://www.hobie kayaks.com/experience/learn.html>



### AKA TRAMPOLINES FOR THE HOBIE MIRAGE ADVENTURE ISLAND AND TANDEM ISLAND

Aka Trampolines do many things... Added space for carrying gear, allows you to move weight outboard for better performance in windy conditions, comfortable sitting or laying down position, carry additional crew / kids / pets (does not increase basic weight capacity), reduce spray in cockpit. The trampolines are made from mesh vinyl as used on our catamaran product. Available in Grey or Black. Easy installation. Fast (side-release) buckles across aft aka make folding akas quick. Adjustable webbing straps for a tight fit. Rolls down and straps to forward aka for storage or easily slips off the aka. Paddle storage, gear pockets and lanyard grommets included. (200 Lb Capacity)

**79527001** TRAMP SET AI – BLACK

**79527011** TRAMP SET AI – GREY

**88527001** TRAMP SET TI – BLACK

**88527011** TRAMP SET TI – GREY

### REPLACEMENT PARTS

**79527101** LACING ROD

**79527201** WEB/BUCKLE ASSY

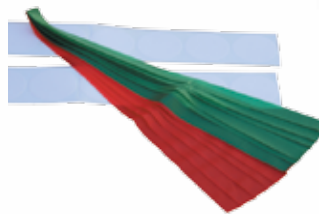

### AIR-FLOW TELS

Trim your sails for optimum performance. Attached air flow over sails is critical. Air flow directions are indicated by these tell tails. Made of light weight rip stop nylon (Red / Green). Attaches to sails with waterproof adhesive disks.

**334** Set of 14

## HOBIE FISHING ACCESSORY PACKAGES



### 72020021 Ultimate Kayak Fishing Package

- 1 72020020 Fish Finder Package
- 1 71706001 Hobie Gear Bucket 3 Pack
- 1 72023000 Rod Holder - RAM Tube
- 1 72020008 Anchor Trolley Kit
- 2 72020014 Hobie Rod Holder Extensions
- 2 74052001 Hobie Rod Leashes



### 72020020 FishFinder Package

- 1 72020005 FishFinder - Lowrance X-4 PRO
- 1 72023007 FishFinder Mount - RAM Mount
- 1 72020011 FishFinder Installation Kit



### 72020033 ULTIMATE KAYAK NAVIGATION PACKAGE - COLOR GPS

- 1 72020018 Lowrance Endura Out&Back
- 1 72023018 GPS Mount - RAM Mount
- 1 72020004 Richie Compass



### 72020022 Kayak Fly Fishing Package

- 1 72023008 Fly Rod Holder - RAM
- 1 72063101 Sidekick Ama Kit (Dark Green)
- 2 72020001 Hobie Gear Keeper Large 36"



### 72020024 MIRAGE Performance Package

- 1 72066001 V2 ST Turbo Fin Kit
- 1 81397001 Large Twist and Stow Rudder
- 1 80030001 Speedo Tube



### 72020023 Kayak CUSTOMIZATION Package

- 1 71115101 Tool, screw-in fittings
- 5 71117001 Cleat
- 5 71116001 Padeye

FISHING ACCESSORIES

### HOBIE STAKE-OUT POLE

Hold position in shallow water by inserting the Hobie Stake-Out Pole into sand or mud. Fiberglass pole with metal tip, rubber grip handle and attachment line system. (Connect to the Hobie Anchor Trolley System for best results)

72076001 STAKE-OUT POLE

### HOBIE ROD HOLDER EXTENSIONS

Keep your fishing rods secure and reels higher out of the water. These fit right into the molded-in rod holders and offer a larger diameter sleeve that is deeper. Leash the holder extension to the boat and the rod to the holder using the molded eyes.

72020014 ROD HOLDER EXTENSION

### RAM MOUNTS AND LOWRANCE ELECTRONICS

See mount and electronics pages for details.

### ANCHOR KIT

3 pound folding anchor, bag and 60 feet of line. (Connect to the Hobie Anchor Trolley System for best results)

80035A ANCHOR



### HOBIE DRIFT CHUTE

Large cone shaped "para" chute deployed in the water slows your drift in windy conditions when anchoring is not possible or desired. Design keeps chute just under the surface and fully inflated. Anchor line not included. (Connect to the Hobie Anchor Trolley System for best results)

72020009 DRIFT CHUTE





- 72020025 KAYAK TRAVEL PACKAGE**
- 1 72046 Roof Rack Pads - 36"
  - 1 72042 Tie Down Straps
  - 1 80045001 Kayak Cart "Plug-IN" Standard



- 72020026 KAYAK SAFETY PACKAGE**
- 1 72020010 Hobie Safety Kit
  - 1 72020002 Safety Flag
  - 1 72020003 Hydrostar Light



- 72020029 DELUXE KAYAK SAFETY PACKAGE**
- 1 72020010 Hobie Safety Kit
  - 1 72020040 Visicarbon Safety Flag / Light
  - 1 72020032 Bilge Pump

**HOBIE LIVEWELL**

This live bait tank was designed with the serious fisherman in mind. From the tournament angler to the weekend warrior, inshore or off, this livewell is capable of handling almost every fishing situation imaginable! **See Livewell on page 18 for more details.**

- 72020007 Hobie Livewell
- 72020015 Rod Holder - Livewell  
(Rod holders include needed fasteners)



**HOBIE ANCHOR TROLLEY KIT**

Easily deploy your anchor, drift chute or stake out pole over the side of the cockpit area, then move the attachment position forward or aft to hold your boat in the position desired. Easily sit facing down stream / wind at anchor. Simple pulley system and cleat allows adjustment all along one side of your boat anywhere from bow to stern.

- 72020008 ANCHOR TROLLEY KIT

**HOBIE GEAR KEEPER**

Keep your equipment where you left it; safe and onboard with the Hobie Gear Keepers. These low force retractor tools are ideal for gear such as pliers, dykes, lipper tools etc.

- 72020000 SMALL HOBIE GEAR KEEPER  
Features: 36" 50lbs Breaking Strength Spectra Nylon Line, Plastic Snap Clip, 3/8" Quick Connect Split Ring.
- 72020001 LARGE HOBIE GEAR KEEPER  
Features: 36" 60 lbs. Breaking Strength Nylon Coated Stainless Steel Cable, Stainless Steel Spring and Hardware, Plastic Snap Clip.



72020000 72020001



- FISH GRIP**  
Handy fish grip in a glow-in-the-dark plastic material.  
72020019 FISH GRIP



- HOBIE ROD LEASH**  
Keep those nice fishing rods from swimming away. Secure the rod leash to boat and rod. Quick snap connection feature allows easy detachment when needed. Webbing construction with quick connect hook.  
74052001 ROD LEASH - WEBBING

- SAFETY FLAG**  
The 4' tall safety flag will help other boaters see you.  
72020002 SAFETY FLAG 4'  
72020012 DELUXE MOUNT

**THE VISICARBON PRO™** combines a high visibility light and safety flag with a light weight, low drag, and portable style. Insert foam base into molded-in (or Live Well) rod holders or a Scotty mount.  
72020040 SAFETY FLAG/LIGHT COMBO



# HOBIE LIVEWELL

HOBIE LIVEWELL

**Live up your day on the water with the Hobie Livewell!** This live bait tank was designed with the serious fisherman in mind. From the tournament angler to the weekend warrior, inshore or off, this livewell is capable of handling almost every fishing situation imaginable! Water intake and discharge fit right into the existing scuppers in the cargo area. With a high-flow self-priming\* Attwood pump, a 6 volt sealed gel cell battery, adjustable drain, and the capability of holding up to 8 gallons of water this tank can handle almost any creature that you can squeeze into it. Ready right out of the box! Just charge and go! (\*requires forward motion in the kayak to prime pump)

**72020007** Hobie Livewell Bait Tank

**72020015** Rod Holder - Livewell

(Additional rod holders include the required fasteners)

(Livewell replacement parts shown on page 35)

Looking for somewhere to put those extra rods? No problem! Hobie has included three rod holders to make this livewell one of the most functional pieces of fishing equipment that you'll ever own. Three's not enough, you say? Well for those who are ready for anything, Hobie has left you enough room to attach two more! This is a must-have for every Hobie Angler.

**FEATURES:** Pump, On-off switch, 6 Volt sealed Gel Battery, Charger, Battery compartment with lid, Carry handle, Adjustable hold down straps, Twist and Seal access lid, Fully assembled / charge and go! Custom designed to fit the current Hobie Mirage Outback, Sport, Adventure, Revolution, Pro Angler (needs 7" down tube), Quest, Tandem Island, Oasis (2011+) and Odyssey (2011+).





### HOBIE GEAR BUCKET

Add a drop-in "tackle box" to your 8" Hobie Twist and Seal hatch. The Gear Bucket containers are 2 1/2" deep and hang on the hatch lip or can be slipped down into the hull so you can carry several. Keep one on the hatch lip for easy access. Closing the hatch presses the containers seal closed to ensure items stay in place. You can carry fishing tackle, spare parts, snacks, tools, sun screen, first aid supplies and more in these easily size-adjustable storage segments. Get the three pack with handy storage bag and pre-pack your fishing tackle for fishing different species. Be prepared when the fish start biting with easy access inside the hatch just in front of your seat.

- 71704001** Hobie Gear Bucket
- 71706001** 3 Pack with Bag (8" Hobie Gear Bucket)
- 71705001** Bag for 3 Hobie Gear Buckets

### HOBIE GEAR BUCKET - DEEP

Add a drop-in "storage box" to your 8" Hobie Twist and Seal hatch. 5" deep bucket without dividers.

- 71704021** Hobie Gear Bucket - Deep



### HOBIE DRY BAG

8" diameter x 14". This dry bag is built of tough materials. Seals tight to keep your stuff dry.

- 71703001** 8" Hobie Dry Bag



### HOBIE TWIST AND SEAL HATCHES

TWIST AND SEAL HATCHES have a better seal. The lids also hinge open, so you never lose the lid. Designed with a cork-screw-like mechanism for closure, a simple twist of the handle opens or closes the hatch. As the screw pulls down the hatch, you get a tight seal on the "O Ring" seal against the inner cylinder. The hatch seals around the edge of the cylinder and does not have to be held down against a flat surface to seal. This allows the hatch to seal even if the lid is partially open or tipped. Flip the handle into the recess to "lock" it closed. Available in 6" and 8" diameters. These hatches are now standard equipment on all Hobie Kayaks.

\*Retrofit kits include gaskets (and 2 ea #8031130 screws for the 8").

- 71701011** 6" Twist and Seal Hatch
- 71701001** 6" Twist and Seal Retrofit Kit\*
- 71701021** 6" Twist and Seal O Ring
- 71321001** 6" Mount Gasket
- 71702011** 8" Twist and Seal Hatch
- 71702001** 8" Twist and Seal Retrofit Kit\*
- 71702021** 8" Twist and Seal O Ring
- 71331001** 8" Mount Gasket



### HOBIE 6" HATCH BAG

Add a drop-in bag to the 6" Hobie Twist and seal hatch. Kit includes required back-up ring with lip, screws and bag with drawstring. (Available for 6" hatch only)

- 5421** 6" Hobie Bag Kit



### SEE BAG

Transparent 13 oz. vinyl bags make quick work of locating things. Great for organizing gear and personal stuff. Keep your food and spare clothes dry. Easy to carry or tie onboard. Its cylindrical shape will hold odd shapes such as cameras, binoculars, lunches, etc. without distortion of bag and resultant potential leakage.

- 72210T** SEE BAG (8" x 14" 622 cu.in.)
- 72230T** SEE BAG (11" x 19" 2200 cu.in.)



### PLANO® TACKLE BOX

Innovative up-latching fasteners and Dri-Loc® Seal ensure watertight storage.

**TACKLE BOX SMALL** 10 adjustable dividers create 5-15 compartments. Clear/Yellow 9.13" x 5" x 1.25"  
**72020311** TACKLE BOX SMALL

15 adjustable dividers create 5-20 compartments. Clear/Blue 11" x 7.25" x 1.75"  
**72020321** TACKLE BOX MEDIUM

25 dividers create 3-28 compartments. Perfect box for extra long bulk storage. Clear/Red 14" x 9.13" x 2"  
**72020331** TACKLE BOX LARGE

### HOBIE HATCH LINERS

For Hobie Mirage Outback and Revolution. created as part of the popular Pro Angler, the forward hatch bucket IS a space to store gear or fish just inside the hatch lid. Keeps items from sliding FORWARD or back inside the hull and keeps them up off the bilge. Now available for the Hobie Outback and Hobie Revolution.



REVOLUTION



OUTBACK

### HOBIE HATCH LINERS

72020041 HATCH LINER FWD - OUTBACK

72020042 HATCH LINER FWD - REVO

ROD HOLDER / BUCKET

### HOBIE ROD HOLDERS

How you store your gear is totally up to you... Vertical using the molded-in rod holders... extended higher using Hobie rod holder extensions to keep your reels dryer or now... Horizontal and secure in our new Hobie Horizontal Rod Holders! Install on any kayak. Tip protector and secure clasp around rod handle.



**HOBIE HORIZONTAL ROD HOLDER KIT** Keep your fishing rod secure and protected along the side of your kayak. Insert the rod tip into the tip protector and lock the rod handle into the clasp. Easy to install using the provided hardware. Choose either through-bolts or sheet metal screws. Fits any kayak. Patent Pending.

72021060 HORIZONTAL ROD HOLDER KIT

**HOBIE H-BAR** The H-Bar from Hobie adds utility and options to your Hobie Mirage Pro Angler. Designed with the stand-up angler in mind, the H-Bar not only provides standing stability, but a great support platform for entering and exiting your kayak. Use the H-Bar to pull yourself up and make a cast to feeding fish. Made from clear-coated anodized aluminum, the H-Bar is light, strong, and quiet so fish don't spook. Mount accessories on the H-Bar like fishfinders or rod holders or leave it clear for stand-up paddling. Add a stripping basket to the front for snag-free fly fishing. Cast further while you lean against the foam pad in comfort. With the removal of two pins the H-bar folds away in seconds, leaving your front hatch and cockpit area fully accessible.

**84500111** HOBIE H-BAR / PRO ANGLER



**HOBIE MOLDED-IN ROD HOLDER EXTENSIONS** Keep your fishing rods secure and reels higher out of the water. These fit right into the molded-in rod holders and offer a larger diameter sleeve that is deeper. Leash the holder extension to the boat and the rod to the holder using the molded eyes.

**72020014** ROD HOLDER EXTENSION

H-BAR / ROD HOLDER

# RAM ROD HOLDERS / MOUNTS

is the revolutionary universal ball and socket mounting system that allows you to mount practically anything anywhere. Unlike other mounts on the market, RAM allows you to mount items where you need them most. If you need to mount a Rod Holder, GPS or FishFinder look no further. RAM mounts will help you make a professional job easy. Its unique design provides easy installation, mobility, strength, versatility, vibration protection and durability, all at a low cost. RAM is backed by a Lifetime Warranty which makes it the mounting system of choice. To provide light weight strength and corrosion resistance, RAM uses marine grade aluminum with a powder coated finish, light weight nylon injected molded plastic, stainless steel hardware and rubber balls.



- 72023000 RAM TUBE ROD HOLDER W/ BASE (1.5")
- 72023010 RAM TUBE ONLY (1.5")
- 72023001 RAM SMALL DIAMOND BASE (1")
- 72023002 RAM SPACE SAVER BASE (1.5")
- 72023003 RAM TUBE BASE 2 X 2.5 (1.5")
- 72023004 RAM POST CONV. ATTWOOD,SCOTTY (1.5")
- 72023008 RAM FLY ROD HOLDER W/BASE (1.5")
- 72023013 RAM (PLASTIC) PIVOT ROD HOLDER (1.5")
- 72023022 RAM PIVOT ROD HOLDER W/FLUSH MNT
- 72023014 RAM TUBE (PLASTIC) ROD HOLDER (1.5")
- 72023015 RAM ACCESS-TUBE WEDGE MOUNT (1.5")
- 72023016 RAM ACCESS-TUBE WEDGE MOUNT (1")
- 72023017 RAM U-BOLT RAIL BASE w/BALL (1")



72023013 RAM TUBE (PLASTIC) PIVOT ROD HOLDER (1.5")



72023014 RAM TUBE (PLASTIC) ROD HOLDER (1.5")



72023022 RAM TUBE (PLASTIC) PIVOT ROD HOLDER W/ FLUSH MOUNT



72023000 RAM TUBE (ALUMINUM) ROD HOLDER W/ 72023003 BASE (1.5")



72023001 RAM SMALL DIAMOND (1")



72023003 RAM 2 X 2.5 (1.5")



72023008 RAM FLY ROD HOLDER (1.5")



72023015 ACCESSORY TUBE WEDGE MOUNT (1.5")



72023016 ACCESSORY TUBE WEDGE MOUNT (1")



72023004 RAM POST SCOTTY CONVERSION (1.5")



72023017 U-BOLT RAIL BASE (1")



72023002 RAM SPACE SAVER (1.5")



# SCOTTY ROD HOLDERS / MOUNTS

## SCOTTY ROD HOLDERS

Bait Caster/Spinning Rod Holder. Holds a baitcaster reel in a cushioned cradle. A slot in the front of the holder allows for a spinning reel to be securely held in position. The rod holder design has a side mounted flange, which leaves the bottom open. This allows for the rod holder to accommodate trigger sticks. Pistol grip rod butts easily clear the sides of the rod holder for quick rod retrieval. Rods can be secured in holder with a soft latching strap which snaps over the top. Fully adjustable up and down and rotates 360 degrees. Requires either the combination deck or side mounting bracket or flush deck mount (bolting dimensions - 1 5/16" x 3 3/16").

- 80048001 Rod Holder - Bait Caster w/mount
- 80055001 Rod Holder - Fly Rod w/mount
- 80048004 Rod Holder With Side-Deck Mount
- 80048005 Rod Holder Rocket Launcher
- 80048006 Gear Head Mount
- 80048002 Rod Holder Height Extender 8.5"
- 80048003 Rod Holder Height Extender 6.5"
- 80052001 Mount - Deck / Side
- 80049001 Mount - Flush
- 71330001 Gasket - Scotty Mount



80048001 BAIT CASTER ROD HOLDER WITH DECK / SIDE MOUNT



80055001 FLY ROD HOLDER WITH DECK / SIDE MOUNT



80048005 ROD HOLDER ROCKET LAUNCHER



80048004 ROD HOLDER W/SIDE-DECK MOUNT



80049001 FLUSH MOUNT



80048006 GEAR HEAD MOUNT



80048003 ROD HOLDER HEIGHT EXTENDER 6.5"



80048002 ROD HOLDER HEIGHT EXTENDER 8.5"



79052000

## I - ACCESSORY HOLDER KIT

Designed to allow the attachment of rod holders and other accessories to the Hobie Mirage inflatable kayaks. The accessory kit comes with 2 mount plates and attachment glue. 4 hole pattern fits Scotty mount and RAM / Scotty hole pattern products. Mount the 80052001 Scotty Deck/Side mount and Scotty rod holders or adapt for the RAM products by adding 72023004 RAM Ball Scotty adapter. (1/4-20 Screws sold separately, check length for desired accessory / #8030380 7/8" length for Scotty deck mount).

79052000 i - ACCESSORY HOLDER KIT

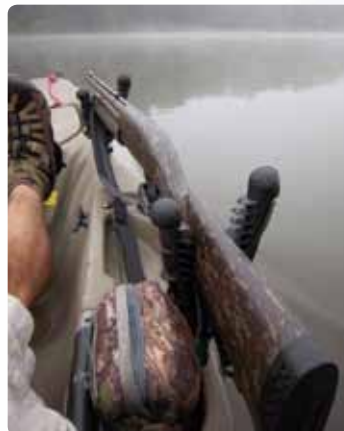

## HUNTING



**GUN MOUNT** for your kayak. Mounts to kayak rail for easy access.  
72020013 GUN MOUNT

# LOWRANCE FISHFINDERS

## COMPACT SERIES



**Note: Lowrance Warranty is handled directly by Lowrance. Refer to documentation included with these products.**



### M68C S/MAP COMPACT FISHFINDER

- High-brightness 3.5" (8.9cm) diagonal 256-color, 1/4 VGA active matrix TFT transreflective LCD
  - Impressive 320V x 240H pixel resolution
  - 12-parallel channel GPS+WAAS receiver with internal antenna
  - 800 W peak-to-peak power
  - Depth penetration to 600 feet (183 m)
- Find fish and yourself in dazzling color, at a highly affordable price. Features high-detail hydrographic mapping and an internal GPS+WAAS receiver.

**72020017** M68C

(Use Ram Mount 72023007 & Installation Kit 72020011)

### X67C COMPACT FISHFINDER

- High-brightness 3.5" (8.9cm) diagonal 256-color, 1/4 VGA active matrix TFT transreflective LCD
  - Impressive 320H x 240W pixel resolution
  - 800 W peak-to-peak (100 W RMS) power
  - Low-profile high-performance 200 kHz Skimmer® - with built-in water surface temp sensor
  - Depth penetration to 600 feet (183 m)
- An exciting 256-color sonar performer with temp at a great low price. This unit packs a lot into a small package - 320x240 resolution, FishReveal™, HyperScroll™, ASP™, COLORLINE®, and more.

**72020016** X67C

(Use Ram Mount 72023007 & Installation Kit 72020011)

### X-4 PRO FISHFINDER

- Film SuperTwist LCD with 4-level gray scale
  - Compact Dual-Search 83/200 kHz Skimmer® with dual beams producing up to 120 degrees of wide fishfinding coverage
  - Depth penetration to 1000 feet (305 m)
- Featuring the Lowrance Dual-Search (DS) 83/200 kHz technology, this convenient, space-saving sonar unit comes with a high-contrast 240x160, 4" Film SuperTwist display with 4 levels of gray scale definition.

**72020005** X-4 Pro

(Use Ram Mount 72023007 & Installation Kit 72020011)

ELECTRONICS

## FULL SIZE SERIES



### ELITE-5 FISHFINDER/GPS CHARTPLOTTER

- True 12.7 cm/5 in., 480x480 pixel SolarMAX™ 256-color TFT display
- Dual-frequency 83/200 kHz fishfinding
- Internal 16-channel GPS antenna
- Built-in background mapping/charting
- Navionics® and other chart options available
- Depth penetration to 1000 feet (305 m); 500 W RMS, 4,000 W Peak-To-Peak

The newcolor Elite-5 fishfinder/chartplotter brings highperformance and high color to on-the-water enjoyment in every way, and without a highprice. Get incredible precision and functionality, in addition to a spectacular new view.

**72020038** Elite-5 FishFinder / GPS Chartplotter

(Use Ram Mount 72023021 & Installation Kit 72020039)

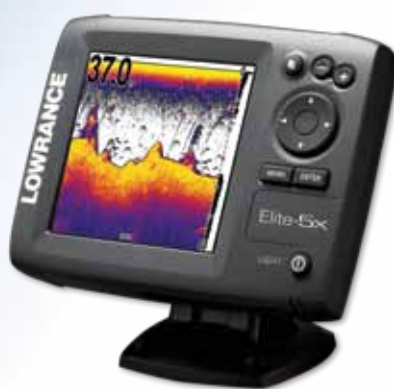

### ELITE-5X FISHFINDER

- True 12.7 cm/5 in., 480x480 pixel SolarMAX™ 256-color TFT display
- Dual-frequency 83/200 kHz Skimmer® transom-mount transducer with internal temp sensor and up to 120° of wider sonar coverage
- Unique TrackBack™ feature for multi-page scroll-back review of fishfinder history
- Depth penetration to 1000 feet (305 m); 500 W RMS, 4,000 W Peak-To-Peak

The color Elite-5X Fishfinder brings a level of high performance and high color to serious anglers for an amazing low price. And it comes fully packed with legendary Lowrance features, incredible precision and functionality, in addition to a spectacular new view.

**72020037** Elite-5X-Pro

(Use Ram Mount 72023021 & Installation Kit 72020039)



### MARK-5X-PRO FISHFINDER

- High-resolution 5 in./12.7 cm, 480x480 pixel Film SuperTwist LCD
- Dual-frequency 83/200 kHz Skimmer® transom-mount transducer with internal temp sensor and up to 120° of wider sonar coverage
- Unique TrackBack™ feature offers immediate scroll-back to review multiple pages of echosounder history
- Depth penetration to 1000 feet (305 m); 300W RMS, 2,400W Peak-To-Peak

Powerful yet simplified performance, only Mark fishfinders offer legendary Lowrance features with a newly-optimized automatic mode for high-performance finding with turn-on-and-fish ease. Along with easy-to-use menus, there's also an Advanced User Mode for fine-tuning to water conditions.

**72020036** Mark-5X-Pro

(Use Ram Mount 72023021 & Installation Kit 72020039)

## MOUNT FISHFINDERS

**RAM MOUNTS** We have chosen the best RAM mounts for use on the Hobie kayaks and our Lowrance Fishfinders.

### COMPACT FISHPINDER MOUNT

FITS LOWRANCE X4-Pro, X67C, M68C; HUMMINBIRD PIRANHA MAX 10, 15, 20; EAGLE CUDA 240I, 240, 168, 128, FISHEASY 320C, FISHEASY 240

**72023007**

### FULL-SIZE FISHPINDER MOUNT

FITS LOWRANCE MARK, ELITE SERIES AND HUMMINBIRD 100, 300, 500, MATRIX SERIES

**72023021**



**72023007  
FISHPINDER  
COMPACT MOUNT**



**72023021  
FISHPINDER  
FULL-SIZE MOUNT**

## INSTALL FISHPINDERS

### COMPACT FISHPINDER INSTALLATION KIT

Hobie has taken the guess work out of installing a fishfinder by providing a simple yet complete installation kit. This kit is adaptable to virtually any kayak and will run most fishfinders on the market, like our Lowrance Compact Series fishfinders. The only thing you need to do is determine the location of your new unit! Kit includes: Dry Bag, Battery Harness, AA Batteries, Snap Connector, Foam Transducer Pad, Zip Ties, Marine Goop, Displacement Connectors, Rubber Grommet.

**72020011** COMPACT FISHPINDER INSTALL KIT

**72021011** SPARE TRANSDUCER PAD



### FULL-SIZE FISHPINDER INSTALLATION KIT

Hobie's full size fishfinder installation kit integrates a waterproof 9AH gel cell 12-volt battery to provide more power to run larger units like the Lowrance Full Size Series of fishfinders. It can also be used to run smaller units for longer periods of time. Kit includes: Waterproof 9AH gel cell 12-volt battery with attached waterproof wiring and connectors, 12-volt battery charger, foam battery pad, foam transducer pad, zip ties, marine goop, wire connectors, rubber grommet, wire cap

**72020039** FULL SIZE FISHPINDER INSTALL KIT

**72021011** SPARE TRANSDUCER PAD



## GPS - COLOR

**ENDURA™ OUT&BACK** Smartly designed for easy, out-of-the-box use, the Out&Back's straightforward menu makes navigation simple. Its large color transfective touch-screen allows for easy viewing and operation, and its pre-loaded mapping content with key land features such as lakes, rivers, primary roads and key Points of Interest (POI) provides accurate situational awareness. Out&Back is also easy to customize, including a recording option that saves trails and routes allowing quick recall or sharing, a geocaching application providing paperless geocaching with Geocaching.com and power standby to conserve battery life as well as provide quick restart. The Out&Back supports a wide range of optional mapping content. Like all Endura handhelds, the Out&Back accepts public domain files and community-based content such as GPX trails, routes and general outdoor POIs.

**72020018** Endura Out&Back GPS

(Use Ram Mount 72023018)



### GPS MOUNT

**72023018** RAM MOUNT LOWRANCE ENDURA



**72023018  
ENDURA GPS MOUNT**



**72023006  
UNIVERSAL MOUNT**

### UNIVERSAL ELECTRONICS MOUNT

**72023006** RAM UNIVERSAL MOUNT 6 1/4 X 2

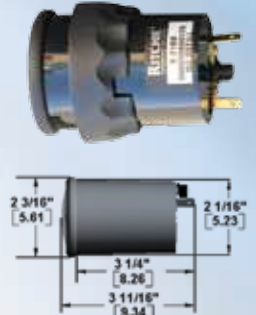

### RITCHIE PANEL MOUNT COMPASS

When you're miles out to sea or simply trying to navigate your way through uncharted waterways, rest assured that you can make it back home with one of the worlds most innovative panel mounted compasses.

**72020004** RITCHIE COMPASS PANEL MNT X-21

#### Features:

- 2" (5.08 cm) Direct Reading Dial
- Easily Installed, Fits Standard 2 1/16" (5.50 cm) Instrument Hole
- View Adjusts up to 30 degrees
- Scientifically Matched Sapphire Jewel & Hardened Steel Pivot Dial Movement
- Exclusive Built-in Green NiteVu Lighting
- High Temperature Composite Construction for Extended Operating Range
- DirectiveForce Magnets
- Exclusive 5-Year Ritchie Warranty

# KAYAK CARTS



Kayak Carts are a must for easily transporting your kayak from car to water's edge. Simply roll the kayak down to the water and off you go! All of the latest Hobie Kayaks can use "Plug-in" carts. "Plug-in" carts do just that... they plug right into the bottom of your kayak. Choose Standard for light duty and solid surfaces, Heavy Duty for heavy loads and rough terrain or the "all-terrain" Hobie Trax "2" version which is the best over soft sand. Each cart has a sturdy stainless steel frame. Some older models or other brands of kayaks may require the use of a cart that straps on.

**CART KEEPER FEATURE (fig. 1a)** Standard on Hobie Plug-in carts! After insertion of the cart, pull the dome pin out and re-insert as shown to keep the cart captive. **POST COLLAR / CLAMP FEATURE (fig. 1b)** Collar clamps help to reduce the direct loading of the cart on your kayak's bottom / keel. Direct loads on hull bottoms can cause deformation of the kayak. Even loading at scuppers and hull bottom reduces hull-bottom deformation issues.

**CAUTIONS:** Be certain that the cart inserts clear through the kayak and protrudes into the cockpit / cargo area surface. Kayaks should never be left on carts for prolonged periods of time.



## KAYAK CART "PLUG-IN" STANDARD

Light weight with durable tires and strong spoked wheels. Stainless steel frame. Wheels are easily removable for storage. Also includes cart keeper feature and cart clamps. This cart has the medium capacity. (150 lb Capacity). Great for transport over solid surfaces.

**80045001** STANDARD CART

**80045101** i - KAYAK CART

i - kayak cart (not pictured) plugs into an inflatable's MirageDrive well.



## KAYAK CART - "PLUG-IN" HEAVY DUTY

Highest capacity cart with very durable knobby (Solid Foam) wheels. Welded Stainless steel frame. Wheels are easily removable for storage. Also includes cart keeper feature and cart clamps. This cart has the highest capacity. (225 lb Capacity) Recommended cart for Pro Angler and Tandem Island. Best for transport over solid surfaces.

**80046001** HEAVY DUTY CART

**80046021** PIN, QUICK CLIP

Wheel retainer pin for Std and HD carts.



## KAYAK CART "PLUG-IN" HOBIE TRAX "2"

The Trax "2" Cart has 24 cm (blow-molded polyurethane) pneumatic tires. These tires have a high capacity and are very durable! Welded Stainless steel frame. Wheels are easily removable for storage. (176 lb Capacity) This is the best all around cart for soft sand and uneven terrain. The tires are wide and can be deflated for better performance over softer sand and soil.

**80044101** TRAX "2" CART

TRANSPORTATION

**HOBIE TANDEM ISLAND DOLLY** Full size dolly for the Tandem Island includes a hull / ama cradle, and a pull handle. Much stronger and easier to load and use than plug-in carts for the Tandem Island. Two different wheel styles allow for optimum performance on hard pack surfaces – or soft sand beaches. Choose beach wheels for use over soft sand or other surfaces. Choose the tuff tire if your launch surfaces are solid. The handle makes it easier to insert or remove the cart under the boat or pull along when un-loaded. The handle also acts as a "kick-stand" to keep the cradle upright during loading. The handle and wheels are easily removable for storage.

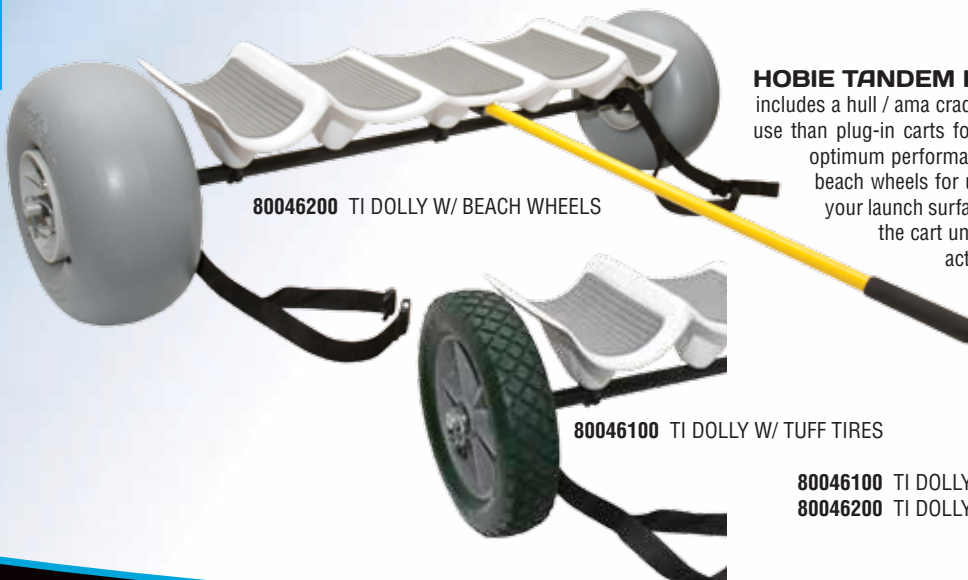

**80046200** TI DOLLY W/ BEACH WHEELS

**80046100** TI DOLLY W/ TUFF TIRES

**80046100** TI DOLLY - WITH TUFF TIRES

**80046200** TI DOLLY - WITH BEACH WHEELS



### KAYAK CART - UNIVERSAL

This cart attaches to any kayak via straps and buckles. Pneumatic wheels allow this cart to roll more easily over rough terrain. Padded "hull-centering" bunks keep the kayak centered on the cart while the tie down straps hold the cart firmly to the boat. Carries loads up to 150 lbs. Welded Stainless steel construction. Wheels are easily removable.

**80041** UNIVERSAL CART



### MINI KAYAK CART

An easy way to pull your kayak around. Durable and lightweight, it simply straps on to the hull and off you go. Stores neatly in your hull's cargo bay while you're paddling. Best on smooth surfaces, not all-terrain.

**72080** Mini Cart



### POST COLLAR / CLAMP KIT

Collar clamps help to reduce the direct loading of the cart on your kayak's bottom / keel. Direct loads on hull bottoms can cause deformation of the kayak. Even loading at scuppers and hull bottom reduces hull-bottom deformation issues. Fits all year-models of Hobie plug-in carts. Standard on current carts.

**80044201** COLLAR / CLAMP KIT



**80043**

### HEAVY DUTY UPGRADES

Standard or Trax plug-in carts can be upgraded to heavy duty pneumatic wheels. May require removal of welded washer on some versions or bonding of the sleeve to the axle using epoxy depending on cart vintage.

**80043** Plug-in UPGRADE KIT

Newer Standard carts have a longer axle. 2 holes for keeper pins. One for standard wheels and the outermost for the HD wheels. Simply buy two new HD foam wheels and install.

**80046041** HD Foam Wheel

### KAYAK TRAILERS

These trailers are versatile platforms that can be used for any kayaks. Order the basic single or double trailer to carry one or more kayaks inverted on the crossbars (crossbar padding is not provided). For the Adventure Island, Tandem Island or Pro Angler, add the custom designed hull cradle sets. These are form fitted and foam covered. Strap down your Adventure Island with the custom tie down set. For two Adventure Islands, order the double trailer (Double-Double for two Tandem Islands) add two cradle sets and the center Tower System. The Tower includes mast / sail hangers and is also designed to mount an equipment box on top (Does not include box shown). Easily mount the Hobie Toy Box on top of the Tower (Thule box shown). Trailers ride on 8" wheels and use a 1 7/8" coupler.



Trailers shown with Adventure Island Cradles 72020400  
**Trailer prices DO NOT include freight to dealer or assembly costs. Thule storage box shown is not included and not available through Hobie Cat.**

*NOTE: Loads may require a red warning flag if over hanging lites by over 4 feet.*

### 38652000 TRAILER - SINGLE AI / PRO A

Shown above with AI cradle set (#72020400) (48" Crossbars / 200 lb Capacity) .

### 38652001 TRAILER - SINGLE TI

(48" Crossbars / 350 lb Capacity) .

### 38652200 TRAILER - DOUBLE

Shown above with 2 AI and cradles sets (#72020400) and (#38652210) tower system (84" Crossbars / 550 lb Capacity).

### 38652201 TRAILER - DOUBLE / DOUBLE

Not shown. Required to carry 2 Tandem Islands or one TI and AI side-by-side. (96" Crossbars / 550 lb Capacity).

72020400 AI CRADLES



72020402 TI CRADLES



72020401 PRO A CRADLES



### 72020400 CRADLE SET (1 boat) - ADVENTURE ISLAND

### 72020402 CRADLE SET (1 boat) - TANDEM ISLAND

### 72020401 CRADLE SET (1 boat) - PRO ANGLER

(Cradle mount spacing 67" for proper fit)

### 38653300 UNIVERSAL PAD SET - ALL OTHER KAYAKS

### 38652210 TOWER

Add the optional tower for equipment box mounting on a double trailer, multi kayak transport (Up to 4 kayakers leaned against tower). Also includes two mast carriers for 2x AI/TI configuration.

### STORAGE BOX "TOY BOX"

Roto-molded seamless with molded-in graphics. Big enough to hold paddles, MirageDrives, Seat backs, Life Vests and wet wear and have room left for odds and ends. The bottom is ribbed to allow wet things to drain.

There is full access from front and back. Mounting hardware is not included. Length 10' 4", Width (rear) 21", Depth (rear) 13", Width (front) 19 1/2", Depth (front) 10", Weight 55 lb.

### 1825WHT Toy box

Additional freight charges may apply.

**Prices DO NOT include freight to dealer.**



TRANSPORTATION



**ROOF RACK PAD**

Beefy car roof rack pads, made from durable black polyester with Hobie diamond logo. Easy-on split bottom with Velcro™ closure.

- 72045 24" Roof Rack Pad (Pair)
- 72046 36" Roof Rack Pad (Pair)
- 72044 24" AERO Rack Pad (Pair)
- 72049 36" AERO Rack Pad (Pair)



**QUICK STRAP SPORTRACK**

Easily installs on any vehicle with front and rear doors or opening windows. The straps secure inside the car, no gutter hooks are required. Packed in mesh storage bag (#72040 with bow and stern tie downs).

- 72040 Quick Strap SportRack (30" Pair)
- 72035 Quick Strap SportRack (24" Pair / NO LINES)



**TIE DOWN STRAPS**

Car roof rack tie-down straps, made of durable black polypropylene webbing.

- 72042 TIE DOWNS 12" (Pair)
- 72043 TIE DOWNS 15" (Pair)

**HOBIE STEEL-CORE TIE DOWN STRAPS**

Get a secure feeling when leaving your kayaks loaded, but in an unsecure area. Tie-down straps that incorporate cut resistant steel cable within for added security! Strap it down and LOCK it down... all-in-one function!

**STEELCORE FEATURES**

STEELCORE IS AN ALL IN ONE SECURITY DEVICE AND TIE-DOWN STRAP. PROTECTS YOUR GEAR FROM THEFT WHEN YOU TIE IT DOWN. **LOCK** A WEATHER RESISTANT STAINLESS STEEL SCALPED CAM LOCK FROM ILLINOIS LOCK COMPANY **BUCKLE** HARDENED AIRCRAFT ALUMINUM (6061) DESIGNED BY THE BEST AEROSPACE ENGINEERS **STRAP** THICK POLYPROPYLENE WEBBING. WITH A CORE MADE FROM CUT RESISTANT STEEL AIRCRAFT CABLE **BUNGEE /CORD LOCK** KEEPS IT FROM UNRAVELING WHEN ROLLED UP AND HOLDS THE EXTRA STRAP WHEN IN USE

- 72047 12' STL-COR STRAP (Pair)
- 72048 15' STL-COR STRAP (Pair)



**COVERS**



HOBIE TANDEM ISLAND SHOWN



**KAYAK COVERS**

Protect your kayak from the effects of the weather, UV rays, dirt, leaves and birds. We have chosen four sizes to fit the entire line of Hobie Kayaks. These covers are easy to install or remove, fits over the hull (like a fitted sheet on a mattress). Straps and pull string adjust for a tight fit. Cross straps secure the cover on your hull for windy conditions. Heavy duty UV resistant canvas material in a neutral color for better aging. These covers fit over the hull when upright or upside down. To help prevent distortions to the hull bottom shape, Hobie recommends that our kayak hulls be stored upside down resting on the cockpit rails. This is also best for deflecting rainwater and prevents water pooling in the cockpit or on the cover. When planning to store a hull upright, be sure to properly support the hull bottom to prevent hull distortions.

- 72050 Kayak Cover / 9'-12'  
(LANAI, MAUI, SPORT, KONA-Tight)
- 72051 Kayak Cover / 12'-15'  
(KONA [LOOSE], PURSUIT, MIRAGE CLASSIC, TANDEM / OASIS, OUTFITTER, QUEST, OUTBACK, REVOLUTION, PRO ANGLER)
- 72052 Kayak Cover / 14'-16'  
(ADVENTURE, TANDEM/OASIS, ODYSSEY)
- 72053 Kayak Cover / 14'-16'6\*\*  
(\*ADVENTURE ISLAND-FOLDED)
- 72054 Kayak Cover / 16'-18'6\*\*  
(\*TANDEM ISLAND-FOLDED)



**RUDDER COVER ISLAND / TI**

Rudder protection for 2011+ AI and all Tandem Island Rudders. Red color helps for trailering visibility.

- 82420001 Rudder Cover Island / TI



**SHOCKCORD BALL TIES**

Lashing equipment to your boat is quick and easy with this handy tie-down. Dozens of uses.

- 370 SHOCK CORD BALL TIES EA

# HOBIE LUGGAGE

We now offer a selection of quality Hobie luggage. These three pieces represent the most popular luggage items. A back pack, rolling duffel and an expandable rolling suitcase are just the thing for the Hobie traveler! All bags are Army green.



## HOBIE WHEELED DUFFLE

- Wheeled heavy duty duffel bag
- U-shaped main opening for easy access
- Zipped compartments on both sides, one with mesh pocket
- Shoe compartment with easy to clean lining material
- Sturdy bottom structure and edge guard
- Detachable inside supporting straps to keep bag standing
- Padded shoulder strap

**72020501** HOBIE WHEELED DUFFLE  
26" x 13" x 13"



## HOBIE EXPANDABLE UPRIGHT

- Main interior compartment includes top and side mesh pocket
- 3 zippered compartments in the front lid for easy access of small items and shoes
- Zippered packing compartment with straps inside lid provides better organization
- Smooth retractable handle and rolling wheels
- Padded top, side and two front handles make lifting easy
- TSA lock included
- Detachable toiletry bag included
- Integrated ID tag

**72020500** HOBIE EXPANDABLE UPRIGHT  
29" x 17" x 11"

## HOBIE BACK PACK

- 4 zippered compartments for better organizing contents
- Padded laptop sleeve in main compartment
- Organizer for cell phone and office items in front compartment
- Zippered media pocket for mp3 player
- Ergonomic padded shoulder straps with hardware adjusts and cross strap to stabilize the pack
- Molded form back panel with air flow channels for carrying comfort
- Side zippered pocket and mesh pocket to hold small items and water bottle
- Attached rain cover inside bottom zippered pocket

**72020502** HOBIE BACK PACK  
21" x 14" x 9"



## MIRAGEDRIVE STOW BAG

Protect your MirageDrive... and other goods in your car from the drive! This heavy duty Cordura and mesh bag fits the complete MirageDrive with standard fins or the ST Turbo length. It has small pockets inside for the speedo tube, scupper plugs or spare parts. Has a carry handle and a shoulder carry strap. There is extra space in the bag for things like a life vest or drive well plug. Revised bag design is longer to better accommodate ST Turbo fins. Also includes "D" ring fittings to allow attachment to Inflatable rolling bags. Large enough to store your Inflatable's drive, pump and 4 piece paddle.

**80024** MIRAGEDRIVE BAG



## GUSSETED STOW BAG

Our 6" by 12" gusseted tramp bag rises to the occasion. It has hooks on both ends to clip to your boat and carries the Hobie logo. Also available in 8" x 12" size. Securely stow tool, gloves or small parts for easy access on board your kayak.

**72000B** 6"x12" GUSSETED TRAMP BAG  
**72005B** 8"x12" GUSSETED TRAMP BAG



## TALIC SEAHORSE RACK

Portable storage for kayaks under 100 lbs. Made of corrosion resistant anodized aluminum. Can be used indoors or out. Raises your kayak up to accessible height for outfitting accessories, cleaning or just keeping it off the garage floor. Collapsible for storage.

**72088001** 31" Talic SeaHorse Rack



### DRIVE WELL SEAL

Keeps the seat area drier. Seals the aft end of the MirageDrive well. Limits the incursion of water into the cockpit caused by the surge action of the drive fins. Testers also claim some improvement of forward thrust. Easily attaches to any MirageDrive. Kit includes one seal and two attachment "zip ties".

81037001 Well Seal

81038001 i - Well Seal



### MIRAGEDRIVE SPARE PARTS KITS

Spare parts kits include a fin, mast, sprocket, chain and appropriate parts for the drive version. Older drives have sprockets and masts that use a set screw connection. V2 drives use threaded sprockets and masts. All in a handy zippered pouch. Don't waste a day on the water when your MirageDrive could be easily repaired. Available for the standard fin drive or a drive with the ST Turbo fins. Standard kit shown.

80010201 Standard (Set Screw Sprocket)

80013201 Turbo (Set Screw Sprocket)

80010301 V2 Standard (Threaded Sprocket)

80013301 V2 Turbo (Threaded Sprocket)



### LEASH KIT - MIRAGEDRIVE

If you ever remove your MirageDrive while on the water... protect your investment from an accidental drop overboard. Includes hardware for attachment to the hull.

74052101 LEASH KIT - MIRAGEDRIVE

### PEDAL PAD KIT

Softer on your feet! Neoprene pads are self adhesive and stick right to your pedals. Stock on Drives built in 2010+

72020034 PEDAL PAD KIT BLACK (PAIR)



### PADDLE "T" HANDLE

Convert your kayak paddle to a canoe style paddle. Easier to store on many models of Hobie Mirage kayaks where paddle use is unnecessary while using the MirageDrive. Plugs into the female half of the kayak paddle.

74049001 PADDLE "T" HANDLE



### MIRAGE SEAT PAD - INFLATABLE "I-COMFORT"

Adjustable comfort! Replaces the standard foam seat pad for the Hobie Mirage. Adjust the cushion by adding or releasing air pressure. Like an inflatable camping pad. Has an internal self inflating foam and an air valve through which the pad can be further inflated / deflated to suit the users comfort. Not designed for use on Hobie Mirage Inflatable kayaks. Can be used in combination (stacked) on the standard seat cushion.

72020028 MIRAGE SEAT PAD - INFLATABLE "i-Comfort"



### STEERING KNOB ASSY

Get a grip on your steering. More comfortable hand position - better leverage. Fits all 2011 Mirage model steering handles and all Tandem Islands.

88991355 KNOB ASSY



### HOBIE MIRAGE SPEEDO

Removable, "pitot tube" speedometer measures your pedaling speed. Fits current MirageDrive systems only (Plastic spine on drive serial number 16054 and higher).

80030001 SPEEDO



## KAYAK RIGGING KIT - HARDWARE

Set of fasteners for rigging a kayak for fishing accessories. A custom selection of hardware chosen by the Hobie fishing experts. Includes stainless bolts, nuts, washers, well nuts and more. All packed in a handy Plano box. You can purchase any of the items separately. Purchase the kit and have it all, or pick and choose your own based on your individual needs. All included parts are listed below as well as many more in the numerical section of our catalog.

**72020300** Kayak rigging kit

Item	Qty	Part	Item
1	1	72020311	PLANO BOX - KAYAK RIG KIT
2	12	8031191	SCREW 1/4-20 X 1-1/4 PHMS
3	12	8030111	SCREW 10-32 X 1 PHMS-P SS
4	12	8030251	SCREW 10-32 X 1" FHMS
5	12	8030161	SCREW 10-32x1 1/2 RHMS-P SS
6	18	8080701	WASHER 1/4 X 1 SS HP
7	24	8080731	WASHER #10 FNDR SS
8	12	8050111	NUT 1/4-20 HX NYLOCK
9	24	8050201	NUT 10-32 NYLOCK LOPRO
10	12	8050221	NUT (WELL NUT) 10-32 x1
11	8	71110001	PAD EYE-BLK NYLON-3/8"
12	18	81029	LINE HANGER
13	8	78510001	BUNGEE HOOK

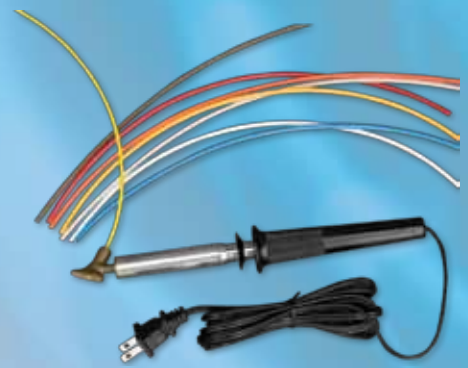
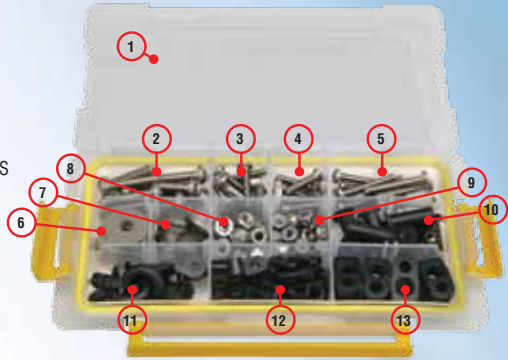

## KC WELDER PRO WITH HOBIE COLOR ROD STOCK

80 Watt element, flat tip and a 3/16" hole in tip for rod insertion. Includes a selection of Hobie color welding rod. Fix holes and cracks or customize polyethylene products. Insert the rod into the tip and place against the product to be welded. The tip heats the plastic surface and the rod. As the materials melt, move the tip along the repair area while pushing the rod into the tip to fill the repair area with new plastic material. Plug small holes after moving accessories. Rebuild keels after excessive wear from dragging.

**72097001** KC WELDER PRO

## TECH TIP!

**"WELL NUT" FASTENERS** are tubular rubber fittings with an imbedded brass nut in the base. These are similar to a molly screw commonly used in sheet rock. They expand within the structure and give you a virtual backing nut and washer in an area that is inaccessible. Well nuts can be used for mounting many accessories to kayaks. Simply drill a hole as a net-fit dimension for the well nut. Insert the nut and position the hardware to be fastened. Insert and thread in the screw. Tighten until very snug. The brass nut is drawn up against the inside surface of the kayak which expands the rubber to a dimension that is too large to pull through the hole.



## STAINLESS STEEL POCKET KNIVES

**STANDARD** - Marlin spike and single blade. 3.5 oz.

**1550** Standard

**DELUXE** - Marlin spike, knife blade, shackle tool, and screwdriver. 4.0 oz.

**1551** Deluxe

**YACHTSMAN** - Marlin spike, blade, shackle tool. 2.0 oz.

**1555** Yachtsman



## GERBER NEEDLENOSE MULTI-PLIER®

Since 1939 Gerber has produced high quality innovative products for the outdoors. Features included in this model are; needlenose pliers, wire cutter, crimper, standard/ metric scale, lanyard ring, cross head screwdriver, bottle/can opener, serrated sheeps foot blade, large, medium, and small flathead screwdrivers, file, drop point blade, and it adapts to the Gerber Tool Kit! This Multi-Plier® comes with the S.A.F.T. PLUS™ System where each component opens independently of all others, locks tightly against a positive stop roll bar and stays tight until you unlock it. Stainless steel construction with a limited lifetime warranty!

**83102** GERBER TOOL



74050001

## PADDLE LEASH

Secure paddle to your boats bow eye. Keep the paddle with the boat after a capsized. By holding the paddle after a capsized you can also be sure that the boat stays with you and cannot drift away. Web paddle leash is made from hollow webbing and an internal shock cord. Coil leash is elastic plastic coil.

**74050001** PADDLE LEASH - WEB 4.5'

**74051001** PADDLE LEASH - COIL



74051001



## MULTI STRAP SYSTEM

Hang your kayak for storage, use as bow and stern lines or use them as carrying handles. Multi purpose straps can be attached to the boat and adjusted for many uses. Made from durable black polypropylene webbing.

**72041** MULTI STRAP (Pair)



## THIGH CONTROL STRAPS

Padded thigh control straps. Clip to standard kayaks. Hook over thigh/knees for better control and power when paddling.

**72500001** THIGH CONTROL STRAPS



## HOG RING PLIERS

Cinch rings, hog rings, upholsterers clamp. They are all the same and these are the pliers to crimp them with. Use them on shockcord.

**83104** Each



**BOW SHACKLE - THREADED PIN**

Part #	Pin Dia.	Width	Length	Max Ld#
SP150061	1/4"	9/16"	15/16"	4400



**"D" SHACKLES - THREADED PIN**

Part #	Pin Dia.	Width	Length	Max Ld#
SP150041	5/32"	3/8"	5/8"	1100
SP150051	3/16"	1/2"	11/16"	2640
SP150052	3/16"	5/8"	15/16"	2640
SP150053	3/16"	5/8"	1 7/16"	2640



**SAFETY SHACKLE WITH 1/2 TURN CAPTIVE PIN**

Part #	Pin Dia.	Width	Length	Max Ld#
SP185205	3/16"	1/2"	1"	2640
SP180005	3/16"	5/8"	1 7/16"	2640
SP180006	1/4"	7/8"	1 5/8"	4400



**TWIST SHACKLE WITH 1/2 TURN PIN**

Part #	Pin Dia.	Width	Length	Max Ld#
SP170005	3/16"	1/2"	7/8"	2640
SP170006	1/4"	9/16"	1 3/8"	4400



**FAST SHACKLE**

Avibank ball lock pin permanently wired to the shackle so it won't drop in the drink when released.

3062 Each

2101



2102

**SHOCKCORD SNAP HOOKS**

Easy to install shockcord snap hook. No tools required. Reusable!

- 2101 Hook-1/4"
- 2102 Hook-5/16"



**SUPER LOW STRETCH LINE**

Pre-stretched polyester line with superior fatigue and abrasion resistance. Our line (3/16"-3/8") tested as the lowest stretch (.5%) of any all polyester line available. Sold per foot.

- RH112WHT 1/12" White
- RH018WHT 1/8" White
- RH316WHT 3/16" White
- RH014WHT 1/4" White
- RH516WHT 5/16" White
- RH038WHT 3/8" White



WHT



BLU



RED



BLK

**SPUN DACRON**

Soft matte finish rope. Runs well thru blocks and fairleads, has good abrasion resistance, is spliceable and easy to hold with wet hands. Available in white, black, red, blue. This rope is not designed for winching. Sold per foot. Specify color choice.

(White, Blue, Red or Black xxx = color)

- RM014WHT 1/4" White
- RM014XXX 1/4" Color
- RM516WHT 5/16" White
- RM516XXX 5/16" Color
- RM038WHT 3/8" White
- RM038XXX 3/8" Color
- RM716WHT 7/16" White
- RM716XXX 7/16" Color

**SPECTRA**

Rudder Steering and Up / Down control line .  
81023001 Spectra 1.75 MM



**HARKEN 16MM AIR BLOCKS**

Harken's newest small blocks for control lines. Accepts up to 7/32" line, 900 pound load, 5/8" sheave diameter. Ultra light weight.

- H404 Single
- H405 Single w/Becket
- H406 Double
- H407 Double w/Bckt

H082



H083



H092



H166



H167



**HARKEN BULLET BLOCKS**

Medium size blocks that work well for control lines. Accepts up to 5/16" line, 2000 pound load, 1 1/8" diameter sheave.

- H082 Single
- H083 Single /Becket
- H092 Cheek
- H166 Single w/Swivel
- H167 Single w/Swivel & Becket



H224



H233



H225

**HARKEN MICRO BLOCKS**

Small blocks with high load capabilities, but light weight. Accepts up to 1/4" line, 1200 pound load, 7/8" diameter sheave.

- H224 Single
- H225 Single w/Becket
- H233 Cheek



**REMOVABLE SHEAVE BLOCK**

Simply remove the clevis pin that acts as the sheave axle, slide the sheave out of the frame, place the frame through the fitting and reinstall the sheave.

3103 Each



**SUPER STRETCH SHOCKCORD**

This midnight-black shockcord has double the stretch of ordinary cord. If you've been getting your shockcord from the hardware store, you're in for a treat. The durable black cover is woven around an extra-flexible rubber core.

- RS018BLK 1/8"
- RS316BLK 3/16"
- RS014BLK 1/4"
- RS516BLK 5/16"
- RS038BLK 3/8"
- RS716BLK 7/16"

- 53180011 3/8" Hog ring
- 21180000 1/2" Hog ring



**ONE WRAP VELCRO®**  
Cut this double faced Velcro® product to length and wrap it around items, line or whatever you need to secure. One side is hook and the other a loop, so a single piece is all you need.  
**7904** One Wrap, per foot

## CLEATS



**HARKEN  
CAMMATIC  
CLEAT**

Rounded jaws assure quick cleating/release action and smoother teeth mean longer life for your lines.  
**H471** Micro Cleat, Carbo Jaw  
1/8" to 1/4" line



## HARKEN WEDGES

Fairleads and eyestraps designed specifically for each Cammatic, the wedges put the Cammatic on a 15 degree angle for ease of cleating or releasing. The fairleads are molded into a replacement base. The eyestraps are designed to be held in place over the cam by the mounting screws.  
**H297** Wedge Kit  
**H284** Wire Fairlead  
**H281** Eye Strap



**SILICONE SPRAY**  
Dry silicone spray for sail luffs, cleats and bearings.  
**5106** Silicone 11.5oz



**MAGICA RUST REMOVER**  
Easily clean rust stains from fiberglass, plastic surfaces, metal parts or fabrics. Although metal parts are made from high quality stainless steel, machining tools often leave carbon particles imbedded in the metal surfaces. This material can bleed a rust stain onto other surfaces. Magica simply dissolves the rust away.  
**1603** MAGICA GEL 8 oz. Bottle



**CLEAR SILICONE SEALER**  
Make sure your hulls are watertight! Clear Silicone seals leaks around all thru-hull fittings.  
**376** 1.5 oz. Tube



**TWO PART EPOXY PUTTY**  
Simple to use putty-like repair epoxy. Quick and easy, it works fast to patch up small dings and scratches in fiberglass or plastic parts. Just mix, let dry, sand lightly and you are ready to go.  
**82300001** 1 Pound



**AQUASEAL MIRAZYME  
ODOR ELIMINATOR**  
There's nothing quite like the odor of damp gear left in your car trunk for a couple of days. With one application eliminate those odors from booties, wet-suits, dry-suits and the rest of your gear. A 100% biodegradable product made from a blend of 10 highly specialized, light activated microbial elements. Works by penetrating into pores of fabric, rubber and even hard surfaces to eliminate odor naturally.  
**7003** 8oz.

## HOBIE BOAT CLEANER & UV PROTECTANT SYSTEM: CLEAN AND THEN PROTECT!



**HOBIE BOAT CLEANER - 10oz**  
Formulated with "Green Chemistry" to safely remove dirt and stains from Hobie products. Good on fiberglass, polyethylene, Vinyl (trampolines) and PVC (inflatable). Cleans the most stubborn stains off of hulls.  
**70050001** HOBIE BOAT CLEANER - 10oz

**HOBIE UV PROTECTANT - 10oz**  
Protect and rejuvenate fiberglass, polyethylene, vinyl and PVC materials. Spray on, the protectant absorbs into the material and leaves a UV protective layer. Reduce the loss of essential oils and deflect the sun's harmful UV rays.  
**70060001** HOBIE UV PROTECTANT - 10oz



**TEAR-AID**  
Each TEAR-AID® repair patch is made from an exceptionally tough, matte finish, abrasion resistant, elastomer that resists puncture and tearing. It is combined with an aggressive adhesive formulated for high bond strength to a variety of surfaces such as canvas, leather, rubber, nylon, most plastics, paints, aluminum, stainless steel, fiberglass, polyurethane, polyethylene, polypropylene, vinyl and vinyl coated. TEAR-AID® Type A and TEAR-AID® Type B provide a simple and easy method of patching holes and tears, as well as an excellent protective film solution.  
**72020030** TEAR-AID / TYPE A (POLY)  
**72020031** TEAR-AID / TYPE B (VINYL)

**EACH PATCH KIT CONTAINS:** (1) 3" x 12" TEAR-AID® Patch that cuts with scissors to any size, (1) 7/8" x 7/8" Patch, (1) 1 3/8" x 1 3/8" Patch, (1) 12" Reinforcement Filament for repairing tears at edges, (2) Alcohol Prep Pads, (1) Illustrated Instructions and a Product Repair List.

# Serious Fishing



Powered by Hobie's patented MirageDrive® pedal system, the **Hobie Mirage Outback** leaves your hands free for job one—fishing. A wide hull provides form stability, allowing you to cast or reel in the big one—without rocking the boat.

- Large covered bow hatch
- Two 8" Twist and Seal hatches
- Four molded-in rod holders
- Utility trays
- Adjustable high-back padded seat with inflatable lumbar support
- Mesh-covered stowage pocket
- Rear cargo area with Bungee® tie-downs
- Options: Bimini, Dodger, Hobie eVolve™ powered by Torqeedo electric motor kit, plug-in cart, sail package

POWERED BY



**HOBIE**  
MirageDrive®



[hobiefishing.com](http://hobiefishing.com)

# HOBIE KAYAK SUPPORT / ONLINE SUPPORT - FAQs - FORUMS

For technical help, contact your dealer, see the Hobie website support area or visit our Hobie kayak user forums.

Our on-line support area and forums include FAQs with many technical and user topics.

Hobie Cat Company [hobiekat.com](http://hobiekat.com) / Hobie Australasia [hobiecat.com.au](http://hobiecat.com.au) / Hobie Kayak Europe [hobie-kayak.com](http://hobie-kayak.com)

## HOBIE KAYAK FAQ

**How watertight is my boat?** It is normal for any type of kayak to experience a small amount of seepage due to the installation of rivets, hatches, etc. Kayaks may take on a few cups of water while out paddling. If a kayak is taking on more than a small amount of water, check to make sure the drain plug is in, then check the rest of the boat for leaks. Silicone can be used to seal the rivets. If you have any questions, please call your dealer.

**How should I store my kayak?** It is best to store your kayak upside down or standing on end. If hanging your kayak, do not support from the handles. Best supported by wide webbing straps with the kayak upside down or on its side.

**Is my boat repairable?** Hobie kayaks are very durable, however, on occasion they may need some minor repairs. Linear polyethylene is repairable. Check with your dealer concerning repairs for your kayak.

**Is my boat recyclable?** Hobie will recycle your boat when you are done with it. To recycle a Hobie Kayak, it must be cut up so it fits in a box with the following dimensions: may not exceed 130" for the length plus girth, and maximum 108" for the length. Ship the boat to: Hobie Cat 4925 Oceanside Blvd. Oceanside, CA 92056. It is our hope that no Hobie Kayak will ever end up in a landfill!

## HOBIE CAT PARTS - WARRANTY POLICY

**HOBIE PARTS WARRANTY** Hobie Cat warrants all Hobie Cat manufactured parts and accessories against failure due to materials or workmanship defects for a period of one year.

**OTHER WARRANTY** Any accessories and other merchandise sold by Hobie Cat not mentioned in the paragraph above are not warranted by Hobie Cat. Said accessories and other merchandise may be covered by the manufacturer's warranty, a copy of which can be furnished by Hobie Cat upon written request.

**HOBIE CAT'S OBLIGATION** Hobie Cat at its option will repair or replace without charge any part or accessory which is found to be defective under the terms and within the period of this Warranty. Buyer must return the accessory with a sales slip as proof of purchase date.

**BUYER'S OBLIGATION** Upon discovery of a suspected defect, Buyer must-at his/her own expense-promptly return the equipment to the Hobie Kayak dealer for inspection. Warranty is void if equipment is operated after a suspected defect is,

or should have been, discovered.

**WHO IS ENTITLED TO WARRANTY** Only the original Buyer of the equipment and accessories from Hobie Cat is entitled to warranty. Warranty may not be transferred.

**NO WARRANTY OF USED EQUIPMENT** Used equipment is sold AS IS; Hobie Cat makes NO WARRANTY concerning its merchantability, condition, durability, age or model year, or fitness for any purpose whatsoever.

**MUTUAL AGREEMENTS** It is agreed that this warranty sets forth Buyer's exclusive right and remedy against Hobie Cat with respect to the equipment and accessories. It is in lieu of all other express warranties and all implied warranties, including implied warranties of merchantability and fitness. Hobie Cat assumes no other like or unlike liability for loss of cargo, use, profit or consequential damages of any kind in connection with the sale, alteration, use, repair or replacement of equipment or any part thereof.

## LIVEWELL PARTS

- 72021001 BATTERY
- 72021002 BATTERY CHARGER
- 72021003 SWITCH
- 72021004 INTAKE TUBE ASSY
- 72021005 STRAP SET
- 72021006 BATTERY LID
- 72021007 PUMP CONNECTOR FEMALE
- 72021008 PUMP CONNECTOR MALE
- 72021009 DOWNSPOUT FITTING
- 72021010 INTAKE 90 DEGREE
- 72020015 ROD HOLDER - LIVEWELL
- 72021020 DOWNSPOUT TUBE
- 72021021 TERMINAL COVER
- 72021022 ATTWOOD PUMP
- 72021023 7" INTAKE TUBE (PRO A)
- 72021025 ELEC CONNECTOR REPL SET
- 79050211 DRAIN PLUG

72021025



72021001



72021002



72021003



72021004



72021005



72021006



72021007



72021008



72021009



72021010



72020015



72021020



72021021



72021022

# HOBIE KAYAK - COMMON PARTS

See model specific pages for model-specific parts

## TECH TIP!

**DECK FASTENERS** Customize your boat with the fasteners of your choice... where you want them. The Hobie screw-in fittings can be easily removed and replaced. Add an extra eye where we placed a hook, a cleat hook where a shockcord end is placed... You choose what works best for you. Use tool #71115101

### SCREW-IN FITTINGS



71116001  
Padeye



71117001  
CLEAT



71115001  
Shockcord end



71115101  
TOOL SCREW in FITTINGS



10092030 PLUG  
SEAT AREA OF  
ADVENTURE, KONA,  
OUTFITTER, REVOLUTION



79050211 DRAIN PLUG  
79050212 O-RING

71230001 ROD HOLDER COVER  
8031130 SCREW



88991355 KNOB ASSY  
(Handle Not Included)

81013001 STEERING HANDLE  
8030126 SCREW  
88991152 STICKER  
81385001 WASHER  
88991235 PIN  
H071 SPRING



### STEERING CRANKS

81014001 SPORT  
81016001 REV / OB  
81017001 OUTF / OASIS  
88991281 CRANK - AI 2011+/TI

### OLDER STEERING



81015001 - STEERING  
HANDLE W/ SET-SCREW

81370001 - CRANK  
81372001 - CRANK AI-OUTFIT  
H071 SPRING  
8080691 NYLON WASHER



SEE RUDDER PAGE 39  
FOR RUDDER SYSTEM DETAILS

81394001  
OLDER RUDDER PIN

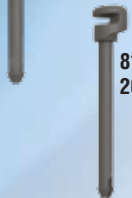

81394021 RUDDER PIN  
2011+ CENTERLINE STYLE



10091000 DRAIN PLUG

80020001 RUDDER LINE  
REPLACEMENT KIT UNIVERSAL



41220001 EYELET POST  
8031131 SCREW



81392001 TWIST AND STOW CONTROL ARM UP/DOWN  
81380001 OLDER - CONTROL ARM UP/DOWN  
81375001 SPRING  
8080691 NYLON WASHER  
81035011 BOLTED HANDLE AND CONTROL ARM KIT



81035001 UP / DOWN  
HANDLE W/ SET-SCREW



81023001 SPECTRA CONTROL LINE  
8063001 SWEDGE  
81400001 TUBING  
81405001 TUBE HOLDER  
81405101 END CAP

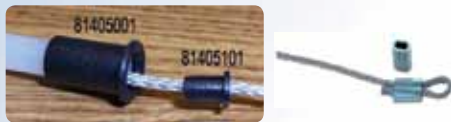

RS316BLK 3/16" Shockcord  
RS014BLK 1/4" Shockcord  
79538201 WEB PULL TAB



53180011 3/8" Hog ring  
21180000 1/2" Hog ring



71110001 PADEYE  
8030031 SCREW  
8012001 RIVET



71120001 LASHING HOOK  
8030031 SCREW



78510001 Bungee hook  
8031961 SCREW



78520001 Eyelet hold down  
8032121 SCREW



2101 -SHOCKCORD  
FASTENER, 1/4"



72402001 SEATBACK / PADDLE MODELS 2010  
72409001 SEAT STRAP W/HOOK

### SEAT



81265101 SEATBACK  
ADJUSTABLE PLUG KIT (PR)

81265001 SEATBACK PLUG  
8031130 SCREW  
8080541 WASHER





2008 AND OLDER  
81410001 CAM LOCK KNOB  
BOLTS VARY BY MODEL



81535001 Mirage Cassette  
plug



74075001 PADDLE 2 PC FIBER SHAFT  
74010001 BLADE RIGHT  
74011001 BLADE LEFT  
74076101 BUTTON  
230cm  
74030002 DRIP RING FG SHAFT  
74030001 DRIP RING ALUM SHAFT



81611101 CLICK AND GO ASSY (L)  
81611201 CLICK AND GO ASSY (R)  
8030791 SCREW  
(REQUIRES 3/16" ALLEN "BALL-END" WRENCH)  
81602101 SPRING CLICK AND GO LEFT  
81602201 SPRING CLICK AND GO RIGHT



72103001 SHOCKCORD END  
8031130 SCREW

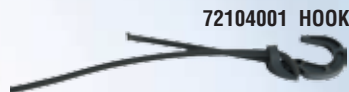

72104001 HOOK  
80012001 Pedal retainer  
bungee W/Hook



74049001 PADDLE "T" HANDLE



10730000 Cleat  
8030111 Screw



78560001 Mesh STOWAGE pocket  
8031501 Screw

8031570 SCREW /  
PADDLE KEEPER BUNGEE  
79538201 WEB PULL TAB

38120031 PUSH-IN CAP (WHITE)  
(UNDERSIDE OF HULL)



SEE MIRAGEDRIVE PAGE 38-39  
FOR DRIVE DETAILS

71301001 HATCH SEAL "TRIM-LOC"  
(TOP MOLDED) 5" REQ (BY FOOT)



76050001 BOW/ STERN  
HANDLE



71220001 METAL PAD EYE  
8030071 SCREW



10730021 CLEAT STBD  
10730031 CLEAT PORT  
8031590 SCREW



84550001 MAST RECEIVER  
84560001 MAST TUBE COVER  
8031151 SCREW



72012001 - SCUPPER  
PLUG QUEST / KONA / OUTBACK



72009001 - SCUPPER PLUG  
PURSUIT/ MAUI/ LANAI



72010 -SCUPPER PLUG  
ODYSSEY



76055001 Midship handle  
8032011 Screw



81408101 HANDLE  
81406101 INSERT - UP  
81407101 INSERT - DOWN



88991061 Midship Handle  
8032011 Screw



81408001 OLDER HANDLE  
81406001 OLDER DECAL - UP  
81407001 OLDER DECAL - DOWN



71190001 Webbing lift handle  
8032011 Screw  
8080571 Washer

8004531 LINE (BLK)  
81450001 UP / DOWN BLOCK  
8031065 10-32 X 7/8 SCREW  
8031069 10-32 X 1-1/4 SCREW (AI)  
8050211 NUT

## HATCHES



71702011 Hatch 8" Twist and Seal  
71702001 Hatch 8" Twist and Seal RETRO KIT  
71331001 FLANGE Gasket / 71702021 LID O-RING  
8031130 Screw

71701011 Hatch 6" Twist and Seal  
71701001 Hatch 6" Twist and Seal RETRO KIT  
71321001 FLANGE Gasket / 71701021 LID O-RING  
8031130 Screw

71130001  
Hatch 5" screw-in  
8031130 Screw

# HOBIE MIRAGEDRIVE V2

WHAT MAKES A V2 Drive? V2 Drums, V2 Chains, V2 Idler Cable and V2 (Threaded) masts / sprockets  
(USED IN 2009 PRODUCTION AND NEWER)

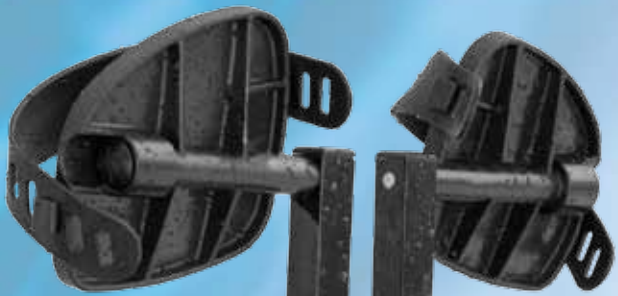

72020034 PEDAL PAD KIT



81172001 PEDAL ADJUSTMENT DECAL

81236001 PEDAL ADJ ASSY

INCLUDES:

- 81240001 PLASTIC HANDLE
- 81230001 PIN
- 8031201 SCREW
- 81242001 SPRING
- 8034071 ALLEN WRENCH

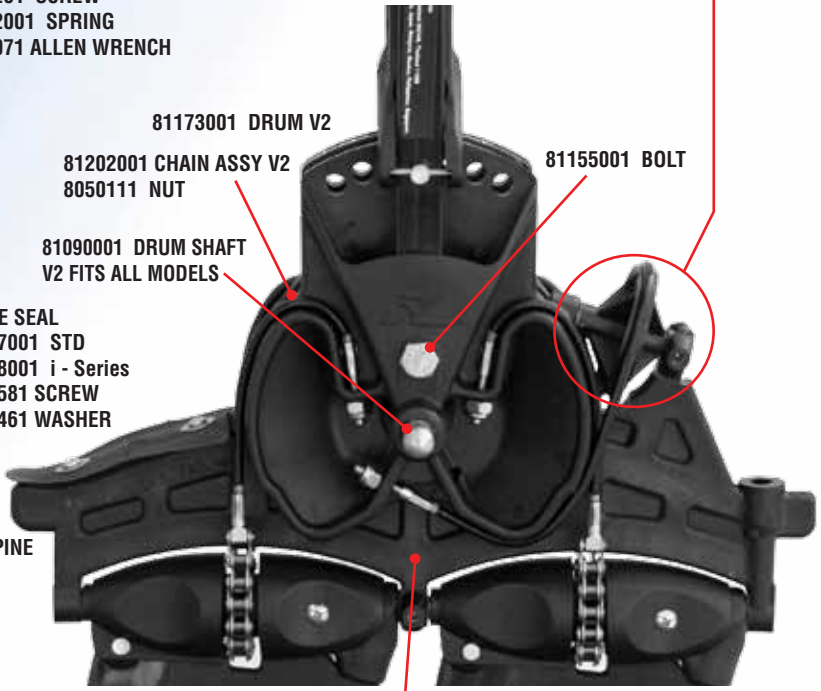
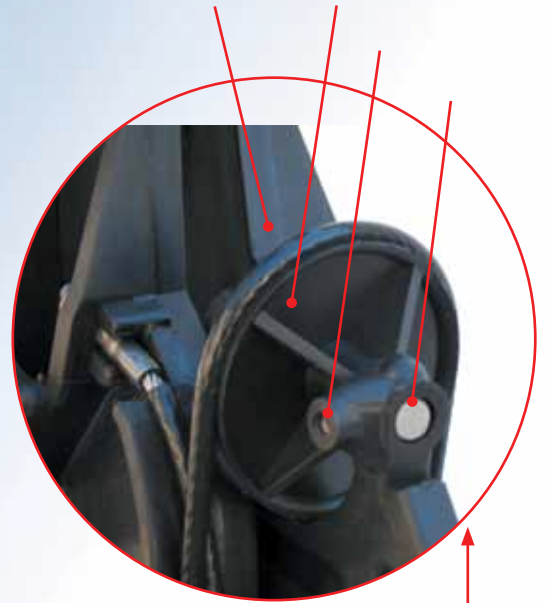

81173001 DRUM V2

81202001 CHAIN ASSY V2  
8050111 NUT

81155001 BOLT

81090001 DRUM SHAFT  
V2 FITS ALL MODELS

- DRIVE SEAL
- 81037001 STD
  - 81038001 i - Series
  - 8031581 SCREW
  - 8080461 WASHER

81181001 SPINE

81095001 DRIVE ALIGNMENT PIN 2012+

81080001 SPROCKET SHAFT  
53170020 SET SCREW

- 81050001 OUTHAUL BLOCK
- 8020041 CLEVIS PIN
- 10860001 LOCK RING

81055001 SPROCKET GUARD FWD  
8031451 SCREW



81129001 SPROCKET  
V2 THREADED  
W/ FWD GUARD

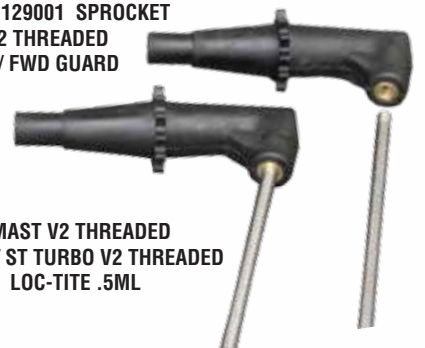

81163001 MAST V2 THREADED  
81198101 MAST / ST TURBO V2 THREADED  
8000341 LOC-TITE .5ML

81190001 STANDARD FIN  
81193001 ST FIN  
81192001 ST TURBO FIN

V2 SPROCKET UPDATE KIT  
(2 V2 SPROCKETS AND 2 V2 MASTS)  
81129022 V2 STANDARD MAST KIT  
81129122 V2 TURBO MAST KIT



# HOBIE MIRAGEDRIVE "V1"

Drive with older plastic drum, plastic spine, Sprocket / mast connection is a set-screw



# HOBIE MIRAGEDRIVE OLDER

Original drive with aluminum spine, stainless sprocket / mast connection is cotter key.

- 81130001 SPROCKET (STAINLESS)
- 81340001 SPROCKET BUSHING (SS SPKT)
- 81420001 SPROCKET GUARD
- 8060111 COTTER KEY (MAST / SS SPKT)
- 81040001 OUTHAUL BLOCK (SS SPKT)
- 8020061 CLEVIS PIN
- 10860001 LOCK RING
- 81211001 IDLER CABLE 14 3/4" (SOLID PULLEY)
- 81150001 DRUM BUSHING (ALUM DRUM)
- 81105001 CRANK ARM RIGHT, THREADED
- 81100001 CRANK ARM LEFT, THREADED

## RUDDER SYSTEMS

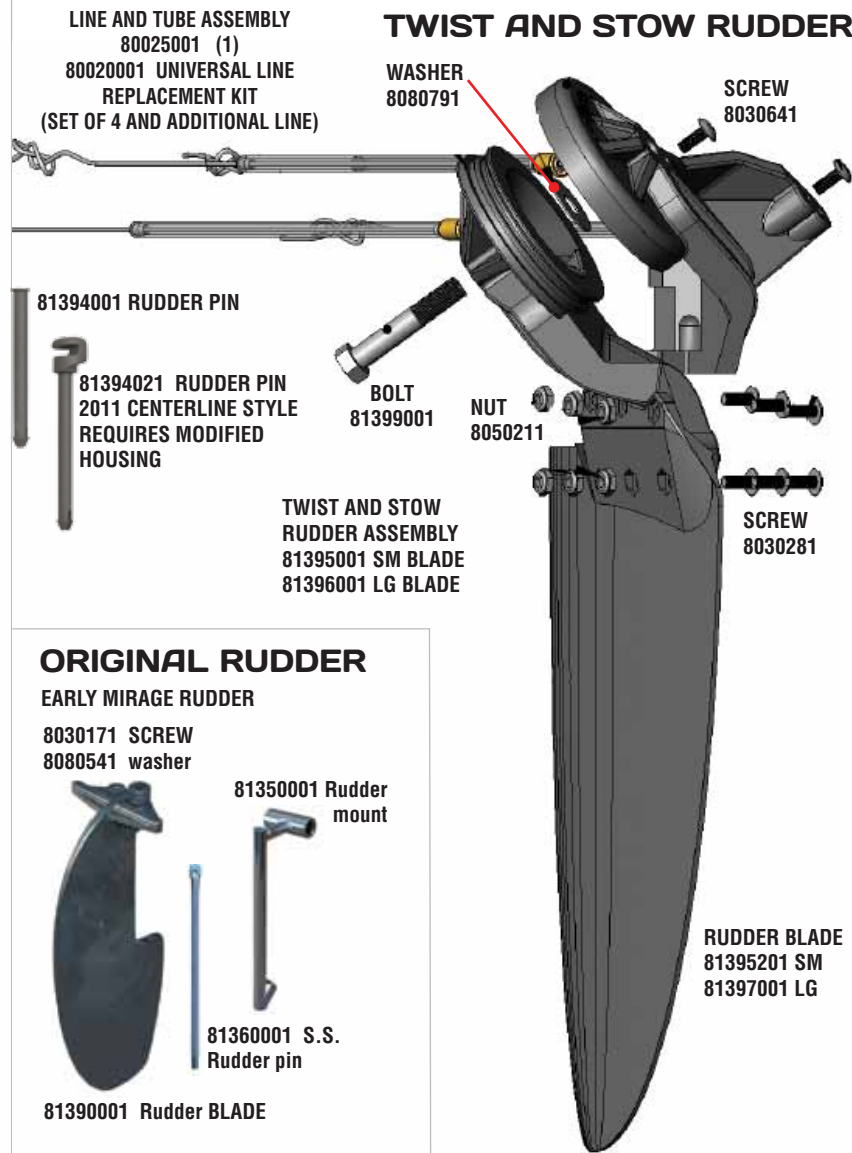

## ORIGINAL RUDDER

### EARLY MIRAGE RUDDER

- 8030171 SCREW
- 8080541 washer



81390001 Rudder BLADE

## MIRAGEDRIVE SPARE PARTS KITS

Spare parts kits include a spare fin, mast, sprocket, chain, clevis pin and ring. All in a handy zippered pouch. Available for the standard fin drives or drives with ST Turbo fins. Standard kit shown.

## MIRAGEDRIVE V2 (THREADED MAST STYLE)

Includes parts listed above for V2 "threaded mast" drives.

- 80010301 KIT V2 Standard FIN
- 80013301 KIT V2 Turbo FIN

## MIRAGEDRIVE OLDER (SET SCREW MAST STYLE)

Includes parts listed above plus: Set screw, allen wrench, and a cotter key.

- 80010201 KIT Standard FINS
- 80013201 KIT Turbo FINS

## TECH TIP

**MAINTENANCE AND TUNING** - Maintenance and tuning information for MirageDrives and Twist and Stow rudder systems is available on the Hobie Cat website support area. [www.hobiecat.com/support](http://www.hobiecat.com/support)

Direct link to the support pages for kayaks is here: [www.hobiecat.com/support/index-kayak.html](http://www.hobiecat.com/support/index-kayak.html)

# HOBIE MIRAGE SERIES

MIRAGE SPORT



81362001 Rudder pin, OLDER SPORT  
20860000 Lock ring

RUDDER LINE  
REPLACEMENT KIT  
80020001

81362001 Rudder pin, OLDER OUTBACK  
20860000 Lock ring

## MIRAGE OUTBACK

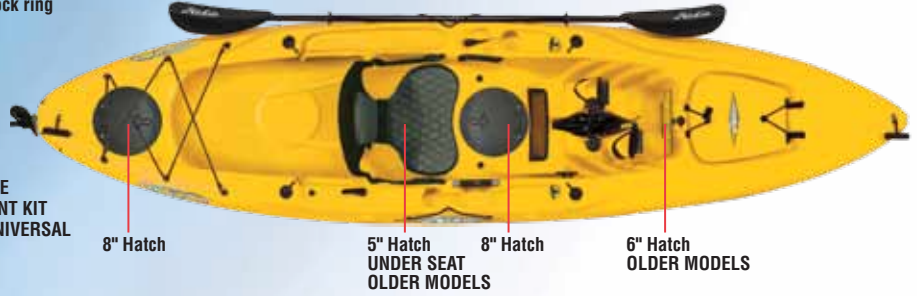

RUDDER LINE  
REPLACEMENT KIT  
80020001 UNIVERSAL

80020001  
RUDDER LINE REPLACEMENT  
KIT UNIVERSAL

## MIRAGE OUTFITTER

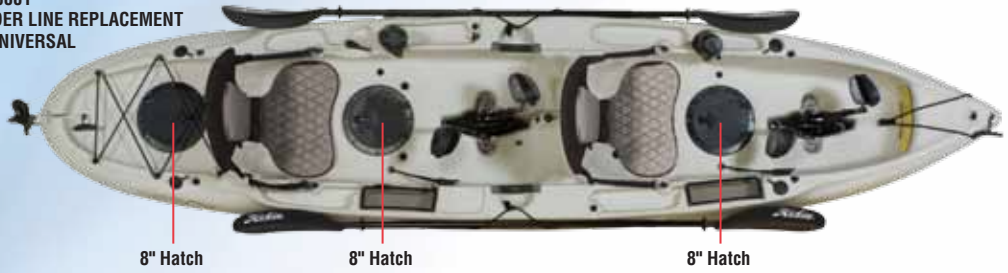

81361001 RUDDER PIN, CLASSIC  
20860000 LOCK RING

## MIRAGE CLASSIC



91281000 DRAIN SCREW

MIRAGE CLASSIC & PURSUIT  
71201 - CARGO COVER  
71301001 - LOC SEAL, 6.5FT

## MIRAGE REVOLUTION®



### WATER BOTTLE GUIDE

71999011 SMALL BOTTLE 16OZ  
SPORT/OUTBACK/QUEST/KONA

71997001 MEDIUM BOTTLE 20OZ  
ODYSSEY/LANAI/MAUI

71998001 LARGE BOTTLE 32OZ  
REVOLUTION/ADVENTURE/ADVENTURE  
ISLAND/OUTFITTER/OASIS

## MIRAGE OASIS®



RUDDER LINE  
REPLACEMENT KIT  
80020001

81362001 RUDDER PIN, OLDER TANDEM  
20860000 LOCK RING

## MIRAGE ADVENTURE

79050211 NEWER DRAIN PLUG

80020001  
RUDDER LINE  
REPLACEMENT KIT

71301001 HATCH SEAL "TRIM-LOC"  
(TOP MOLDED) 5' REQ

71302001 HULL FLANGE SEAL (PRE 2012)  
"TRIM-LOC" (SIDE GLUED) 5' REQ

MODEL SPECIFIC PARTS

# HOBIE PADDLE SERIES



LANAI / MAUI

MAUI  
6" Hatch

LANAI  
6" Hatch

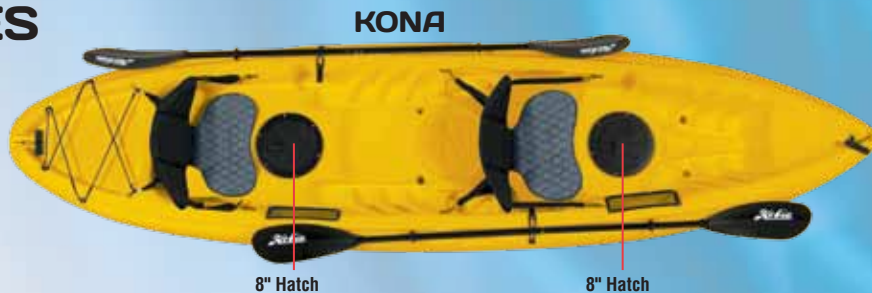

KONA

8" Hatch

8" Hatch

QUEST RUDDER SYSTEM  
78501 TWIST and STOW RUDDER KIT  
78551001 rudder mount TnS  
8032011 rudder screws



QUEST

8" Hatch

37380001 CLAM CLEAT



61070000 Cleat  
8031130 Screw

78540001 TRACK / FOOT BRACE  
78535001 FOOT BRACE / LEFT  
78536001 FOOT brace / right

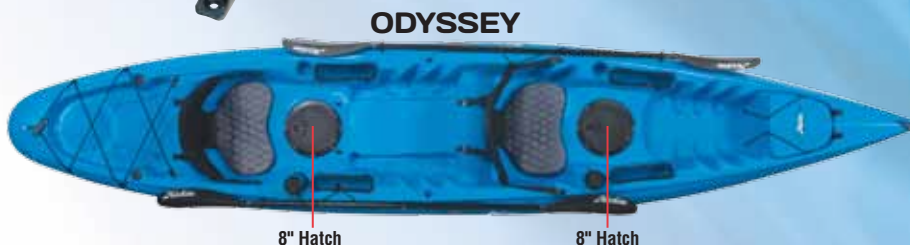

ODYSSEY

8" Hatch

8" Hatch

# HOBIE MIRAGE i - SERIES

79052007 Seatback / i-SERIES

79050061 I-series Cassette plug  
79050021 CLICK and GO SPRING

71702011 Hatch 8" Twist and Seal  
71331001 FLANGE Gasket / 71702021 LID O-RING  
8031130 Screw

79052017 VALVE ASSY

81394001 Rudder pin  
81395201 SMALL rudder blade  
81395001 rudder assy. w/ sm. blade



76050001  
Bow/ Stern handle

79050211 DRAIN PLUG

79052019 paddle HOLDER

74077001 paddle 4 PC aluminum shaft

80012001 Pedal retainer bungee W/Hook



79052000



79052006



79052001



79052015 and 16



79052009

## 79052000 i - ACCESSORY HOLDER KIT

Designed to allow the attachment of rod holders and other accessories to the Hobie Mirage inflatable kayaks. The accessory kit comes with 2 mount plates and attachment glue. 4 hole pattern fits Scotty mount and RAM / Scotty hole pattern products. Mount the 80052001 Scotty Deck/Side mount and Scotty rod holders or adapt for the RAM products by adding 72023004 RAM Ball Scotty adapter. (1/4-20 Screws sold separately, check length for desired accessory / #8030380 7/8" length for Scotty deck mount).

## 79052006 i - HARDWARE ACCESSORY KIT

Includes padeyes, spare cleats and glue. Customize your Hobie inflatable.

## 79052001 i - CUP HOLDER KIT

Includes 2 flexible can / cup holders and glue. Customize your Hobie inflatable.

## 80045101 i - KAYAK CART "PLUG-IN"

## 79052015 i - TRI RING KIT / SAGE

## 79052016 i - TRI RING KIT / SUNDANCE

Includes 2 "Tri" rings mounted on round patches ready for installation. Customize.

## 79052009 i - HULL REPAIR KIT

Includes 2 colors of repair vinyl and glue, valve tool and instructions. Repair or customize a Hobie Mirage Inflatable kayak.

## 79052005 i - ELECTRIC INFLATION PUMP

Electric pump connects to car 12v outlet. Quickly and easily fill your Hobie inflatable. This is a high volume / low pressure pump. Use the standard pump to bring chambers to full pressure.

## 79052003 i - STANDARD INFLATION PUMP

Standard hand pump for Hobie inflatable.

## 79052010 i - 12 TRAVEL BAG

## 79052011 i - 14 TRAVEL BAG

## 79052012 i - 9 TRAVEL BAG

# ADVENTURE ISLAND

79510001 '07 MAST ISLAND (2 PC)  
79510011 '08 MAST ISLAND (2 PC)  
79511021 MAST SWIVEL TIP

'07 BASE COLLAR KIT



79512001 FURLER DRUM AI  
79511001 '07 MAST BASE / PIN  
79511101 '08 MAST BASE / HOLE  
79510101 MAST BASE COLLAR KIT

79509001 SAIL GRAY/WHT  
79516001 SAIL PAPAYA/TURQ/WHT  
79515001 SAIL RED/GRAY/WHT

91051011 BATTEN 9' 2"  
91041011 BATTEN 7' 8.5"  
91011001 BATTEN CAP  
22080011 BATTEN LUFF CAP SET

79531001 XBAR FWD ASSY  
8030781 SOC CAP SCREW

79520001 AKA FWD (L/R)

79535001 AKA CONNECTOR PIN  
RS316BLK 3/16" SHOCK CORD (9")  
53180011 HOG RING



71190001 LIFT HANDLE  
8032011 SCREW  
8080571 WASHER

79545001 AMA "HOBIE" DOME LOGO

88991355 2011 STEER KNOB ASSY

79538101 PADDLE HOLDER KIT  
79538001 PADDLE RETAINER CLIP

79521001 AKA LEFT REAR

2011 MODEL AI (V2) XBAR / AKAS  
79512201 AKA AI V2 - RT FWD  
79512301 AKA AI V2 - LT FWD  
79512401 AKA AI V2 - LT REAR  
79512501 AKA AI V2 - RT REAR  
79512601 XBAR AI V2 - FWD  
79512701 XBAR AI V2 - REAR

38670011 "S" HOOK

H082 BULLET BLOCK

H083 BULLET BLOCK W/BECKET



79526001 AKA CARRY BAG



79510201 MAST / SAIL BAG



79533001 MAST BEARING PLATE (REQ 2)  
8031231 SCREW  
8050801 NUT  
90610111 BEARINGS (EA / REQ 24)  
79532001 MAST RETAINER SPRING  
8004381 (12') FURLING LINE

H233 CHEEK BLOCK  
8030150 SCREW  
8080500 WASHER  
8050211 NYLOCK NUT

H424B FAIRLEAD  
H471 CLEAT

8031481 SCREW  
79531101 CLEAT WEDGE WITH FAIRLEAD  
79531111 MAIN CLEAT WEDGE  
RMO14BLK MAINSHEET (32')

79501001 FOAM PLUG /  
DAGGER WELL



79502001  
DAGGER BOARD

79525001 BALL / BRACE  
8030212 SCREW

79522001 AKA RIGHT REAR

79537001 BRACE RETAINER CLIP

79530001 XBAR REAR ASSY  
8030781 SOC CAP SCREW

79523101 AKA BRACE ASSY V1 (L)  
79523102 AKA BRACE ASSY V1 (R)

79523201 AKA BRACE ASSY - V2 (L)  
79523202 AKA BRACE ASSY - V2 (R)

79524001 CAP / AKA BRACE LOCK  
79523001 SOCKET / AKA BRACE LOCK  
81242001 SPRING / AKA BRACE LOCK  
8030781 SOC CAP SCREW

10091000 DRAIN PLUG

79050211 DRAIN PLUG  
79050212 O-RING

81396001 TWIST AND STOW RUDDER ASSY / LG BLADE  
81397001 LARGE SAILING RUDDER BLADE  
81394001 RUDDER PIN  
81394021 RUDDER PIN 2011 CENTERLINE STYLE  
2011 MODEL YEAR RUDDER UPDATED SPRING 2011  
CONTACT DEALER FOR RUDDER DETAILS

79514001 '07 MAST RECEIVER  
79514101 '08 MAST RECEIVER  
8030261 SCREW  
8080211 WASHER  
71320001 GASKET

79513001 BACKUP RING

88991215 SET SCREW

79517001 V-FRAME STRUT

79519001 V-FRAME  
TURNBUCKLE



79518001  
V-FRAME BASE



71116001 EYE



71115001 END FITTING  
RS014BLK SHOCK CORD (1')



41220001 EYELET POST  
8031130 SCREW



79520201 AKA COLLAR  
8010181 RIVET



79520301 AKA END CAP

99303001 AMA PAPAYA  
99304001 AMA HIBISCUS  
99305001 AMA DUNE



10091000 DRAIN PLUG

79050211 DRAIN PLUG  
79050212 O-RING

8032081 SHEAR BOLT  
8052081 NUT  
79536001 BRACE CONNECTOR  
8020381 CLEVIS PIN  
20860000 SPLIT RING

81391002 RUDDER UP/DOWN LINE KIT

80020001 RUDDER LINE  
REPLACEMENT KIT UNIVERSAL

# TANDEM ISLAND

88991121 MAST TANDEM ISLAND (2 PC)  
88991311 MAST TIP  
88991071 FURLER DRUM TI  
79511101 MAST BASE

88998514 SAIL DUNE  
88998515 SAIL SMOKE  
88998516 SAIL BREEZE

88998521 BATTEN #1 (3/8" 186")  
88999519 BATTEN CAP 3/8"  
88998522 BATTEN #2 (3/16" 42 1/2")  
88998523 BATTEN #3 (3/16" 39 1/2")  
91011001 BATTEN CAP 3/16"

22080011 BATTEN LUFF CAP SET

79520311 AKA FWD (L)

79531201 XBAR FWD ASSY  
8030451 SCREW (CUP ATTACH)  
8050111 NUT (CUP ATTACH)

71190001 AMA LIFT HANDLE  
8032011 SCREW  
8080571 WASHER  
79545001 AMA "HOBIE" DOME LOGO

88991061 HULL LIFT HANDLE  
8032011 SCREW

88991301 STEERING HANDLE  
88991235 ROLL PIN  
8030125 SCREW  
88991151 STICKER  
88991355 (2011) STEER KNOB ASSY

79530201 XBAR REAR ASSY

79520401 AKA LEFT REAR

79538101 PADDLE HOLDER KIT  
79538001 PADDLE RETAINER CLIP

79050211 DRAIN PLUG  
79050212 O-RING

79526002 AKA CARRY BAG

79510202 MAST / SAIL BAG

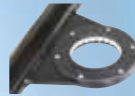

79533001 MAST BEARING PLATE (REQ 2)  
8031231 SCREW  
8050801 NUT  
90610111 BEARINGS (EA / REQ 24)  
79532001 MAST RETAINER SPRING  
8004381 (12') FURLING LINE

H233 CHEEK BLOCK  
8030150 SCREW  
8080500 WASHER  
8050211 NYLOCK NUT  
79510721 XBAR CLAMP TOP  
79510731 XBAR CLAMP BOTTOM  
8032088 SCREW  
8080561 WASHER

79520211 AKA FWD (R)



H424B FAIRLEAD  
H471 CLEAT 8031481 SCREW  
79531101 CLEAT WEDGE / FAIRLEAD  
79531111 MAIN CLEAT WEDGE

88991101 CENTERBOARD  
88991021 CENTERBOARD PIN  
88991031 PIN HOLDER  
8031461 SCREW  
8030671 SCREW  
88991011 COVER  
8030071 SCREW (4)  
81242001 SPRING  
88991041 KNOB  
88991150 CAP

79520501 AKA RIGHT REAR

79537001 BRACE RETAINER CLIP

79525001 BALL / BRACE  
8030212 SCREW

MAINSHEET SYSTEM  
38670011 "S" HOOK  
H083 BLOCK-BULLET W/BECKET  
RM014BLK LINE (55')  
H2655 BLOCK, 40MM CARBO FIDDLE  
H2131 SHACKLE PIN 5/32"

RUDDER REPLACEMENT SPRING 2011 (88991098)  
CONTACT DEALER FOR REPLACEMENT RUDDER DETAILS IF YOU ARE USING TWIST AND STOW SYSTEM  
81051001 1,000 LB UP CONTROL LINE  
88991101 RUDDER PIN  
88991099 RUDDER UP STRAP ASSY

82420001 RUDDER COVER AI / TI

79050211 DRAIN PLUG  
79050212 O-RING



79514101 MAST RECEIVER  
8030261 SCREW  
8080211 WASHER  
71320001 GASKET  
79513001 BACKUP RING

8032011 STEP PLATE SCREW

88991191 V-FRAME STRUT

88991215 SET SCREW

88991201 V-FRAME TURNBUCKLE

8050111 NUT

88991201 V-FRAME BASE



71116001 EYE



71115001 END FITTING  
RS014BLK SHOCK CORD (1')



41220001 EYELET POST  
8031130 SCREW



79520201 AKA COLLAR  
8010181 RIVET



79520301 AKA END CAP

88991303 AMA PAPAYA  
88991304 AMA HIBISCUS  
88991305 AMA DUNE

88523101 AKA BRACE ASSY (L)  
88523102 AKA BRACE ASSY (R)



79524001 CAP / AKA BRACE LOCK  
79523001 SOCKET / AKA BRACE LOCK  
81242001 SPRING / AKA BRACE LOCK  
8030781 SOC CAP SCREW  
8032081 SHEAR BOLT  
8052081 NUT  
88536001 BRACE CONNECTOR  
8020381 CLEVIS PIN  
20860000 SPLIT RING

80020001 RUDDER LINE  
REPLACEMENT KIT UNIVERSAL

# PRO ANGLER

- ROD HOLDER STORAGE**  
 84500911 ROD HOLDER ASSY LEFT  
 84500921 ROD HOLDER ASSY RIGHT

- 84502001 MOUNTING BOARD, RT  
 84502101 MOUNTING BOARD, LT  
 8030341 SCREW  
 8032085 SCREW  
 8050111 NUT

- 84502401 FLOOR MAT RT  
 84502501 FLOOR MAT LT-BLK

- STEERING (PRO A) REVERSIBLE ASSY**  
 KIT INCLUDES ALL PARTS TO REPLICATE  
 2011 STEERING ON OLDER MODELS.  
 MOUNT ON PORT OR STARBOARD SIDES  
 84506201

- 84506001 STEERING ASSEMBLY  
 (INCLUDES HANDLE, TUBES AND LINE ASSEMBLED)

- 84501301 HANDLE  
 84501531 BALL  
 8030111 SCREW  
 WASHER

See Tension Knob

- 8030981 SCREW  
 8050211 NUT

- 81023001 SPECTRA  
 CONTROL LINE (14')

- 84501511 TENSION KNOB  
 84501521 RBR WASHER  
 8080551 WASHER  
 8050231 NUT  
 84502601 TENSION SCREW

- 84501401 HOUSING  
 8030981 SCREW (2)

- 84501601 TUBE CONNECTOR, STEERING

- 80074001 STEERING LINE TUBE (2)  
 8003171 BLK PVC TUBE COVER (26")  
 84501201 THRU HULL BARB CONNECTOR  
 81030001 ZIP TIE (BLK) (2)

- 84500601 COVER PLT, RDR SYSTEM  
 8031051 SCREW (4)  
 84500801 TUBE RESTRICTOR (2)  
 84500501 RDR STEERING DRUM  
 8060141 COTTER KEY (REPL ROLL PIN)  
 84500201 RUDDER HOUSING, UNDER HULL  
 84502301 SISTER SCREW, PRO RDR ASSY  
 8031490 SCREW  
 84500401 RDR MOUNT, UNDER HULL  
 84504001 TORSION SPRING, RUDDER  
 84500101 RUDDER BLADE, PRO A

- 84504501 HANDLE - BOW  
 8030361 SCREW SOC CAP  
 79545001 "HOBIE" DOME LOGO



- 71305001 HATCH SEAL  
 LARGE BULB (7.25')



- 84501901 HATCH LINER FWD - PRO ANGLER

- 72020311 PLANO BOX - SMALL YELLOW  
 72020321 PLANO BOX - MEDIUM BLUE  
 72020331 PLANO BOX - LARGE RED



- 84505001 STORAGE BUCKET ASSY  
 (INCLUDES COMPARTMENT WITH DIVIDERS)  
 84505101 STORAGE BUCKET COMPARTMENT  
 84505201 REPLACEMENT COMPARTMENT DIVIDERS  
 (SOLD AS EACH / REQ 7)  
 71301001 TRIM LOC TOP MOLDED 3.5'

- 8004531 CONTROL LINE (9')  
 81408101 HANDLE  
 81406101 INSERT - UP  
 84502201 CUTTING BRD, CNTR, BLACK  
 8030071 SCREW  
 8050111 NUT

- 84500001 SEAT ASSEMBLY - PRO ANGLER  
 84500011 LUMBAR SUPPORT PAD  
 84502901 KNOB, SEAT FRAME FRONT  
 8031811 STUD (FWD)  
 8042151 BOLT SHOULDER (REAR)  
 84500021 SEAT STRAP ASSY (ONE SIDE)  
 8011231 RIVET  
 84500031 STAINLESS REPLACEMENT BUCKLE

- 84504101 UNIVERSAL SIDE HANDLE ASSY  
 84504401 HANDLE END FITTING  
 8031781 SCREW SOC CAP  
 84504301 DECAL, RULER

- 71996001 BOTTLE/CAN HOLDER  
 74035001 FOLDING PADDLE CLIP

- 71702011 HATCH 8" TWIST AND SEAL

- 84504201 TUBE, STERN HANDLE  
 84504401 HANDLE END FITTING  
 8031781 SCREW SOC CAP

- 72013001 SKID GUARD, PRO  
 8030641 SCREW  
 10091000 DRAIN PLUG

Part	Description	OS			
278	WINDTRONIC 2 W/ BELT POUCH		8031201	SCREW 8-32 X 1-1/4 SOC SET CUP	
334	AIR FLOW TELS, RED / GREEN		8031231	SCREW 8-32 X 7/8" FHMS	
370	SHOCK CORD BALL TIES		8031451	SCREW #8-32 x 5/16 P-THMS SS	
376	SILICON RTV 100% 3 OZ.		8031461	SCREW 8-32 x 1" PHMS	
615	BOOK, PENGUIN BOAT FLIPPERS		8031481	SCREW 8-32 X 1-1/4 PHMS-P	
1550	KNIFE, STD. STAINLESS RIGGING		8031490	SCREW 8-32 X 1/2 FHMS-P	
1551	KNIFE, DLX STAINLESS		8031581	SCREW #8 X 5/8" PHMS-SS PH	
1555	KNIFE, YACHTSMAN POCKET		8031590	SCREW 8 X 3/4" FHMS-P SS	
1603	MAGICA RUST REMOVER GEL 8 OZ B		8031781	SCREW 5/16-18 X 1 E/S SOC	
1619	TRAMP CLEANER, SEASPRAY		8031811	STUD 5/16-18 X 1-1/4" 18-8 SS	
2082	SCALE - DOWN HAUL / FISH		8031961	SCREW 12-24 x 1-1/4 P-OHMS SS	
2101	SHOCK CORD HOOK 1/4" - HOBIE		8032011	SCREW 1/4-20x1/2 RHMS-P SS	
2102	SHOCK CORD FASTENER (SCH) 5/16		8032061	SCREW 1/4-20x1 1/4 PHPMS	
2105	SHOCK CORD HOOK 1/4"		8032081	SCREW 1/4-20 X 1-1/4 CAP SCREW	
3043	LICENSE FRAME - CHROME "HOBIE"		8032085	SCREW 1/4-20 X 1-1/4 FHMS-P	
3044	LICENSE FRAME - CHROME "KAYAK"		8032088	SCREW 1/4-20 x 2-1/4 HX CAP	
3062	SHACKLE, FAST		8034061	ALLEN WRENCH 1/8"	
3091	PADDLE, TELESCOPING 20"-3"9"		8034071	ALLEN WRENCH 5/64"	
3103	BLOCK, MINI W/AXLE		8040131	BOLT 1/4-20 X 3 1/2	
5106	SILICONE SPRAY 11.5oz		8040526	BOLT, CAM LOCK KNOB, 3.25 " NO	
5411	FAT BAG 5"		8040531	BOLT 3/8-16 X 1-1/2 HEX CAP-S	
5421	HATCH BAG KIT KAYAK		8040535	BOLT 3/8-16 x 1-3/4" SCKT HEAD	
7003	MIRA ZYME 8 oz ODOR ELIMINATOR		8042151	BOLT 5/16-18 X 1/2 SHOULDER	
7904	VELCRO ONE WRAP 1" BLACK		8050111	NUT 1/4-20 HX NYLOCK	
20501	HAIRPIN COTTER 5/16" 302 SS		8050211	NUT 10-32 NYLOCK LOPRO	
71172	B/U RING 8.0" FOR PTL-8		8050221	NUT (WELL NUT) 10-32 x1	
71201	CARGO COVER ASSY-PUR/MIR		8050231	NUT 10-32 HEX	
71311	GASKET KAYAK 5"		8050540	NUT 3/8-16 HX NYLOCK-LP	
72010	KEY FLOAT/SCUPPER PLUG		8050801	NUT 8-32 MACH/SCREW SS	
72035	QUICK STRAP SOFT RACK-24.0"		8052081	NUT 1/4-20 NYLON BLK	
72040	QUICK STRAP RACK W/TIE DN		8060111	COTTER PIN 3/32 X 3/4 SS	
72041	MULTI STRAP SYSTEM		8061961	SCREW 12-24 x 1-1/4 P-OHMS SS	
72042	TIE DOWN STRAPS - 12 FOOT		8063001	SLEEVE NIDROPRESS 1/16"	
72043	TIE DOWN STRAPS - 15 FOOT		8080211	WASHER #12 FLAT	
72044	PADS, RACK 24" AERO BAR		8080461	WASHER #10 FLAT-.25 OD X .56 I	
72045	RACK PADS -24.0"		8080500	WASHER #10 FINISH	
72046	RACK PADS -36.0"		8080541	WASHER 1/4 X 5/8 FLAT SS	
72047	STEEL-CORE TIE DOWN 12FT (PAIR)		8080551	WASHER-FLAT .227 X .453 SS	
72048	STEEL-CORE TIE DOWN 15FT (PAIR)		8080561	WASHER 1/4 X 1/2 X .032 SS	
72049	PADS, RACK 36" AERO BAR		8080571	WASHER FLAT 1/4x3/4x.063 SS	
72050	KAYAK COVER / 9-12'		8080691	WASHER 3/8 X 3/4 NYLON-FLAT	
72051	KAYAK COVER / 12-15'		8080731	WASHER #10 FNDR SS	
72052	KAYAK COVER / 14-16'		8080791	WASHER NYLON FLAT (TNS)	
72053	KAYAK COVER / 14-16' 6"		10091000	DRAIN PLUG W/GASKET	
72054	KAYAK COVER / 16-18' 6"		10092030	DRAIN PLUG w/GASKET- SEAT: KON	
72065	ST-TURBO FIN KIT		10730000	CLEAT-MAST	
72080	MINI KAYAK CART		10730021	CLAMCLEAT STBD BLACK	
72700	BIMINI / CHARCOAL - MANTIS JR		10730031	CLAMCLEAT PORT BLACK	
72701	BIMINI / BLUE - MANTIS JR PRO		10860001	LOCK RING 3/16"	
72702	BIMINI / GREEN - MANTIS JR PRO		10860100	LOCK RING 3/16" - 100 PACK	
72710	MOUNT - BIMINI MANTIS JR PRO		10870000	SHACKLE "BOW" 4.7 MM	
72720	KAYAK DODGER - CAMO		11220000	SHACKLE STND "D" 4.7 MM	
72721	KAYAK DODGER - SILVER		12451021	DECAL "HOBIE" DIAMOND-RED/SLVR	
72722	KAYAK DODGER - YELLOW		12451031	DECAL "HOBIE" DIAMOND-TURQ/SLV	
78501	QUEST RUDDER KIT/TWIST N STOW		12451050	DECAL "HOBIE" SCRIPT BLACK	
80024	BAG, MIRAGEDRIVE CARRY		12451051	DECAL "HOBIE" SCRIPT WHT	
80039	COOLER, KAYAK BLUE		12453011	DECAL - HOBIE KAYAKS	
80041	KAYAK CART - "UNIVERSAL"		12453021	DECAL - HOBIE KAYAK FISHING	
80043	PLUG IN CART HD UPGRADE KIT		12453031	DECAL - HOBIE CAT TEQ	
81024	LINE 5/32" NYLON BRAID-BLACK		13001001	DECAL BOW - FLYING "H" BLK	
81380	CONTROL ARM - UP/DOWN		20860000	LARGE CLEVIS RING	
83102	TOOL GERBER MULTI-PLIER 600		20860100	LARGE CLEVIS RING / 100 PACK	
83104	TOOL, HOG RING PLIERS		21180000	HOG RING 1/2" S/S, BLUNT, 14 G	
84503	SAIL KAYAK MAST 2-PC		22080011	JIB BATTEN PKT PROT W/SCREWS	
84511	BATTEN KAYAK SAIL 4.583 FT		36601000	DECAL FLYING "H" SMALL BLK	
84950	BAG - KAYAK SAIL RIG		36601011	DECAL FLYING "H" SMALL WHT	
84960	MIRAGE TDM SAIL ADAPTER KIT-SM		37380001	CLAMCLEAT MINI CL204	
84961	MIRAGE TDM SAIL ADAPTER KIT-LG		38120031	NYLON PUSH-IN PANEL RIVET	
8000341	LOCTITE BLUE .5 ML CAPSULE		38652000	TRAILER HOBIE ALUM KAYAK SINGLE AI / PRO	OS
8003171	TUBE 1/2" ID X 5/8" OD-PVC BLK		38652001	TRAILER HOBIE ALUM KAYAK SINGLE TI	OS
8004381	LINE 5 MM, DK GRAY w/MANGO TRA		38652200	TRAILER HOBIE ALUM KAYAK DOUBLE	OS
8004531	LINE 1/8 NYLON BRAID BLK		38652201	TRAILER ALUM KAYAK DOUBLE DOUB	OS
8010181	RIVET 6-4 PN HD		38652210	TOWER - TRAILER HOBIE ALUM DOU	OS
8012001	RIVET 6-9 BULB TYPE-KAYAK		38653300	TRAILER PAD KIT - KAYAKS	
8020041	CLEVIS PIN 3/16x.570 GRIP		38670011	"S" HOOK,WAVE HALYD DWNHL	
8020061	CLEVIS PIN 3/16x.753 GRIP		41220001	EYELET POST	
8020381	CLEVIS PIN 1/4x.578 GRIP		41370001	HATCH SCREW-IN W/LIP-WHT 5"	
8030031	SCREW #10x3/4 OHSMS-P		53170020	SCREW 1/4-20 X 1/2 SKTST (ABA)	
8030037	SCREW #6-32 x 3/4 PHMS		53180011	HOG RING 3/8" S/S FOR 3/16" BU	
8030071	SCREW 10-32 X 1/2 FHMS		53410061	LINE HANGER	
8030111	SCREW 10-32 X 1 PHMS-P SS		61070000	CLAMCLEAT JUNIOR CL203	
8030125	SCREW 10-32 x 1/2 BTN HD SCKT		70050001	HOBIE BOAT CLEANER - 10oz	
8030126	SCREW 10-32 x 3/8 FLNG BTN HX		70060001	HOBIE UV PROTECTANT - 10oz	
8030150	SCREW 10-32 x 1/2 PHMS-P		71110001	PAD EYE-BLK NYLON-3/8"	
8030161	SCREW 10-32 X 1-1/2 RHMS-P SS		71115001	SHOCK CORD END - SCREW-IN (UAI)	
8030171	SCREW 12-24 X 3/4 RHMS-P SS" (		71115101	TOOL - SCREW IN FITTINGS	
8030212	SCREW 1/4-20 X 1" OHMS-PH SS		71116001	PADEYE - SCREW-IN (UAI)	
8030251	SCREW 10-32 X 1" FHMS		71117001	CLEAT - SCREW-IN	
8030261	SCREW #10 X 1-1/4 PHMS-P		71120001	LASHING HOOK-BLACK	
8030281	SCREW 10-32 X 3/4" RHMS-P SS		71130001	HATCH SCREW-IN w/LIP-BLK 5"	
8030361	SCREW 5/16-18 X 1-1/4 SOC HD		71171001	B/U RING W/LIP FOR PTL-6	
8030451	SCREW 1/4-20 X 1-3/4 SCKT HD		71175001	HATCH BAG 6.0 DIA.-RED	
8030641	SCREW 10-32 X 1/2 THMS-P SS		71190001	HANDLE - LIFTING (WEB - KAYAK)	
8030671	SCREW 8-32 X 5/8 PHMS-P		71220001	PAD EYE - CHROME	
8030781	SCREW 1/4-20 X 1/2" SOC CAP		71230001	COVER, ROD HOLDER	
8030791	SCREW 1/4-20 X 5/8 SOC CAP		71250001	SHOCK CORD ASSY, KONA FWD DECK	
8030981	SCREW 10-32 x 3/4 PHPMS		71251001	SHOCK CORD ASSY, PDL HOLDER	
8031051	SCREW #10 X 1/2 FHMS-P TF		71253001	SHOCK CORD ASSY, ADV PDL HOLDE	
8031065	SCREW 10-32 x 7/8" THMS-P		71301001	TRIM-LOC SEAL (TOP MOLDED)	
8031069	SCREW 10-32x 1-1/4 THMS-P		71302001	TRIM-LOC SEAL (SIDE GLUED)	
8031081	SCREW 10-32 x1 3/4 PHMS-S SS		71320001	GASKET 5.0" & 7-1/8" SET	
8031111	SCREW 1/4-20x1 PHMS -P		71321001	GASKET KAYAK HATCH 6"	
8031131	SCREW #10x 3/4 PHSM-PH SS( ABA		71330001	GASKET - SCOTTY ROD HLDR MOUNT	
8031151	SCREW #10 X 1/2 PHMS-P TF-16		71331001	GASKET KAYAK HATCH 8"	
8031191	SCREW 1/4-20 X 1-1/4"PHMS		71552001	SHOCK CORD ASSY, ADV FWD HATCH	
			71554001	SHOCK CORD ASSY, QUEST	

INDEX

71701001	HATCH 6" TWIST-N-SEAL RETRO	72022031	EVOLVE v2 CABLE KIT (2ND HULL)
71701011	HATCH 6" TWIST-N-SEAL	72022040	EVOLVE v2 MOTOR KIT - i
71701021	O RING 6" TWIST-N-SEAL	72022130	EVOLVE v2 MOTOR W/225 PROPELLE
71702001	HATCH 8" TWIST-N-SEAL RETRO	72022131	EVOLVE v2 BATTERY
71702011	HATCH 8" TWIST-N-SEAL	72022132	EVOLVE v2 - BATTERY CHARGER
71702021	O RING 8" TWIST-N-SEAL	72022134	EVOLVE v2 CABLE, PWR EXT, 170"
71703001	HOBIE DRY BAG 8.0"	72023000	RAM TUBE ROD HOLDER W/ BASE
71704001	GEAR BUCKET	72023001	RAM SMALL DIAMOND BASE 1" BALL
71704021	GEAR BUCKET - DEEP	72023002	RAM SPACE SAVER BASE 1.5" BALL
71705001	GEAR BUCKET BAG	72023003	RAM TUBE BASE 2 X 2.5
71706001	GEAR BUCKET 3 PAK W/BAG	72023004	RAM POST CONV. ATTWOOD,SCOTTY
71995001	WATER BOTTLE - STAINLESS	72023006	RAM UNIV MOUNT 6 1/4 X 2
71996001	BOTTLE/CAN HOLDER	72023007	RAM FISHFINDER MOUNT COMPACT S
71997001	WATER BOTTLE MED SMOKE 20oz	72023008	RAM FLY ROD HOLDER W/ BASE
71998001	BOTTLE, WATER LARGE SMOKE 32oz	72023010	RAM TUBE ROD HOLDER - NO BASE
71999011	WATER BOTTLE SMALL SMOKE 16oz	72023013	RAM TUBE (PLASTIC PIVOT) ROD H
72009001	SCUPPER PLUG-PSUIT/MAUI/LANAI	72023014	RAM TUBE (PLASTIC) ROD HOLDER*
72012001	SCUPPER PLUG KONA/QUEST	72023015	RAM MAST-TUBE WEDGE MOUNT 1.5"
72013001	SKID GUARD, PRO	72023016	RAM MAST-TUBE WEDGE MOUNT 1"
72020000	HOBIE GEAR KEEPER SMALL 36"	72023017	RAM U-BOLT 1" RAIL BASE w/BALL
72020001	HOBIE GEAR KEEPER LARGE 36"	72023018	RAM MOUNT LOWRANCE ENDURA
72020002	SAFETY FLAG 4' (W/STUD)	72023021	RAM FISHFINDER MOUNT - FULL SI
72020003	HYDRO STAR SOS DLX LIGHT	72023022	RAM TUBE 2000 HOLDER w/FLUSH M
72020004	RITCHIE COMPASS PANEL MNT X-21	72025001	BATTERY - 12v FISHFINDER
72020005	FISHFINDER - LOWRANCE X-4 PRO	72025002	CHARGER - 12v BATTERY FISH F
72020007	HOBIE LIVEWELL	72025003	PIGTAIL WIRE / 12v FISHFINDER
72020008	HOBIE ANCHOR TROLLEY KIT	72062001	SIDEKICK - LOCK PIN SINGLE
72020009	HOBIE DRIFT CHUTE	72062011	SIDEKICK - MOUNT BRACKET BOTTO
72020010	HOBIE SAFETY KIT	72062021	SIDEKICK - MOUNT BRACKET TOP
72020011	FISHFINDER INSTALLATION KIT	72062041	SIDEKICK - CROSSBAR MIDDLE
72020012	MOUNT - SAFETY FLAG	72062061	SIDEKICK - ADP PLATES +07 ADVE
72020013	KAYAK GUN MOUNT (PAIR)	72062062	SIDEKICK - MOUNT KIT W/CTR BAR
72020014	ROD HOLDER EXTENSION	72062101	SIDEKICK AMA KIT - LT GRAY
72020015	ROD HOLDER - LIVEWELL w/FASTEN	72062111	SIDEKICK - FLOAT LT GRAY W/ QU
72020016	FISHFINDER-LOWRANCE X67C	72062201	SIDEKICK - BENT ARM
72020017	FISHFINDER/GPS-LOWRANCE M68C	72063101	SIDEKICK AMA KIT - DK GREEN
72020018	GPS ENDURA-OUT&BACK	72063111	SIDEKICK - FLOAT DK GREEN W/ Q
72020019	FISH GRIP	72066001	ST-TURBO FIN KIT V2 - THREADED
72020020	FISHFINDER PACKAGE	72076001	STAKEOUT POLE - KAYAK FISHING
72020021	ULTIMATE KAYAK FISHING PACKAGE	72088001	KAYAK STAND 31" (PR) TALIC
72020022	KAYAK FLY FISHING PACKAGE	72097001	KC WELDER PRO WITH ROD STOCK
72020023	KAYAK CUSTOMIZATION PACKAGE	72103001	MOUNT, SHOCK CORD
72020024	MIRAGE PERFORMANCE PACKAGE V2	72104001	ADJ SHOCK CORD HOOK 3/8"
72020025	KAYAK TRAVEL PACKAGE	72402001	KAYAK SEAT - PADDLE 2010
72020026	KAYAK SAFETY PACKAGE	72409001	STRAP W/HOOK - PADDLE SERIES
72020028	MIRAGE SEAT PAD - INFLATABLE	72500001	STRAPS THIGH CNTRL PADDED ASSY
72020029	HOBIE SAFETY PACKAGE-DELUXE	72730001	DODGER - ISLAND / YELLOW
72020030	TEAR-AID / TYPE A (POLY)	72730002	DODGER - ISLAND / SILVER
72020031	TEAR-AID / TYPE B (VINYL)	72730003	DODGER-PRO ANGLER CAMO
72020032	BILGE - HAND PUMP	74010001	PADDLE BLADE RIGHT
72020033	ULTIMATE KAYAK NAVIGATION PACK	74011001	PADDLE BLADE LEFT
72020034	PEDAL PAD KIT BLACK (PAIR)	74030001	PADDLE DRIP RING - ALUM SHAFT
72020036	FISHFINDER-LOWRANCE MARK PRO	74030002	PADDLE DRIP RING - FG SHAFT
72020037	FISHFINDER-LOWRANCE ELITE-5X	74035001	FOLDING PADDLE CLIP, 1-1/8"
72020038	FISHFINDER/CHART PLOTTER-LOWRA	74049001	T- HANDLE, PADDLE
72020039	FISHFINDER FULL SIZE INSTALL K	74050001	PADDLE LEASH-WEB/ELASTIC
72020040	SAFETY FLAG/LIGHT COMBO	74051001	PADDLE LEASH-COIL
72020041	HATCH LINER FWD - OUTBACK	74052001	HOBIE FISH ROD LEASH- WEBBING
72020042	HATCH LINER FWD - REVO	74052101	LEASH KIT - MIRAGEDRIVE
72020300	KAYAK RIGGING KIT - HARDWARE	74075001	PADDLE 230 cm HOBIE FIBER SHAF
72020311	TACKLE BOX - SMALL YELLOW	74076101	BUTTON ASSY - PADDLE FERRULE
72020321	TACKLE BOX - MEDIUM BLUE	74077001	i - PADDLE, 4 PIECE
72020331	TACKLE BOX - LARGE RED	76050001	HANDLE KAYAK (MOLDED)
72020400	CRADLE SET - ADV ISL TRAILER	76055001	HANDLE, MIDSHIP
72020401	CRADLE SET - PRO ANGLER TRAILER	78000001	OWNER'S MANUAL-QUEST
72020402	CRADLE SET - TDM ISL TRAILER	78510001	BUNGEE HOOK
72020500	HOBIE EXPANDABLE UPRIGHT	78520001	EYELET HOLD DOWN
72020501	HOBIE WHEELED DUFFEL	78535001	FOOT BRACE ASSY-LT
72020502	HOBIE BACK PACK	78536001	FOOT BRACE ASSY-RT
72021001	BATTERY - LIVEWELL	78540001	TRACK ADJ - BRACE/QUEST
72021002	BATTERY CHARGER - LIVEWELL	78551001	RUDDER BRACKET - QUEST (T-N-S)
72021003	SWITCH - LIVEWELL	78560001	MAP POCKET FRAME w/MESH
72021004	INTAKE TUBE ASSY - LIVEWELL	79050011	CAM LEVER / CLICK-N-GO WELL
72021005	STRAP SET - LIVEWELL	79050021	SPRING / i - CLICK-N-GO WELL
72021006	BATTERY LID - LIVEWELL	79050041	BOLT, SHOULDER 1/4 " / CLICK-
72021007	PUMP CONNECTOR FEMALE - LIVEWE	79050061	CASSETTE PLUG/i- SERIES
72021008	PUMP CONNECTOR MALE - LIVEWELL	79050211	DRAIN PLUG - i /LIVEWELL/ *10-
72021009	DOWNSPOUT FITTING - LIVEWELL	79050212	O-Ring .299ID x .505OD Neopren
72021010	INTAKE 90 DEGREE - LIVEWELL	79050400	i - WRENCH-MIRAGE DRIVE SS
72021011	INSTALLATION PAD, FISHFINDER	79052000	i - ACCESSORY HOLDER KIT
72021020	DOWNSPOUT TUBE - LIVEWELL	79052001	i - CUP HOLDER KIT
72021021	TERMINAL COVER - LIVEWELL	79052003	i - INFLATION PUMP / STANDARD
72021022	PUMP ATTWOOD - LIVEWELL	79052005	i - INFLATION PUMP / ELECTRIC
72021023	INTAKE TUBE 7" ONLY - LIVEWEL	79052006	i - HARDWARE ACCESSORY KIT
72021025	ELEG CONNECTOR REPL SET	79052007	i - SEATBACK
72021031	EVOLVE CABLE KIT (2ND HULL)	79052009	i - HULL REPAIR KIT
72021060	HORIZONTAL ROD HOLDER KIT	79052010	i - ROLLING TRAVEL BAG/ i - 12
72021108	PROP, HOBIE DESIGN, TORQ MOTOR	79052011	i - ROLLING TRAVEL BAG/ i - 14
72021113	THRU HULL FITTING, PWR PLUG, V	79052012	i - ROLLING TRAVEL BAG/ i - 9
72021114	BACKING RING, PWR PLG THRU HUL	79052013	i - O RING LG - INFLATION PUM
72021115	MNTG PLT, M12 CABLE GLAND	79052014	i - O RING SM - INFLATION PUMP
72021116	BACKING RING, MNTG PLT, M12 CA	79052015	i - TRI RING KIT / SAGE
72021119	GASKET PACK, CABLE MOUNTS	79052016	i - TRI RING KIT / SUNDANCE
72021120	CAP, PWR PLUG, FEMALE	79052017	i - VALVE ASSEMBLY
72021122	LANYARD, TYCO CNCTR CAP V1	79052018	i - GLUE 30g TUBE
72021123	CAP, M12 CNCTR, FEMALE CVR	79052019	i - PADDLE HOLDER
72021124	CAP, M12 CNCTR, MALE CVR	79052202	i - SAIL KIT TURQ/PAPAYA
72021128	CAP ASSY POWER PLUG MALE	79052203	i - SAIL KIT WHITE-TURQ
72021129	FIN KIT - EVOLVE	79052204	i - SAIL KIT SILVER-WHITE
72021132	CHARGER - eVolve BATTERY	79052251	SAIL KAYAK MAST 4-PC
72021133	REMOTE THROTTLE, TORQUEEDO	79501001	DAGGERBOARD WELL PLUG - ADV
72021134	CABLE, POWER EXTENSION, 170"	79502001	DAGGERBOARD / ADV - MOLDED
72021135	CABLE, M12, THROTTLE BOX CONEC	79509001	SAIL ADV ISL WHT/GRAY/WHT
72021136	CABLE, M12, THROTTLE CONTROL	79510001	MAST - ADV ISLAND (*07 / MALE
72021137	KEY W/LANYARD AND CLIP	79510011	MAST - ADV ISLAND (*08 / FEMA
72022030	EVOLVE v2 MOTOR KIT - K	79510201	BAG - ADV ISLAND MAST / SAIL

OS  
OS



INDEX

79510202	BAG - TANDEM ISLAND MAST/SAIL		81037001	DRIVE SEAL / MIRAGE DRIVE
79510721	MOUNT XBAR V2 - TOP		81038001	DRIVE SEAL / i - MIRAGE DRIVE
79510731	MOUNT XBAR V2 - BOTTOM		81040001	OUTHAUL BLOCK (STNLS SPKT)
79511001	BASE / PIN - ISLAND MAST		81050001	OUTHAUL BLOCK (INJ/MOLD)
79511021	MAST CAP - AI (SWIVEL TIP)		81051001	LINE-CONTROL 1,000 lb, BEIGE
79511101	BASE / HOLE - '08 ISLAND MAST		81055001	SPROCKET GUARD FWD (INJ/MLD)
79512001	DRUM - ISLAND MAST FURLER		81080001	SPROCKET SHAFT MIRAGE
79512201	AKA AI V2 - RT FWD		81090001	DRUM SHAFT MIRAGE
79512301	AKA AI V2 - LT FWD		81095001	ALIGNMENT PIN - MIRAGE DRIVE
79512401	AKA AI V2 - LT REAR		81100001	CRANK LEFT MIRAGE (THREADED)
79512501	AKA AI V2 - RT REAR		81105001	CRANK RIGHT MIRAGE (THREADED)
79512601	XBAR AI V2 - FWD		81110001	SHAFT #5 MIRAGE
79513001	BACKING RING, AI MAST RECEIVER		81121001	IDLER PULLEY (PLASTIC DRUM)
79514001	MAST RECEIVER, ADV ISL (FIBER)		81128001	SPROCKET W/SET SCREW (INJ/MLD)
79514101	MAST RECIVER CUP ASSY AI '08		81129001	SPROCKET V2 - THREADED W/GUARD
79515001	SAIL ADV ISL RED/GRAY/WHT	OS	81129022	V2 SPROCKET / MAST KIT STD (PA
79516001	SAIL ADV ISL TURQ/PAPAYA/WHT	OS	81129122	V2 SPROCKET / MAST KIT TURBO (
79517001	V-FRAME, STRUT		81130001	SPROCKET MIRAGE - STAINLESS
79518001	V-FRAME, BASE		81155001	BOLT DRUM/CRANK
79519001	V-FRAME, TURNBUCKLE-BRASS		81160001	MAST, MIRAGE DRIVE, STD (UNIVE
79520001	AKA - FWD AI		81163001	MAST - V2 STANDARD - THREADED
79520201	COLLAR - AKA		81171001	DRUM PLASTIC MIRAGE
79520301	END CAP - AKA		81172001	DECAL, PEDAL ADJUSTMENT
79520311	AKA, FWD - TI		81173001	DRUM - V2
79520401	AKA, LT REAR - TI		81181001	SPINE MIRAGE DRIVE - PLASTIC
79520501	AKA, RT REAR - TI		81190001	FIN - MIRAGEDRIVE STANDARD
79521001	AKA - LEFT/REAR AI		81192001	MIRAGE ST TURBO FIN (W/PIN & R
79522001	AKA - RIGHT/REAR AI		81193001	MIRAGE ST FIN (w/PIN & RING)
79522201	LOCK BEARING, AKA XBAR		81198001	MAST - ST TURBO FIN/UNIVERSAL
79523001	SOCKET - AKA BRACE LOCK		81198101	MAST - V2 ST TURBO - THREADED
79523101	BRACE ASSY (L) AKA AI V1 -22"		81201001	MIRAGEDRIVE CHAIN ASSY MIRAGE
79523102	BRACE ASSY (R) AKA AI V1 -22"		81202001	CHAIN ASSY, MIRAGEDRIVE V2
79523201	BRACE ASSY (L) AKA AI V2 -23"		81203001	IDLER CABLE, MIRAGEDRIVE V2
79523202	BRACE ASSY (R) AKA AI V2 -23"		81211001	IDLER CABLE ASSY (14 3/4) MIRA
79524001	CAP - AKA BRACE LOCK		81212001	IDLER CABLE ASSY (14 1/4") MIR
79525001	BALL - AKA BRACE		81221001	PEDAL / CRANK ASSY LEFT
79526001	BAG - AKA CARRY - AI		81221011	PEDAL REPLACEMENT LEFT
79526002	BAG - AKA CARRY - TI		81222001	PEDAL / CRANK ASSY RIGHT
79526201	ISLAND PADDLE / AKA BRACE KIT		81222011	PEDAL REPLACEMENT RIGHT
79526211	PADDLE STORAGE WEB ASSY		81222101	CAP - PEDAL CRANK
79527001	TRAMP SET AI - BLACK		81226001	PEDAL STRAP REPLACEMENT RIGHT
79527011	TRAMP SET AI - GREY		81227001	PEDAL STRAP REPLACEMENT LEFT
79527101	LACING ROD - AI TRAMP		81230001	PEDAL ADJUSTMENT PIN
79527201	TRAMP AI/TI - WEB/BUCKLE ASSY		81236001	PEDAL ADJUST HANDLE ASSY
79530001	XBAR - REAR ASSY AI		81240001	ADJUSTMENT HANDLE (OSP)
79530201	XBAR, REAR - TI		81242001	SPRING COMPRESSION 1-1/4" LNG
79531001	XBAR - FWD ASSY AI		81245001	PIN, ROLL 1/8 x 1-1/4 (420 SS)
79531101	CLEAT SUPPORT WEDGE w/FAIRLEAD		81259001	SEAT STRAP w/HOOK
79531111	CLEAT SUPPORT WEDGE		81265001	PLUG-IN SEAT PEG (OLDER)
79531201	XBAR, FWD - TI		81265101	PLUG-IN SEAT CONNECTOR KIT ADJ
79532001	SPRING ASSEMBLY, ISLAND ADV		81266001	BACKREST MIRAGE 2009
79533001	BEARING PLATE, MAST FURLER		81266011	SEATBACK GEAR PACK
79535001	CONNECTION PIN, AKA/XBAR		81267001	HOOK, KAYAK SEAT
79536001	CONNECTOR, AKA BRACE		81268001	KAYAK BACKREST MIRAGE 2010
79537001	CLIP, ISLAND AKA BRACE KIT (2)		81340001	BUSHING - STAINLESS SPROCKET
79538001	PADDLE CLIP, ISLAND XBAR		81350001	RUDDER MOUNT-MIR
79538101	ISLAND PADDLE HOLDER KIT		81360001	RUDDER PIN MIRAGE S.S.
79538201	PULL TAB - WEBBING LOOP		81361001	RUDDER MOUNT PIN MIR 4-1/2"
79545001	DECAL, HOBIE DOME, BLK/GRAY		81362001	RUDDER MOUNT PIN TDM/OUT/SPT
80010001	MIRAGE DRIVE		81370001	STEERING CRANK
80010201	MIRAGEDRIVE SPARE PARTS KIT		81372001	STEERING CRANK ADV/OUTFITTER
80010301	MIRAGEDRIVE "V2" SPARE PARTS K		81375001	COMPRESSION SPRING (1)
80012001	PEDAL RETAINER BUNJEE ASSY		81380001	CONTROL ARM - UP/DOWN
80013001	MIRAGE DRIVE - ST TURBO		81385001	WASHER 13/16 EDPM RUBBER
80013011	MIRAGE DRIVE - i SERIES		81390001	RUDDER MIRAGE - ORIGINAL STYLE
80013201	MIRAGEDRIVE TURBO SPARE PARTS		81391002	RUDDER UP/DOWN LINE SYSTEM
80013301	MIRAGEDRIVE "V2" TURBO SPARE P		81391011	GUDGEON, T-N-S RDR (UAI)
80020001	LINE KIT MIRAGE RUDDER / UNIVE		81392001	CONTROL ARM, TWIST-N-STOW RDR
80025001	LINE CONTROL ASSY - (1) LINE A		81393001	THUMB SCREW 1/4-20 BLK NYLON
80030001	SPEEDOMETER MIRAGE DRIVE		81394001	RUDDER PIN, TWIST N' STOW RDR
80044021	HOBIE-TRAX CART FRAME		81394021	RUDDER PIN, TWIST N' STOW 2011
80044031	HOBIE-TRAX CART PAD		81395001	RUDDER ASSY W/SM BLADE - TWIST
80044051	HOBIE-TRAX HUB LOCK KNOB		81395201	RUDDER BLADE - SMALL / TWIST-N
80044101	HOBIE TRAX "2" CART PLUG-IN		81396001	RUDDER ASSY W/LRG BLADE - TWIS
80044111	HOBIE TRAX "2" WHEEL REPLACE		81397001	RUDDER BLADE - LARGE / TWIST-N
80044151	PIN W/SHOCK CORD - CART KEEPER		81397101	i / QUEST - RUDDER BLADE - LAR
80044201	CART POST COLLAR/CLAMP KIT		81399001	BOLT TWIST-N-STOW DRUM
80045000	CAP - HOBIE CART DOME		81400001	TUBING HI-DENSITY PE
80045001	HOBIE STANDARD PLUG-IN CART		81405001	STEERING TUBE HOLDER (UAI)
80045041	HOBIE STANDARD CART - WHEEL		81405101	CAP - STEERING TUBE "O" RETAIN
80045101	i - HOBIE PLUG-IN CART / STAND		81406001	DECAL / HANDLE - UP
80046001	HOBIE HVY DUTY PLUG-IN CART		81406101	CAP, UP INSERT
80046041	HVY DUTY CART - WHEEL REPL.		81407001	DECAL / HANDLE - DOWN
80046100	HOBIE DOLLY, TI TUFF-TIRE		81407101	CAP, DOWN INSERT
80046141	WHEEL, TI TUFF-TIRE DOLLY		81408001	HANDLE, RUDDER PULL CORD
80046200	HOBIE DOLLY, TI BEACH-TIRE		81408101	HANDLE, UP/DOWN CAP STYL
80046241	WHEEL, TI BEACH DOLLY		81410001	CAM LOCK KNOB
80048001	ROD HOLDER-BAIT CASTER W/MOUNT		81420001	SPROCKET GUARD URE
80048002	ROD HOLDER HEIGHT EXTENDER 8.5		81450001	CHEEK BLOCK - HOBIE
80048003	ROD HOLDER HEIGHT EXTENDER 6.5		81535001	CASSETTE PLUG-BLK (UAI)
80048004	ROD HOLDER w/ SIDE/DECK MOUNT		81600001	COVER, CLICK-N-GO, LEFT
80048005	ROD HOLDER-ROCKET LAUNCHER		81600101	COVER, CLICK-N-GO, RIGHT
80048006	GEAR HEAD MOUNT		81600201	COVER - LEVER, CNG LT - INSIDE
80049001	FLUSH DECK MOUNT, BLK		81600301	COVER - LEVER, CNG RT - INSIDE
80052001	SIDE/DECK MOUNT, BLK		81600401	COVER - LEVER, CNG LT -OUTSIDE
80055001	ROD HOLDER-FLY w/DECK MNT		81600501	COVER - LEVER, CNG RT -OUTSIDE
80074001	STEERING LINE TUBE 68" (Pro A)		81602101	SPRING CLICK-N-GO LEFT
81013001	STEERING HANDLE 2011 STD LENGT		81602201	SPRING CLICK-N-GO RIGHT
81014001	STEERING CRANK SPORT		81611101	CLICK-N-GO ASSY LEFT/PORT
81015001	STEERING HANDLE ASSY MIRAGE		81611201	CLICK-N-GO ASSY RIGHT/STBD
81016001	STEERING CRANK REV/OUTBK		82300001	HOBIE STUFF
81017001	STEERING CRANK, OUTFR/OASIS		82420001	COVER, RUDDER TI/2011+ AI
81023001	LINE-CONTROL 700 LB GRAY		84431001	DVD / HOBIE - FISH THE WORLD
81030001	ZIP TIE, 6-5/16", BLK NYLON		84500001	SEAT ASSEMBLY - PRO ANGLER
81035001	RUDDER UP/DOWN HANDLE ASSY W/S		84500011	LUMBAR PAD PRO ANGLER
81035011	HANDLE - UP/DOWN RETRO KIT		84500021	SEAT STRAP ASSY - PRO A

INDEX

84500101	RUDDER BLADE, PRO A		99600001	INSTALL TOOLS - MAST HOLE SAW	
84500111	HOBIE H-BAR / PRO ANGLER		99603001	ISLAND SAIL KIT - YELLOW-WHT	OS
84500201	RUDDER HOUSING, UNDER HULL		99604001	ISLAND SAIL KIT - RED-WHT	OS
84500401	RDR MOUNT, UNDER HULL		99605001	ISLAND SAIL KIT - SILVER-WHT	OS
84500501	RDR STEERING DRUM		1553CR	CROAKIES "HOBIE"	
84500601	COVER PLT, RDR SYSTEM		1553L	LID LATCH MULTI-COLOR	
84500801	STEERING TUBE RESTRICTOR		1562BLK	SUNGLASS HOBIE PLAYA BLACK	
84500911	ROD HOLDER ASSY (L) - PRO A		1564BLK	SUNGLASSES HOBIE BOOMER BLACK	
84500921	ROD HOLDER ASSY (R) - PRO A		1565BLK	SUNGLASSES HOBIE ESCONDIDO	
84501001	B/U PLATE, ROD HOLDER		1825WHT	TOYBOX	OS
84501101	GASKET, ROD HOLDER PLT		3187LG	GLOVES - FULL FINGER LARGE	
84501201	THRU HULL BARB CONNECTOR		3187MD	GLOVES - FULL FINGER MEDIUM	
84501301	HANDLE, STEERING SYSTEM		3187SM	GLOVES - FULL FINGER SMALL	
84501401	HOUSING, STEERING SYSTEM		3187XL	GLOVES - FULL FINGER X LARGE	
84501511	KNOB, STEERING TENSION		3187XS	GLOVES - FULL FINGER X SMALL	
84501521	WASHER, 3/16x 1/2 OD, RUBBER		3187XXS	GLOVES - FULL FINGER XX SMALL	
84501531	BALL, STEERING SYSTEM, PRO A		3188LG	GLOVES HOBIE LARGE	
84501601	TUBE CONNECTOR, STEERING		3188MD	GLOVES HOBIE MEDIUM	
84501901	HATCH LINER FWD - PRO ANGLER		3188SM	GLOVES HOBIE SMALL	
84502001	MOUNTING BRD, RT, BLK		3188XL	GLOVES HOBIE X LARGE	
84502101	MOUNTING BOARD, LT		3850LG	HOBIE SPRAY TOP LG	
84502201	CUTTING BRD, CNTR, BLACK		3850MD	HOBIE SPRAY TOP MD	
84502301	SISTER SCREW, PRO RDR ASSY		3850SM	HOBIE SPRAY TOP SM	
84502401	FLOOR MAT RT-BLK		3850XL	HOBIE SPRAY TOP XL	
84502501	FLOOR MAT LT-BLK		3853LG	HOBIE - SHORTY 2/2 LG RED/BLK	
84502601	STEERING TENSION SCREW		3853MD	HOBIE - SHORTY 2/2 MD RED/BLK	
84502901	KNOB, SEAT FRONT		3853SM	HOBIE - SHORTY 2/2 SM RED/BLK	
84504001	TORSION SPRING, RUDDER		3853XL	HOBIE - SHORTY 2/2 XL RED/BL	
84504101	SIDE HANDLE ASSY - UNIVERSAL		3854LG	HOBIE - FULL 3/2 LG RED/BLK	
84504201	TUBE, STERN HANDLE		3854XL	HOBIE - FULL 3/2 XL RED/BLK	
84504301	DECAL, RULER		3855LG	HOBIE - SHORTY 2/2 LG BLACK	
84504401	HANDLE END FITTING		3855MD	HOBIE - SHORTY 2/2 MD BLACK	
84504501	HANDLE BOW - PRO ANGLER		3855SM	HOBIE - SHORTY 2/2 SM BLACK	
84505001	STORAGE BUCKET ASSY		3855XL	HOBIE - SHORTY 2/2 XL BLACK	
84505101	STORAGE BUCKET COMPARTMENT		3856LG	HOBIE - FULL 3/2 LG BLACK	
84505201	STORAGE BUCKET COMPARTMENT DIV		3856MD	HOBIE - FULL 3/2 MD BLACK	
84506001	STEERING ASSEMBLY (Pro A)		3857LG	SHIRT, MEN'S SPORT TEE LONG SL	
84506201	STEERING (PRO A) REVERSIBLE AS		3857MD	SHIRT, MEN'S SPORT TEE LONG SL	
84509001	BATTEN CAP 1/8 DIA - KAYAK SAI		3857SM	SHIRT, MEN'S SPORT TEE LONG SL	
84513001	SAIL KIT KAYAK TURQ/PAPAYA	OS	3857XL	SHIRT, MEN'S SPORT TEE LONG SL	
84514001	SAIL KIT KAYAK WHITE/RED	OS	3858LG	SHIRT, MEN'S SPORT TEE SHORT S	
84515001	SAIL KIT KAYAK WHITE/TURQ	OS	3858MD	SHIRT, MEN'S SPORT TEE SHORT S	
84516001	SAIL KIT KAYAK SILVER/WHITE	OS	3858SM	SHIRT, MEN'S SPORT TEE SHORT S	
84550001	MAST RECEIVER - MIRAGE KAYAK S		3858XL	SHIRT, MEN'S SPORT TEE SHORT S	
84560001	CAP, PLASTIC MAST RECEIVER		3859LG	SHIRT, LADIE'S SPORT TEE V NEC	
84965001	DOWNHAUL HOOK-SAIL ADAPTOR		3859MD	SHIRT, LADIE'S SPORT TEE V NEC	
86000001	OWNER'S MANUAL-MIRAGE		3859SM	SHIRT, LADIE'S SPORT TEE V NEC	
88523101	BRACE ASSY (L) AKA TI -22"		3859XL	SHIRT, LADIE'S SPORT TEE V NEC	
88523102	BRACE ASSY (R) AKA TI -22"		5018BK	HAT HOBIE "H" BLACK	
88527001	TRAMP SET TI - BLACK		5018BL	HAT HOBIE "H" BLUE / GOLD	
88527011	TRAMP SET TI - GREY		5018GM	HAT HOBIE "H" GREY MESH	
88536001	CONNECTOR, AKA BRACE TI		5018RM	HAT HOBIE "H" RED MESH	
88991001	CENTERBOARD TDM ISLAND		5018TG	HAT HOBIE "H" TAN w/ GREEN LOG	
88991011	CENTERBOARD TOP CVR-TDM ISLAND		5019BK	HAT "HOBIE" 6-PANEL LO PRO BLK	
88991021	CENTERBOARD PIN-TDM ISLAND		5022FO	XXHAT - FISH FLEXFIT OLIVEXX	
88991031	PIN HOLDER-TDM ISLAND		5022TK	XXHAT - FISH TRUCKER KAHKIXX	
88991041	KNOB-TDM ISLAND		5022TO	XXHAT - FISH TRUCKER OLIVEXX	
88991061	SIDE CARRY HANDLE-TDM ISLAND		5023PP	HAT-PERFORMANCE CAP PUMPKIN	
88991071	FURLER DRUM - TDM ISLAND		5023TO	HAT-TWILL CAP OAR WASHED	
88991094	GUDGEON, AI/TI		5023TS	HAT-TRUCKER BOA GREEN/STONE	
88991098	RUDDER REPLACEMENT KIT TI/AI		5023VS	HAT-VISOR STONE WASHED TWILL	
88991099	RUDDER-UP STRAP ASSY		5024LG	HAT, AUSSIE LG (60cm/23.6") KH	
88991101	RUDDER PIN-TDM ISL / 2011+ AI		5024MD	HAT, AUSSIE MD (58cm/22.8") KH	
88991121	MAST-TDM ISLAND (550 CM)	OS	5025MF	HAT, MICROFIBER w/NECK FLAP KH	
88991150	KNOB CAP-TDM ISLAND		5026BM	HAT, BEANIE MEN'S BLK w/ RED L	
88991151	DOVE DECAL LG HANDLE, H LOGO		5026BW	HAT, BEANIE WOMEN'S WHT w/LT B	
88991152	DOVE DECAL SM HANDLE - H LOGO		5129LG	T-SHIRT KAYAK LG BLK	
88991191	V-FRAME STRUT 3/8-TDM ISLAND		5129MD	T-SHIRT KAYAK MD BLK	
88991201	V-FRAME BASE 3/8-TDM ISLAND		5129XL	T-SHIRT KAYAK XL BLK	
88991215	SET SCREW, TI MAST V BRACE		5130LG	T-SHIRT KAYAK LG GREY	
88991235	DOWEL PIN 3/16 x 1-1/2"		5130MD	T-SHIRT KAYAK MD GREY	
88991271	EXTENSION EXTR - MAST CUP -TDM		5130XL	T-SHIRT KAYAK XL GREY	
88991281	STEERING CRANK, AI/TI (2011)		5131LG	T-SHIRT FISHING LG	
88991301	STEERING HANDLE-TDM ISLAND (UA		5131MD	T-SHIRT FISHING MD	
88991303	AMA - TDM ISLAND PAPAYA	OS	5131XL	T-SHIRT FISHING XL	
88991304	AMA - TDM ISLAND HIBISCUS	OS	5131XXL	T-SHIRT FISHING XXL	
88991305	AMA - TDM ISLAND DUNE	OS	5351B	HATCH COVER KIT 5" BLACK	
88991311	MAST CAP TI		5351W	HATCH COVER KIT 5" WHITE	
88991351	KNOB - STEERING HANDLE		72000B	POUCH GUSSETED 6x12	
88991352	KNOB CAP		72005B	POUCH SUPER GUSSETED 8x15	
88991355	KNOB ASSY, STEERING HANDLE		72210T	SEE BAG 8" X 14"	
88998514	SAIL-TDM ISLAND DUNE		72230T	SEE BAG 11" x 19"	
88998515	SAIL-TDM ISLAND SMOKE		80035A	ANCHOR w/BAG & LINE (3 LB)	
88998516	SAIL-TDM ISLAND BREEZE		H071	SPRING-STANDUP	
88998521	BATTEN TI #1 3/8" x 186" W/CAP		H082	BLOCK-SINGLE BULLET	
88998522	BATTEN TI #2 3/16" x 42.5" W/		H083	BLOCK-BULLET W/BECKET	
88998523	BATTEN TI #3 3/16" x 39.5" W/		H092	BLOCK-BULLET CHEEK	
88998531	BATTEN CAP 1/4 DIA		H166	BLOCK-BULLET SWIVEL	
88999519	BATTEN CAP 3/8 DIA (UAI)		H167	BLOCK-BULLET SWIVEL W/BECKET	
89000001	OWNER'S MANUAL-MIRAGE SPORT		H2131	SHACKLE 4 MM BOW SS 5/32" PIN	
89500001	OWNER'S MANUAL-ADVENTURE/OUTFI		H224	BLOCK-MICRO SINGLE	
90610111	DELRIIN BALL 3/8 DIA - FURLERS		H225	BLOCK-MICRO W/BECKET	
91011001	BATTEN CAP 3/16 DIA		H233	BLOCK-MICRO CHEEK	
91041011	BATTEN 3/16 FG ROD, 7" 8-1/2"		H2655	BLOCK, 40mm CARBO FIDDLE	
91050010	HOOK WHT NYLON SEW-ON		H281	EYESTRAP-MICRO SS	
91050020	HOOK BLK NYLON SEW-ON		H284	KIT-MICRO WIRE FAIRLEAD	
91051011	BATTEN 3/16 FG ROD, 9" 2"		H297	WEDGE KIT-MICRO CAM	
99303001	ISLAND AMA REPL-PAPAYA		H350	29mm CARBO CHEEK	
99304001	ISLAND AMA REPL-HIBISCUS	OS	H404	BLOCK-16MM AIR FXD SGL	
99305001	ISLAND AMA REPL-DUNE	OS	H405	BLOCK-16MM AIR FIXED SGL W/BKT	
99403001	ISLAND AMA KIT - PAPAYA	OS	H406	BLOCK-16MM AIR FIXED DOUBLE	
99404001	ISLAND AMA KIT - HIBISCUS	OS	H407	BLOCK-16MM AIR FIXED DBL W/BKT	
99405001	ISLAND AMA KIT - DUNE	OS	H424B	FAIRLEAD MICRO CAM - BLK	
99503001	ISLAND CONVERSION KIT - PAPAYA	OS	H427	CAM-MICRO CARBO W/WIRE FAIRLEA	
99504001	ISLAND CONVERSION KIT- HIBISCU	OS	H471	CAM CLEAT-MICRO CARBO	
99505001	ISLAND CONVERSION KIT - DUNE	OS	RF4850LG	GLOVES-FINGERLESS LG STICKY	

INDEX

RF4850MD	GLOVES-FINGERLESS MD STICKY	S6142XXL	PFD WEDGE-E XXL
RF4850SM	GLOVES-FINGERLESS SM STICKY	S6143LXL	PFD HI-BACK ZIP MANGO LXL
RF4850XL	GLOVES-FINGERLESS XL STICKY	S6143SMD	PFD HI-BACK ZIP MANGO SMD
RF4850XS	GLOVES-FINGERLESS XS STICKY	S6143XXL	PFD HI-BACK ZIP MANGO XXL
RF4851LG	GLOVES-3 FINGER LG STICKY	S6144LXL	PFD HI-BACK ZIP GREEN LXL
RF4851MD	GLOVES-3 FINGER MD STICKY	S6144SMD	PFD HI-BACK ZIP GREEN SM
RF4851SM	GLOVES-3 FINGER SM STICKY	S6144XXL	PFD HI-BACK ZIP GREEN XXL
RF4851XL	GLOVES-3 FINGER XL STICKY	S6145LXL	PFD HIBACK MANGO LXL -ULC
RF4851XS	GLOVES-3 FINGER XS STICKY	S6145SMD	PFD HIBACK MANGO SMD -ULC
RH014WHT	LINE 1/4" STRAIT-CORE POLY	S6146MLG	PFD HI-BACK P-BLUE (W) MLG
RH018WHT	LINE 1/8" NYLON BRAID WHITE	S6146PS	PFD HI-BACK P-BLUE (W) PS
RH038WHT	LINE 3/8" STRAIT-CORE POLY	S6146XSS	PFD HI-BACK P-BLUE (W) XSS
RH112WHT	LINE 1/12" NYLON BRAID WHITE	S6147MLG	PFD HI-BACK MANGO (W) MLG
RH316WHT	LINE 3/16" YACHT BRAID-WHT w/B	S6147PS	PFD HI-BACK MANGO (W) PS
RH516WHT	LINE 5/16" STRAIT-CORE POLY	S6147XSS	PFD HI-BACK MANGO (W) XSS
RM014BLK	LINE 1/4" SPUN DACRON - BLACK	S6148LXL	PFD FISHERMAN MANGO LXL
RM014BLU	LINE 1/4" SPUN DACRON - BLUE	S6148SMD	PFD FISHERMAN MANGO SMD
RM014RED	LINE 1/4" SPUN DACRON - RED	S6148XXL	PFD FISHERMAN MANGO XXL
RM014WHT	LINE 1/4" SPUN DBL BRD - WHITE	S6149LXL	PFD FISHERMAN CACTUS LXL
RM038BLK	LINE 3/8" SPUN DACRON - BLACK	S6149SMD	PFD FISHERMAN CACTUS SMD
RM038BLU	LINE 3/8" SPUN DACRON - BLUE	S6149XXL	PFD FISHERMAN CACTUS XXL
RM038RED	LINE 3/8" SPUN DACRON - RED	S6779R	PFD INFLATABLE REARM KIT
RM038WHT	LINE 3/8" SPUN DBL BRD - WHITE	S6779RG	PFD INFLATABLE RED/GRAY
RM516BLK	LINE 5/16" SPUN DACRON - BLK	S6779TG	PFD INFLATABLE TAN/GRAY
RM516BLU	LINE 5/16" SPUN DACRON - BLUE	S6780RG	PFD BELT PACK INFLATABLE RED/G
RM516RED	LINE 5/16" SPUN DACRON - RED	SBV3120YEL	PFD CHILD (30-50LB) RED
RM516WHT	LINE 5/16" SPUN DBL BRD-WHITE	SBV3122YEL	PFD YOUTH (50-90LB) RED
RM716BLK	LINE 7/16" SPUN DACRON - BLACK	SP150041	SHACKLE 5/32 X 3/8 X 5/8
RM716BLU	LINE 7/16" SPUN DACRON - BLUE	SP150051	SHACKLE 3/16x1/2x11/16
RM716RED	LINE 7/16" SPUN DACRON - RED	SP150052	SHACKLE 3/16 x 5/8 x 5/16
RM716WHT	LINE 7/16" SPUN DACRON - WHITE	SP150053	SHACKLE 3/16 X 5/8 X 1-7/16
RS014BLK	SHOCKCORD 1/4" BLACK	SP150061	SHACKLE 1/4x9/16x15/16
RS018BLK	SHOCKCORD 1/8" BLACK	SP170005	SHACKLE TWISTED SS 3/16
RS038BLK	SHOCKCORD 3/8" BLACK	SP170006	SHACKLE TWISTED SS 1/4
RS316BLK	SHOCKCORD 3/16" BLACK	SP180005	SHACKLE KEY PIN 3/16"
RS516BLK	SHOCKCORD 5/16" BLACK	SP180006	SHACKLE KEY PIN 1/4"
RS716BLK	SHOCKCORD 7/16" BLACK	SP185205	SHACKLE KEY PIN 3/16"
S6142LG	PFD WEDGE-E LG	V1093	SCREW-IN DECKPLATE 5" CRVD WH
S6142MD	PFD WEDGE-E MD	V1130	SCREW-IN DECKPLATE 4" CRVD WH
S6142SM	PFD WEDGE-E SM	V1131	SCREW-IN DECKPLATE 4" CRVD BL
S6142XL	PFD WEDGE-E XL	V1145	SCREW-IN DECKPLATE 6" WHITE W
		V1146	SCREW-IN DECKPLATE 6" BLACK W/

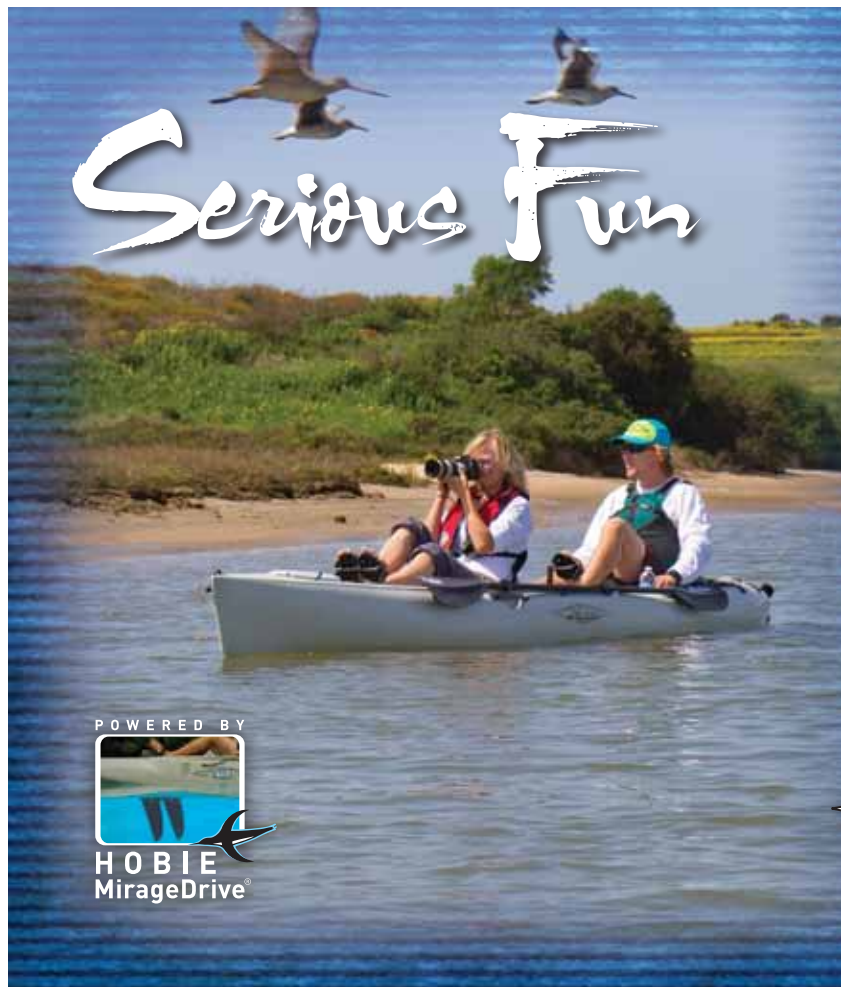

# Serious Fun

POWERED BY



## It's Mother Nature's Show—But We Make the Front Row Seats.

Propelled by the patented MirageDrive,<sup>®</sup> Hobie's pedal-driven Mirage line of sit-on-top kayaks leaves your hands free for binoculars, a camera or a cool drink.

The MirageDrive employs twin underwater "flippers" that work much like a penguin's fins. The back-and-forth motion from each pedal cycle propels the boat smoothly, effortlessly and virtually silently. And the best part—no noisy paddles to scare away the wildlife.

Hobie Mirage Kayaks are available in single and tandem models, in both rigid and inflatable styles.

From the Everglades to the shoreline of Puget Sound, Hobie has the perfect kayak for your next adventure.





**HOBIE CAT COMPANY**

Oceanside, California U.S.A.  
1-800-HOBIE-49  
hobiecat.com

**HOBIE CAT AUSTRALASIA**

Huskisson, New South Wales Australia  
1-800-4-HOBIE  
hobiecat.com.au

**HOBIE KAYAK EUROPE**

Stellendam, The Netherlands  
+31 (0) 187 499 440  
hobie-kayak.com



**PARTS & ACCESSORIES**

87367006