



**KAYAKING / FISHING • PARTS & ACCESSORIES • FALL 2010**



**PARTS & ACCESSORIES**





# HOBIE ALTER. SIX DECADES OF BUILDING MEMORIES

How did Hobie Cat creator Hobart “Hobie” Alter put us all on the water? He **STARTED** with **FUN**... then he kept on going. It wasn't about building boats. It was about building **MEMORIES**.

The “Flying H” logo is global shorthand for ease and performance on the water. As you'd probably guess, that sort of international reputation didn't happen overnight.

Like all good tales, the history of Hobie Alter started with a dream. In the 1940's, Hobie saw the bluff-lined coves of Laguna Beach as a setting for adventure. Skimboards, paddleboards, surfboards, skiffs... the locals took their homespun designs as far as they could. But Hobie envisioned lighter, more maneuverable ways to play in the waves.

In the space of a decade—and thanks to his introduction of the foam surfboard blank—his boards became the favored equipment for everybody from local heroes to world champions. Today, Hobie surfboards are found at retailers around the globe and under the feet of some of the best surfers around.

In the '60s, Hawaiian-style outrigger canoes had become common at spots like Malibu. Small catamarans were seen as well, but they were too unwieldy for single-handed beach launching. Hobie got to work with fellow beach boat aficionado Phil Edwards. They came up with a design that changed the face of sailing—the Hobie 14. Adding an elevated fabric trampoline, asymmetrical hulls and a high-speed rig, the fun quotient was upped by orders of magnitude. The design opened up high-speed sailing to just about anyone.

The Hobie 16 appeared quickly thereafter. Whip-fast and user-friendly, the 16 gained huge media acclaim and international attention. With its exotic profile, trapezes, and eye-catching sail graphics with themes like “Tequila Sunrise,” the Hobie 16 became the most popular one-design sailing multihull in the world. The Hobie Cat was here to stay. Nowadays, if there's a body of water big enough to have a name, there's an active Hobie fleet calling it home.

Soon enough, new Hobie models rolled out. The Hobie 18. The ultra-light Hobie 33 monohull. The Hobie Power Skiff. A veritable flotilla of kayaks. Hobie's reach grew by leaps and bounds: Skateboards, polarized sunglasses, apparel... all built around fun in, on, or near the water.

While the history is compelling, the Hobie name has never been more timely. Our groundbreaking introduction of the MirageDrive™ pedal-driven propulsion system is the key. With the paddle relegated to back-up status, it's hands-free fun on the water. And with a deep line-up of recreational, touring, fishing, and sailing kayaks, Hobie leads the way. Today, there's literally a Hobie for everyone.

There's hardly a fisherman alive who isn't familiar with the Hobie Fishing Collection, featuring the Hobie Mirage Pro Angler, a purpose-built platform perfect for getting into the mangroves, out to the kelp, or across the shallows to your favorite Monster Hole. And with 600 pounds of capacity, you can bring every tool in your kit. With a huge fleet of fishing kayaks, nobody matches Hobie's range of angling possibility.

**Whether it's kayaking, fishing, or sailing, Hobie has you covered. Welcome to the Hobie family. Go ahead. Build some memories.**

Note: Freight to dealers is not included in pricing.



<b>ITEM</b>	<b>PAGE</b>
T SHIRTS / HATS / LOGO GOODS	2-3
WATER WEAR	4-5
LIFE VESTS / PFD	6-7
SAFETY	7
Hobie eVolve Electric Motor Kit	8-9
SIDEKICK AMA	10
ST TURBO FINS	10
SUN BIMINI / DODGER	12
SAILING KITS	14-15
ISLAND TRAMPOLINES	15
DRIFT CHUTE	16
ANCHOR TROLLEY	16
ROD LEASH	16
STAKEOUT POLE	16
ACCESSORY PACKS	16 & 23
ROD HOLDER EXTENSIONS	17
LIVWELL	18
HATCHES / GEAR BUCKETS	19
DRY BAGS	19
FISHING ROD HOLDERS	20-21
ELECTRONICS	22-23
COMPASS	23
DOLLY CARTS	26
TRAILER	27
STORAGE BOX	27
RACK PADS / STRAPS	27
MIRAGEDRIVE BAG	28
BAGS	28-29
MISC ACCESSORIES	30-31
REPAIRS / MAINTENENCE	28-31
TOOLS	31
HARDWARE	31-33
KAYAK SUPPORT	35
KAYAK FAQ	35
WARRANTY INFO	35
LIVWELL PARTS	35
PARTS DIAGRAMS	35-44
NUMERICAL PARTS LIST	45-48



**HATS WITH "HOBIE FISHING" 5023PP / 5023TO / 5023TS / 5023VS**

5023TS  
Boa



5023TO  
Oar Washed



5023PP  
Pumpkin



5023VS  
Visor



**HOBIE HATS** Hats with Hobie "H" in contrasting color and "Hobie" on the side. Mesh versions are breathable and made from 100% Polyester. Others are 100% Cotton Brushed Twill. All but Blue/Gold have embroidered logo raised and back shadowed.

**5019BK** Black Low Pro

**5018BK** Black

**5018GM** Gray Mesh

**5018TG** Tan Green

**5018RM** Red Mesh

**5018BL** Blue



5019BK  
6 Panel  
Low Pro



5018BK  
Black



5018GM  
Gray Mesh



**LID LATCH** Don't let that fancy new hat blow away. Secure it to your shirt or life vest with a Lid Latch.

**1553L**



5018TG  
Tan Green



5018RM  
Red Mesh



5018BL  
Blue



**5130XX** Hobie Mirage Kayaking (Gray)

**5129XX** Hobie Mirage Kayaking (Black)

**5131XX** Hobie Mirage Fishing (Tan)

**HOBIE "T" SHIRTS** All shirts are 100% cotton with screened graphic designs on the back and chest.  
(xx = size) md, lg, xl [xxl available in fishing version]

**HOBIE SUNGLASSES** Hobie® Polarized Sunglasses are designed to improve your vision by eliminating glare, a problem that has been around since the first sunrise. Once you wear Hobie sunglasses you will never want to be without them!

By cutting all glare, our sunglasses make it easier to see the wind on the water, the fish in the water and any obstacles in your way.

When you put on Hobies it's like a vacation for your eyes! See the complete line of Hobie Sunglasses at [hobiepolarized.com](http://hobiepolarized.com)

**OCEANSIDE - 1563BLK**



**PLAYA - 1562BLK**



**HOBIE CROAKIES** Keep your glasses in place! Made from wetsuit fabric that will not stretch or lose shape when wet. Remains secure whether worn normally, raised, or lowered.  
**1553CR** Each



**BOOK - FROM PENGUIN WINGS TO BOAT FLIPPERS** Great book about taking ideas from nature to use in products. All about the Hobie Mirage pedal system. Written by Toney Allman from the series "Imitating Nature".  
**615** Each



**HOBIE KEY FLOATS** Don't lose those keys! Keep a few bucks dry, inside the small compartment, while on the water.  
**72010 EA**



**HOBIE FISH THE WORLD - DVD** Join us as we fish Australia, France, Holland, the Oxbows of the Mississippi, the Lower Owens in the Eastern Sierras, the Louisiana bayous, North Carolina, Corsica, and down the west coast of Baja Mexico.  
**84431001** Each



**SPORTS BOTTLE** Show your Hobie spirit with the "just right" size sports bottle.  
**71999011** 16oz  
**71997001** 18oz  
**71998001** 32oz  
(Check parts pages for correct bottle fit)  
**STAINLESS WATER BOTTLE**  
**71995001** 20oz

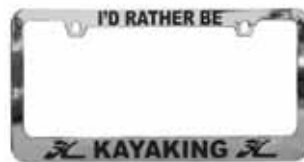

**LICENSE FRAME "KAYAKING"**  
**3044** Chrome



**LICENSE FRAME "HOBIE"**  
**3043** Chrome



12451031



12451050 / 12451051



36601000 / 36601011 / 13001001



12453021



12453011



12453031



79545001

**STICKERS**

- 12451031** "Hobie Diamond w/ Script" 36"
- 12451050** "Script" Black 24"
- 12451051** "Script" White 24"
- 12453011** Hobie Kayaks 5 1/2"
- 12453021** Hobie Kayak Fishing 5 1/2"
- 12453031** Hobie "Teq Sunrise" Dome 4 1/2"
- 13001001** Hobie "Flying H" Black 12 5/8"
- 36601000** Hobie "Flying H" Black 6"
- 36601011** Hobie "Flying H" White 6"
- 79545001** Hobie "H" Dome 2 1/4"



# HOBIE WATER WEAR

Be more comfortable and extend your kayaking / sailing season by dressing appropriately for the conditions. Mix and match layers to get the comfort you desire. Hobie water wear is designed for both kayaking and sailing needs.



**HOBIE SPRAY TOP** Designed for active kayaking and sailing. Can be worn with swim trunks or over a wetsuit. Mix and match layers to get the comfort you desire. Spray and wind protection. Beautiful styling and extra durable construction. Construction Features: Neck and wrist seals, Neoprene waist seal, Breathable 5000cm<sup>3</sup> nylon shell, Offset chest pocket, Arm patch pocket.

## HOBIE SPRAY TOP

3850SM / 3850MD / 3850LG / 3850XL



**HOBIE RASHGUARD** for comfort inside your wetsuit and great sun protection when you don't need a wetsuit. This short sleeve design and a high turtle neck style is ideal for any watersport where you need to be more comfortable in your wetsuit, the Lycra material with its 4 way stretch and tight fitting design will let your wetsuit slide on easy when you are getting ready and gives you more freedom when on the water. Raglan sleeve design allows the wetsuit to move so you do not get rubbed and sore – hence the name RASHGUARD – does what it says! The high neck Turtle neck design protects your neck from being rubbed by the suit when in salt water and a sand environment.

UV protection – this top is rated at 50+UPF which gives you the **MAXIMUM PROTECTION FROM HARMFUL UV RAYS** – stopping over 98% of the rays getting to your skin! Ideal for use with board shorts on very hot days in exotic locations – so if you are off to the Caribbean in the winter make sure to pack your Hobie Rash Guard. Construction – Made from 8oz Spandex Lycra with 4 way stretch and feature overlapped seams which are strong and robust. Limited to sizes shown.

## HOBIE RASHGUARD – SHORT SLEEVE

3851MD / 3851XL

## HOBIE RASHGUARD – LONG SLEEVE

3852MD



*Hobie*

**HOBIE "FULL" WETSUIT** 3mm/2mm For colder days. Add the Hobie Spray Top to further extend the cold weather comfort range. Add a rash guard for chafe protection. Vertical back zip entry.

**FEATURES:** Anti-choke neck, Armortex knees, Lumbar Flex Zone . **CONSTRUCTION:** 100% Dura Flex with mesh chest and back panels, Glued, Blindstitched seams.

**HOBIE FULL WETSUIT – 3/2 RED/BLACK**

3854SM / 3854MD / 3854LG / 3854XL

**HOBIE FULL WETSUIT – 3/2 BLACK**

3856MD / 3856LG / 3856XL

HOBIE "FULL" WETSUIT



HOBIE "SHORTY" WETSUIT



**HOBIE "SHORTY" WETSUIT** 2mm/2mm Great comfort for spring-like conditions. Add the Hobie Spray Top to further extend the cool weather comfort range. Add a rash guard for chafe protection. Vertical back zip entry. **FEATURES:** Anti-choke neck, Armortex seat, Lumbar Flex Zone. **CONSTRUCTION:** 100% Dura Flex with mesh chest and back panels, Glued, Blindstitched seams.

**HOBIE – SHORTY 2/2 BLACK**

3855SM / 3855MD / 3855LG / 3855XL

**HOBIE – SHORTY 2/2 RED/BLACK**

3853SM / 3853MD / 3853LG / 3853XL

MEN	SIZE	HEIGHT		CHEST		WAIST	
		Ft/In	Cm	In	Cm	In	Cm
	48 S	5'7" - 5'9"	171 - 177	37-40	94-101	30-32	76-83
	50 M	5'9" - 5'11"	175 - 181	39-42	99-106	32-34	81-88
	52 L	5'11" - 6'1"	179 - 186	41-44	103-110	34-36	86-93
	54 XL	6'0" - 6'2"	183 - 189	43-46	108-115	36-38	91-98

**HOBIE GLOVES** protect your hands while increasing your grip strength. Gloves add grip strength on lines which can ease up on the amount of force you need to exert. Available in small, medium, large & extra-large. (xx = size)

**3188XX** HOBIE GLOVE



**THUNDERWEAR COLD WEATHER GLOVES** Full fingered glove for watersports. Made of Neoprene and Thunderhide, an amazing synthetic leather that is completely wetttable and washable. Keeps your hands warm. These gloves run large and are men's sizes. Available in extra-extra small, extra-small, small, medium, large & extra-large. (xx = size)

**3187XX** Gloves







**HOBIE HI-BACK MESH** by Stohlquist

This front entry vest was designed just for Hobie Kayaks! The flotation in the back is up high and away from the seatback (less bulk down low). Short length does not "ride up" around your neck when you are sitting. There is a mesh panel across the back. Front zip entry for easy on and off. A zipper keeper to prevent the zipper from slipping down when in use. Large mesh pockets on the front for easy storage and access of small items. Stretchy neoprene adjustable padded shoulders. Ventilated mesh side panels. High waistline cut. Huge arm cutouts and a short waist allow excellent freedom of movement. Adjustable side straps offer enough size variation for many layers underneath or none!

SMD / LXL / XXL (Mango Yellow or Forest Green)

**S6143XXX MANGO** (xxx = size)

**S6144XXX GREEN** (xxx = size)

(UL - Approved) for use in USA Only

**S6145XXX ULC - MANGO** (xxx = SMD / LXL)

(ULC - Approved) for use in Canada Only

S6143-4-5 Sizes (Chest) SMD 30" - 42" / LXL 42" - 52" / XXL 30" - 54"



BACK FLOTATION ABOVE SEAT BACK

**SAFETY TIP!**

**LIFE VESTS** Get a good, comfortable life vest and WEAR IT! A life vest does you little good stored on your boat, especially if you get tossed into the water and away from your boat. Accidents happen and by their nature, they happen when you are not prepared. A life vest can keep you afloat until you can rescue yourself or you can be rescued by others. In the worst cases when injuries or cold water are involved, your life vest can make all the difference! Be sure everyone onboard your boat wears a life vest too! Pass the word! Federal law now requires that all persons below the age of 13 must wear a life jacket while aboard a boat.



**WOMENS HOBIE HI-BACK** by Stohlquist

Many of the same features as the Hi-Back Mesh, but shaped and contoured specifically to fit Women. Foam layering inside the vest is contoured for a better fit.

XSS - MLG - PS (Powder Blue)

**S6146XX POWDER BLUE** (xx = size)

S6146 Sizes  
XS/S 30" - 36" (chest)  
ML 36" - 42" (chest)  
Plus Size 40" - 46" (chest)

**HOBIE INFLATABLE PFD**

Light weight and comfortable. Ready when you need it - manual inflation. Manual inflator allows for swimming, wading and intentional immersion.

Available in Red/Grey or Tan/Grey.

**S6779RG RED / GREY**

**S6779TG TAN / GREY**



- Buoyancy: 26 Pounds
- Inflator Type: Halkey Roberts 3F
- Primary Inflation: MANUAL
- Auxiliary Inflation: Oral
- Size and U.S.C.G. Wearer Requirements
- Adult Universal: For persons 16 years or older, weighing more than 80 lbs., with chest size of 30 - 52 inches
- U.S.C.G. Approval Type: U.S.C.G. Type III
- Durable Ripstop Nylon Front Shell
- Waist Belt Width: 1"
- Zippered External Pocket

**S6779R PFD INFLATABLE REARM KIT**



**INFLATABLE BELT PACK PFD** Extremely lightweight and comfortable belt carried PFD design is cooler and more comfortable than typical PFDs. Note: Requires user to remove vest from pouch, fit on body and manually inflate. Functional design for multiple types of water sports from fishing, kayaking, sailing to stand up paddling (SUP). Belt pack style stays out of the way till you inflate and put the bladder on over your neck. Adjustable waist. Whistle on tether. Buoyancy: 26 Pounds. USCG Approved Type III PFD, approved for use by persons 80 lbs and 16 years of age or older. Size: Universal Adult Size. Durable ripstop nylon pack. 2" wide, adjustable, nylon waist belt. Includes (1) CO2 Cylinder and instructions.

**S6780RG RED/GRAY**





**HOBIE SHORT-PROFILE VEST** by Stohlquist

This side entry design has set the standard for streamlined pfd fit. Cool mesh side panels and reflective accents. Stretchy neoprene adjustable padded shoulders. Roomy mesh pocket with "D" ring for keys. Ventilated mesh side panels. High waistline cut. Huge arm cutouts and a short waist allow excellent freedom of movement. Extra short length does not "ride up" around your neck when you are sitting. Adjustable side straps offer enough size variation for many layers underneath or none! SM / MD / LG / XL / XXL

(UL - Approved) for use in USA Only

**S6142XX** (xx = size)

S6142
Sizes (Chest)
Small 32" - 36"
Medium 36" - 40"
Large 40" - 44"
XLarge 44" - 48"
XXLarge 48" - 52"



**STEARNS' CHILD/YOUTH VESTS**

Our children's life vests meet the same functional requirements as those for adults. We've selected the, easier to put on, three clip

model. These are easy to adjust for different size crews. (Vest colors vary)

**SBV3120YEL** 30 to 50 lbs

**SBV3122YEL** 50 to 90 lbs



**HYDROSTAR - S.O.S DELUXE "HOBIE"** Whether you're paddling, sailing, camping, fishing, hunting or just changing your tire the Hydrostar offers an unmatched combination of features that makes it a must-have for all your water sports, outdoor and travel needs. Everything you need for lighting in one compact waterproof package. The versatility of this multifunction design includes a flashlight with two brightness settings, a Xenon strobe, a pre-programmed S.O.S. signal and a red/green marker light. A wide suction cup base with bungees allows the S.O.S. Deluxe to secure easily to any deck configuration, while the magnetic socket keeps the light firmly seated in the suction cup base. Use the S.O.S. Deluxe in your tent, on your PFD, on your deck, on the trail, or even use the magnetic base to turn the S.O.S. Deluxe into a great distress light on the roof of your car. All HydroStarsTM are waterproof to -50ft and batteries are included.

**72020003** HYDRO STAR SOS LIGHT

**Hydro Star Features:**

- 2-way LED FLASHLIGHT
- Emergency XEON STROBE
- Programmed S-O-S SIGNAL
- Waterproof up to 50 feet

**Suction cup base**

- Strong magnetic base
- Twist action control switch
- Safety leash
- Batteries included



**BILGE - HAND PUMP** Water over the bow while you have a hatch open can leave you with a flooded hull. This light weight pump is security for long trips on the water. Features super-comfortable, easy-grip rubber overmolded handle and a high-visibility neon yellow stock for extra safety.

**72020032** BILGE - HAND PUMP



**SAFETY FLAG** Be Seen! When out on your kayak, you are very low to the water. Add to that any wave or swell action and you are often hidden from other boaters view. The 4' tall safety flag will help other boaters see you. Very important in areas with mixed boating traffic! For mounting in areas with internal access, you can use large washers and the provided nuts for mounting. Otherwise, in areas with no internal access, use the mount which includes bolts and well nuts.

**72020002** SAFETY FLAG 4'

**72020012** DELUXE MOUNT



MOUNT



**HOBIE SAFETY KIT** has many useful items for added safety when boating. Includes first aid and some basic survival materials. Hobie Gear Bucket with Orange safety lid. Ready access is assured by hanging the safety kit on the inside lip of an 8" Hobie Twist-n-Seal hatch. Includes a 33 piece first aid kit, water proof flash light, signal mirror, space blanket, whistle, utility tool, waterproof matches, duct tape, gauze bandage, gauze pads, cloth tape (specific items subject to change).

**72020010** HOBIE SAFETY KIT

**TELESCOPING PADDLE** is a good spare paddle that can be stored within most Hobie kayak models. 6 1/2" wide blade will fit into an 8" hatch opening. Measures just 20" in closed position (45" when fully extended). Lightweight, easily portable yet with durable construction of high grade plastic paddle and anodized aluminum shaft. Corrosion resistant design. Floats too!



**3091** Each



## HOBIE eVOLVE POWERED BY TORQEEDO

Whether you're augmenting your MirageDrive or using the Hobie eVolve as your primary power source, this quiet and efficient electric motor will dramatically expand your horizons. Maybe there's a ripping tidal current or a series of fast-flowing eddies that you must negotiate before reaching that pristine shoreline. Maybe it's a bay that's always been a *little* too far explore. Or maybe it's just been a long day and your tired muscles could use a break. Either way, the clean, quiet, eVolve system is there for you.

This tidy German-engineered electric motor kit fits any MirageDrive kayak and it comes with two mounting options—one midship, the other stern hung. With the Hobie eVolve, you can either maintain steady cruising speeds of two knots (motor only) for hours, or you can open the throttle for short sprints. Best yet, depending on your set-up, you can use the eVolve to augment your boat speed while also using your MirageDrive. And thanks to its cockpit-mounted Remote Throttle, you always know how much juice you have left in the system's 230wh Lithium-Manganese battery.

If you thought the MirageDrive made kayaking sweeter, wait until you try the eVolve system. Life only improves with power.

### KIT INCLUDES:

- Ready-to-go Mirage well-mounted Hobie eVolve
- All cables for the motor and throttle units
- All mounting hardware
- Assembly that integrates the motor with a Twist and Stow rudder
- Sealed/Waterproof Lithium-Manganese high-performance battery (charger included)
- Remote throttle system displays speed and distance information generated by an onboard GPS unit
- Magnetic safety key
- Waterproof fittings and cable connectors
- Corrosion-resistant materials ensure durability and performance
- Lightweight power: Total weight of installed kit is 18 lbs (8.16 kg) or less, depending on the configuration

## 2 FOR 1

**BOTH MOUNTS INCLUDED**

For all Mirage Series except no Rudder Mount for Pro Angler and Inflatables



### RUBBER POSITION MOUNT

The rudder-mounted eVolve is the ultimate tool for extending your range and exploration options. This slick system uses a lightweight aluminum assembly to easily integrate an eVolve motor with a Twist and Stow rudder. Pedal and motor; motor, or simply pedal. When off, the engine becomes your rudder or it can be brought on deck via the Twist and Stow controls. (Rudder Mount not included in kit for Pro Angler and Inflatables.)



### MIRAGE WELL MOUNT

A clever option for mounting the eVolve motor package is to swap out your MirageDrive for this electric unit. Just slot the well-mounted Hobie eVolve into any MirageDrive kayak and instantly enjoy powered propulsion. Ready to use fresh out of the box, the Mirage-mounted eVolve weighs a scant 6.4 pounds—that's 0.2 pounds less than the MirageDrive—and is built to take years of exploration and adventure.





### REMOTE THROTTLE

While the outboard might be transom-hung, the driver doesn't have to sit astern thanks to our Remote Throttle, which attaches via a RAM mounting unit (included) to provide throttle control from your favorite seating position. The LCD screen displays all the trip info you need (such as speed and range) while you're underway. For safety, the unit features a magnetic key-to-throttle connection; break this magnetic connection and the motor immediately stops.



### LITHIUM BATTERY

A lightweight, 6.6-pound, 230wh Lithium-Manganese battery (8Ah at 28.8V) powers the system's featherweight Torqeedo motor. The battery is buoyant and completely waterproof, ensuring safety and there-when-you-need-it performance. Its built-in GPS unit generates pertinent information such as speed and range.

# ST PERFORMANCE FINS ST OR ST TURBO!



**ST FINS** ...and you thought the Hobie MirageDrive was the most amazing propulsion system ever seen! Now you can make your Hobie MirageDrive a **SUPER PERFORMER!**

Hobie Mirage kayak users report as much as 10% increase in speed and more using ST TURBO Fins. But its not all about speed, you can get top end speed and a slower cadence for cruising (Less pedals per mile). All achieved with these larger and more efficient fin designs. Increase your performance or increase your fitness routine, you choose the fin that is right for you: Standard, ST or ST Turbo... low, medium or a higher gear! The standard fins, supplied with our kayaks, are the easiest pedaling fins, but many users feel that the standard fins do not offer enough resistance. This is very evident when using our sailing kits. The added power and speed of the sail often outpaces the standard fins (similar to pedaling a bike down hill in first gear). Want to go really fast? Add the ST TURBOs for sailing! The longer fins can also increase lateral resistance for sailing upwind.

These ST (Square Tip) designs will require a bit more effort to pedal. *The added effort is commonly compared to pedaling a bike up a slight incline.* In addition, the included fin tension screw allows adjustment to achieve lower end torque or top end speed to meet the desires of the pedaler.

ST Fins fit any Hobie MirageDrive. If you prefer the ST fin, order 2 per drive. The ST TURBO fins require longer masts. The ST TURBO fin kit comes with 2 fins, 2 masts and all needed fittings.

- 81193001** ST Fin / Single (Requires 2 per MirageDrive)
- 72065** ST TURBO Fin Kit Complete (Older SS or Set-screw Sprocket)
- 72066001** "V2" ST TURBO Fin Kit Complete (2009 - Threaded Sprocket)
- 80013001** MirageDrive with ST Turbo fins
- 81192001** ST TURBO Fin / Single (replacement)



## SIDEKICK AMA KIT

Whether you are a pro or a novice, you will enjoy the sense of security from the extra amount of stability offered by the SideKick ama kit. Great for use when sailing, fishing, standing when site fishing, shooting photos! The SideKick ama kit is simple, light weight and effective! The SideKick's cross arms adjust the float height with a simple "click-twist-click". Just like a paddle shaft adjustment. Three positions offer you high - medium - low positions. Set the floats high for cruising (less drag) or secondary stability. Use the medium or low settings for primary stability (less initial roll). Fine adjustments for float height are done by twisting the main crossbar within its mounts and tensioning with the fastening hardware. Set up and use right off the beach or disassemble and deflate to store inside the hull. Then assemble and inflate when you get to your dive or fishing spot. Inflation is simple. Just blow a few breaths into each float through their one-way valves. Valve cap unscrews for rapid deflation. Installs with 4 bolts using expanding nuts.

- 72062101** SIDEKICK AMA KIT - Light Gray
- 72063101** SIDEKICK AMA KIT - Dark Green
- 72062061** SIDEKICK +07 ADVENTURE MOUNTING ADAP PLATE SET
- 72062062** SIDEKICK - MOUNT KIT W/CENTER BAR



**SIDEKICK AMA KIT** Extra stability for your kayak. Fits all Hobie models and most other kayaks. Whether you sail, fish, shoot pictures, dive or just want to feel a bit more stable when using your kayak, the SIDEKICK AMA KIT will do it. Light weight and simple to install. The floats are inflatable.



# Hobie



# ENJOY THE RIDE



**Hobie is thrilled to introduce an exciting new member of our fleet.**

The Hobie Mirage Tandem Island is the big brother of our Hobie Mirage Adventure Island and twice the fun. Plenty of room for the skipper and crew, with total control of the roller furling sail and the large Twist and Stow rudder from either high back padded seat. Inspired by Polynesian multihulls, this 18' 6" trimaran "sail-yak" includes state-of-the-art features and comfort, plus two patented MirageDrives with Turbo Fins. So choose a partner and enjoy the ride.

POWERED BY



**HOBIE**  
MirageDrive®

[hobiecat.com](http://hobiecat.com)

 **H O B I E**



# HOBIE BIMINI SUN SHADE

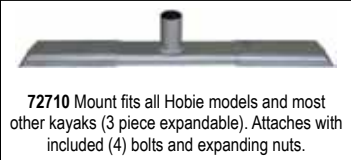

**72710** Mount fits all Hobie models and most other kayaks (3 piece expandable). Attaches with included (4) bolts and expanding nuts.

We all love the sun, but it can be a bit much at times. Protect yourself with a Hobie Bimini Sun Shade. The Bimini is easily attached to most Hobie Kayaks. With the Hobie mount installed, a simple flick of a finger can attach, adjust or remove the Bimini. It can be easily folded out of the way or set up to block the sun. Simple adjustments can tilt the shade from side to side or to different heights and angles for best protection from the sun's rays. Requires Hobie mount. The Hobie Mount will attach to just about any kayak. It extends or retracts for a perfect fit.



## HOBIE BIMINI SUN SHADE (\* Requires mount)

**72700** Bimini Charcoal\*

**72701** Bimini Blue\*

**72702** Bimini Green\*

**72710** Hobie Mount

# HOBIE DODGER

The Hobie Dodger is a spray, cool breeze or sun shade for your lower body.

Deflect bow spray, block cool breezes and stay warmer in cold conditions.



Works like a small pop-up tent. Loops of bungee connect to the boat via small fittings installed along the rails. Small internal battens give the Dodger its shape. The Dodger extends aft to just in front of the pedaler. A Velcro strip seals up the center in front of the pedaler. The entire dodger folds forward to enter or exit the kayak, to make pedal adjustments or reach items in the cockpit. An access panel is built-in for using the sailing rig. A great combination when there is wind and spray!



Great for hunters, animal and bird watchers as the Dodger conceals your legs movement. The Hobie Dodger makes your kayak a sit-inside sit-on-top!

Installs in minutes initially, but installs in moments once the fasteners are in place. Packs away into a small stow bag 5" round by 24" long (1.8 lbs).



## HOBIE MIRAGE DODGER

**72720** Dodger Camo

**72721** Dodger Silver

**72722** Dodger Yellow

## HOBIE PRO ANGLER DODGER

**72730003** Pro Angler Dodger Camo

## HOBIE ISLAND DODGER

**72730001** Island Dodger Yellow

**72730002** Island Dodger Silver

Tandem Island:  
Island Dodger forward / Mirage Dodger aft

*Mirage Dodger Fits the Hobie Mirage Outback, Sport, Adventure and Revolution kayaks (May fit other models with some modification to hardware placement).*





# STILL THE BEST RIDE



## THE GETAWAY

*The Hobie Getaway is the social boat of Hobie Cat's Rotomolded catamaran line. With significantly more hull volume than the ever-popular Hobie Wave, plus huge carrying capacity, the Hobie Getaway comfortably accommodates six adults. Or take the whole family out for a comfortable evening cruise. A lot of boat at a tremendous value, the Hobie Getaway is designed to withstand rigorous use and provide years of sailing enjoyment for the entire family. The Hobie Getaway... serious performance in a very playful, manageable boat.*

### **SPECS:**

**Length:** 16' 7" / 5.04 m  
**Beam:** 7' 8" / 2.34 m  
**Draft Rudder Up:** 10" / 0.25 m  
**Mast Length:** 25' / 7.62 m  
**Sail Area:** 180 sq ft / 17 sq m  
**Weight:** 390 lbs / 177 kg  
**Max Load:** 1000 lbs / 453 kg



1-800-HOBIE-49

[hobiecat.com](http://hobiecat.com)

 H O B I E



# SAIL KITS



## ADD SAILING TO YOUR HOBIE MIRAGE KAYAK EXPERIENCE!

**MIRAGE KAYAK SAIL RIG** Add sail power to Hobie Mirage Kayaks! (Fits all current models of Hobie Mirage Kayaks). The Patented MirageDrive pedal system allows you to pedal while sailing which helps you to maintain forward motion through turns and obtain higher speeds. Sail with ease maintaining excellent speed with or without pedaling while sailing. Easily pedal out to sail or pedal home when the wind is too light. Add a SideKick ama kit for additional stability if desired.

### HOBIE MIRAGE KAYAKS... THE ONLY KAYAKS THAT CAN DO IT ALL

Paddle kayaks do not have the necessary lateral resistance needed nor do they typically have a rudder for steering. Paddle kayaks require hands-on paddling which prohibits use of rudder and sail controls for sailing. The MirageDrive pedal system allows you to pedal out onto the water to sail and pedal back if needed. You can also pedal the boat through a tack (turn). The MirageDrive pedal system's fins act as a keel or centerboard when in the down position offering the lateral resistance needed for upwind sailing. Hobie Mirage kayaks are equipped



For top sailing performance, add the ST TURBO fin kit and larger rudder!

with a hand-controlled rudder. The MirageDrive allows hands to be free for sail and rudder controls. Two piece mast, sail, hardware, lines and durable storage bag included. Add the large rudder #81397001 for more responsive rudder control. Adventure models can add the dagger board for enhanced upwind performance.

**SAIL KIT** includes two piece mast, sail (20.25 sq ft.), lines, fittings and storage bag.



i-Series 79052203  
84515001

i-Series 79052204  
84516001

84514001

84513001

**84513001** Sail Kit (Turq/Papaya)

**84514001** Sail Kit (White/Red)

**84515001** Sail Kit (White/Turq)

**84516001** Sail Kit (Silver/White)

**79052203** i-Series Sail Kit (White/Turq)

**79052204** i-Series Sail Kit (Silver/White)

**81397001** "Sailing" Rudder Blade (Lg TnS)

**81397101** "Sailing" Rudder Blade i-Series

**79502001** Adventure Sailing Daggerboard

**84503** Replacement 2-piece mast

**79052251** Replace (i-Series) 4-piece mast

**84511** Replacement Sail Batten

**84509001** Replacement Batten Cap

**RH112WHT** Batten Tie Line (per foot)



Adventure  
Daggerboard

Large Twist-n-Stow  
"Sailing" Rudders

81397001

81397101



Sailing with Dodger



Sailing with  
SideKick Ama Kit



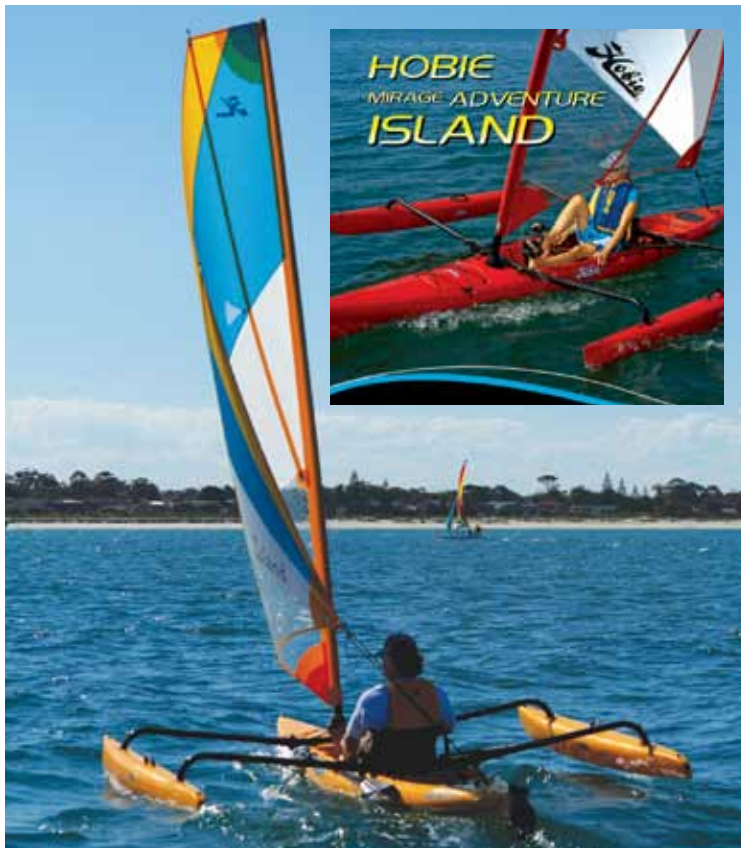

### ADVENTURE ISLAND CONVERSIONS

The Hobie Mirage Adventure (2007 model and newer only) can be converted into an Adventure Island! These kits allow you to add just the amas or go all the way to Adventure Island with the amas and sail combined. Great sailing performance and excellent stability.

The complete kit includes: A boomless, roller-furling sail rig with plenty of sail area for excellent performance, completely manageable from the cockpit with the pull of a line. Two retractable amas that fold up against the side of the boat for easy docking, maneuverability, and transport. All 2007 and newer model year Adventure Kayaks, including the Fish model, have inserts molded into the hull. The Adventure Island kit is loaded with additional standard features such as a daggerboard; large "Twist and Stow" rudder; Mast and Sail Cover; and an Aka/Daggerboard Bag.

- 99503001** ISLAND CONVERSION KIT - PAPAYA
- 99504001** ISLAND CONVERSION KIT-HIBISCUS
- 99505001** ISLAND CONVERSION KIT - DUNE
- 99600001** INSTALL TOOLS - MAST HOLE SAW

(See part guide pages for replacement sails and parts)



**AIR-FLOW TELS** Trim your sails for optimum performance. Attached air flow over sails is critical. Air flow directions are indicated by these tell tails. Made of light weight rip stop nylon (Red / Green). Attaches to sails with waterproof adhesive disks.

**334** Set of 14

### SAILING TIP!

**SAIL POWER** Watch the sail in order to pay close attention to the trim or adjustment of the sail. When the front of the sail, just behind the mast, luffs or flutters in the breeze, you lose power. To start moving, pull the sail in just enough to stop the sail from luffing or turn the boat away from the direction the wind is coming from. There are also short ribbons hanging on either side of the sail called "tell tails". The tell tails react to air flowing over the sail and will help you see that the sail is pulled in too tight or too loosely. If you pull the sail too tight you will stall the sail power. The tell tail on the back side of the sail will drop or do circles. Ease the sail out until it luffs, then pull it in just a little until it stops luffing. You will adjust the trim whenever the wind changes direction or you change course. See more on "Learn to sail the Hobie way" on our website in our "Support" area at: <http://www.hobie kayaks.com/experience/learn.html>

### AKA TRAMPOLINES



### AKA TRAMPOLINES FOR THE HOBIE MIRAGE ADVENTURE ISLAND AND TANDEM ISLAND

Aka Trampolines do many things... Added space for carrying gear, allows you to move weight outboard for better performance in windy conditions, comfortable sitting or laying down position, carry additional crew / kids / pets (does not increase basic weight capacity), reduce spray in cockpit. The trampolines are made from mesh vinyl as used on our catamaran product. Available in Grey or Black. Easy installation. Fast (side-release) buckles across aft aka make folding akas quick. Adjustable webbing straps for a tight fit. Rolls down and straps to forward aka for storage or easily slips off the aka. Paddle storage, gear pockets and lanyard grommets included. (200 Lb Capacity)



**79527001** TRAMP SET AI - BLACK

**79527011** TRAMP SET AI - GREY

**88527001** TRAMP SET TI - BLACK

**88527011** TRAMP SET TI - GREY

### REPLACEMENT PARTS

**79527101** LACING ROD

**79527201** WEB/BUCKLE ASSY



# HOBIE FISHING ACCESSORY PACKAGES

## 72020021 ULTIMATE KAYAK FISHING PACKAGE



- |   |                 |                             |
|---|-----------------|-----------------------------|
| 1 | <b>72020020</b> | <b>FISHFINDER PACKAGE</b>   |
| 1 | 71706001        | HOBIE TACKLE BOX 3 PACK     |
| 1 | 72023000        | ROD HOLDER - RAM TUBE       |
| 1 | 72020008        | ANCHOR TROLLEY KIT          |
| 2 | 72020014        | HOBIE ROD HOLDER EXTENSIONS |
| 2 | 74052001        | HOBIE ROD LEASHES           |

## 72020020 FISHFINDER PACKAGE



- |   |          |                              |
|---|----------|------------------------------|
| 1 | 72020005 | FISHFINDER - LOWRANCE X50-DS |
| 1 | 72023007 | FISHFINDER MOUNT - RAM MOUNT |
| 1 | 72020011 | FISHFINDER INSTALLATION KIT  |

## 72020033 ULTIMATE KAYAK NAVIGATION PACKAGE - COLOR GPS



- |   |          |                       |
|---|----------|-----------------------|
| 1 | 72020018 | LOWRANCE COLOR GPS    |
| 1 | 72023018 | GPS MOUNT - RAM MOUNT |
| 1 | 72020004 | RICHIE COMPASS        |

## 72020022 KAYAK FLY FISHING PACKAGE



- |   |          |                               |
|---|----------|-------------------------------|
| 1 | 72023008 | FLY ROD HOLDER - RAM          |
| 1 | 72063101 | SIDEKICK AMA KIT (DARK GREEN) |
| 2 | 72020001 | HOBIE GEAR KEEPER             |

## 72020024 MIRAGE PERFORMANCE PACKAGE



- |   |          |                           |
|---|----------|---------------------------|
| 1 | 72066001 | V2 ST TURBO FIN KIT       |
| 1 | 81397001 | LARGE TWIST-N-STOW RUDDER |
| 1 | 80030001 | SPEEDO TUBE               |

**HOBIE ROD LEASH** Keep those nice fishing rods from swimming away. Secure the rod leash to boat and rod. Quick snap connection feature allows easy detachment when needed. Webbing construction with quick connect hook or heavy duty Coil.

**74052001 ROD LEASH - WEBBING**

**74053001 ROD LEASH - HEAVY DUTY COIL**

74052001

74053001

## RAM MOUNTS AND LOWRANCE ELECTRONICS

See mount and electronics pages for details.

**ANCHOR KIT** 3 pound folding anchor, bag and 60 feet of line. (Connect to the Hobie Anchor Trolley System for best results)

**80035A ANCHOR**



**HOBIE STAKE-OUT POLE** Hold position in shallow water by inserting the Hobie Stake-Out Pole into sand or mud. Fiberglass pole with metal tip, rubber grip handle and attachment line system. (Connect to the Hobie Anchor Trolley System for best results)

**72076001 STAKE-OUT POLE**



**HOBIE DRIFT CHUTE**  
Large cone shaped "para" chute deployed in the water slows your drift in windy conditions when anchoring is not possible or desired. Design keeps chute just under the surface and fully inflated. Anchor line not included. (Connect to the Hobie Anchor Trolley System for best results)

**72020009 DRIFT CHUTE**





**HOBIE GEAR KEEPER** Keep your equipment where you left it; safe and onboard with the Hobie Gear Keepers. These low force retractor tools are ideal for gear such as pliers, dykes, lipper tools etc.

**72020000 SMALL HOBIE GEAR KEEPER 2.5oz**

Features: 36" 50lbs Breaking Strength Spectra Nylon Line, Plastic Snap Clip, 3/8" Quick Connect Split Ring.

**72020001 LARGE HOBIE GEAR KEEPER**

Features: 36" 60 lbs. Breaking Strength Nylon Coated Stainless Steel Cable, Stainless Steel Spring and Hardware, Plastic Snap Clip.



**72020025 KAYAK TRAVEL PACKAGE**

- 1 72046 ROOF RACK PADS - 36"
- 1 72042 TIE DOWN STRAPS
- 1 80045001 KAYAK CART "PLUG-IN" STANDARD

**72020026 KAYAK SAFETY PACKAGE**

- 1 72020010 HOBIE SAFETY KIT
- 1 72020002 SAFETY FLAG
- 1 72020003 HYDROSTAR LIGHT



**HOBIE ROD HOLDER EXTENSIONS**

Keep your fishing rods secure and reels higher out of the water. These fit right into the molded-in rod holders and offer a larger diameter sleeve that is deeper. Leash the holder extension to the boat and the rod to the holder using the molded eyes.

**72020014 ROD HOLDER EXTENSION**

**HOBIE LIVEWELL** This live bait tank was designed with the serious fisherman in mind. From the tournament angler to the weekend warrior, inshore or off, this livewell is capable of handling almost every fishing situation imaginable! [See Livewell page for more details.](#)

**72020007 Hobie Livewell**

**72020015 Rod Holder - Livewell**

(Rod holders include needed fasteners)

**SAFETY FLAG**

Be Seen! When out on your kayak, you are very low to the water. Add to that any wave or swell action and you are often hidden from other boaters view. The 4' tall safety flag will help other boaters see you. Very important in areas with mixed boating traffic! For mounting in areas with internal access, you can use large washers and the provided nuts for mounting. Otherwise, in areas with no internal access, use the mount which includes bolts and well nuts.

**72020002 SAFETY FLAG 4'**

**72020012 DELUXE MOUNT**



**HOBIE ANCHOR TROLLEY KIT** Easily deploy your anchor, drift chute or stake out pole over the side of the cockpit area, then move the attachment position forward or aft to hold your boat in the position desired. Easily sit facing down stream / wind at anchor. Simple pulley system and cleat allows adjustment all along one side of your boat anywhere from bow to stern.

**72020008 ANCHOR TROLLEY KIT**



**FISH GRIP** Handy fish grip in a glow-in-the-dark plastic material.

**72020019 FISH GRIP**



**72020023 KAYAK CUSTOMIZATION PACKAGE**

- 1 71115101 SCREW IN FITTINGS TOOL
- 5 71117001 CLEAT
- 5 71116001 PADEYE

# HOBIE LIVEWELL



**HOBIE LIVEWELL** Live up your day on the water with the Hobie Livewell! This live bait tank was designed with the serious fisherman in mind. From the tournament angler to the weekend warrior, inshore or off, this livewell is capable of handling almost every fishing situation imaginable! Water intake and discharge fit right into the existing scuppers in the cargo area. With a high-flow self-priming\* Attwood pump, a 6 volt sealed gel cell battery, adjustable drain, and the capability of holding up to 8 gallons of water this tank can handle almost any creature that you can squeeze into it. Ready right out of the box! Just charge and go! (\*requires forward motion in the kayak to prime pump)

Looking for somewhere to put those extra rods? No problem! Hobie has included three rod holders to make this livewell one of the most functional pieces of fishing equipment that you'll ever own. Three's not enough, you say? Well for those who are ready for anything, Hobie has left you enough room to attach two more! This is a must-have for every Hobie Angler.

**FEATURES:** Pump, On-off switch, 6 Volt sealed Gel Battery, Charger, Battery compartment with lid, Carry handle, Adjustable hold down straps, Twist-n-Seal access lid, Fully assembled / charge and go!

Custom designed to fit the Hobie Mirage Outback (Newer model w/o cooler recess), Sport, Adventure, Revolution, Pro Angler (needs 7" down tube) and the Quest.

**72020007** Hobie Livewell

**72020015** Rod Holder - Livewell

(Additional rod holders include the required fasteners)

(LIVEWELL REPLACEMENT PARTS SHOWN ON PAGE 33)





# HOBIE GEAR BUCKET



**HOBIE GEAR BUCKET** Add a drop-in "tackle box" to your 8" Hobie Twist-n-Seal hatch. These containers are 2 1/2" deep and hang on the hatch lip or can be slipped down into the hull so you can carry several. Keep one on the hatch lip for easy access. Closing the hatch presses the containers seal closed to ensure items stay in place. You can carry fishing tackle, spare parts, snacks, tools, sun screen, first aid supplies and more in these easily size-adjustable storage segments. Get the three pack with handy storage bag and pre-pack your fishing tackle for fishing different species. Be prepared when the fish start biting with easy access inside the hatch just in front of your seat.

**71704001** 8" Hobie Gear Bucket

**71706001** 3 Pack with Bag (8" Hobie Gear Bucket)

**71705001** Bag for 3 Hobie Gear Buckets



Get the three pack with handy storage bag and pre-pack your fishing tackle for fishing different species. Be prepared when the fish start biting with easy access inside the hatch just in front of your seat.

## HOBIE TWIST-N-SEAL HATCHES

**HOBIE TWIST-N-SEAL HATCHES** have a better seal. The lids also hinge open, so you never lose the lid. Designed with a cork-screw-like mechanism for closure, a simple twist of the handle opens or closes the hatch. As the screw pulls down the hatch, you get a tight seal on the "O Ring" seal against the inner cylinder. The hatch seals around the edge of the cylinder and does not have to be held down against a flat surface to seal. This allows the hatch to seal even if the lid is partially open or tipped. Flip the handle into the recess to "lock" it closed. Available in 6" and 8" diameters. These hatches are now standard equipment on all Hobie Kayaks.



### HOBIE 6"

#### HATCH BAG

Add a drop-in bag to the 6" Hobie Twist-n-seal hatch. Kit includes required back-up ring with lip, screws and bag with drawstring. (Available for 6" hatch only)

**5421** 6" Hobie Bag Kit



\*Retrofit kits include gaskets (and 2 ea #8031130 screws for the 8").

**71701011** 6" Twist-n-Seal Hatch

**71701001** 6" Twist-n-Seal Retrofit Kit\*

**71701021** 6" Twist-n-Seal O Ring

**71321001** 6" Mount Gasket

**71702011** 8" Twist-n-Seal Hatch

**71702001** 8" Twist-n-Seal Retrofit Kit\*

**71702021** 8" Twist-n-Seal O Ring

**71331001** 8" Mount Gasket

### PLANO® TACKLE

**BOX** Innovative up-latching fasteners and Dri-Loc® Seal ensure watertight storage.



**TACKLE BOX SMALL** 10 adjustable dividers create 5-15 compartments. Yellow/Clear 9.13" x 5" x 1.25"

**72020311** TACKLE BOX SMALL

**TACKLE BOX MEDIUM** 15 adjustable dividers create 5-20 compartments. Clear/Blue 11" x 7.25" x 1.75"

**72020321** TACKLE BOX MEDIUM

**TACKLE BOX LARGE** 25 dividers create 3-28 compartments. Perfect box for extra long bulk storage. Clear/Red 14" x 9.13" x 2"

**72020331** TACKLE BOX LARGE



**HOBIE DRY BAG** 8" diameter x 14". This dry bag is built of tough materials. Seals tight to keep your stuff dry.

**71703001** 8" Hobie Dry Bag



**SEE BAG** Transparent 13 oz. vinyl bags make quick work of locating things. Great for organizing gear and personal stuff. Keep your food and spare clothes dry. Easy to carry or tie onboard. Its cylindrical shape will hold odd shapes such as cameras, binoculars, lunches, etc. without distortion of bag and resultant potential leakage.

**72210T** SEE BAG (8" x 14" 622 cu.in.)

**72230T** SEE BAG (11" x 19" 2200 cu.in.)

# RAM ROD HOLDERS / MOUNTS

**RAM** is the revolutionary universal ball and socket mounting system that allows you to mount practically anything anywhere. Unlike other mounts on the market, RAM allows you to mount items where you need them most. If you need to mount a Rod Holder, GPS or FishFinder look no further. RAM mounts will help you make a professional job easy. Its unique design provides easy installation, mobility, strength, versatility, vibration protection and durability, all at a low cost. RAM is backed by a Lifetime Warranty which makes it the mounting system of choice. To provide light weight strength and corrosion resistance, RAM uses marine grade aluminum with a powder coated finish, light weight nylon injected molded plastic, stainless steel hardware and rubber balls.



**NEW!**

72023014 RAM TUBE (PLASTIC) ROD HOLDER (1.5")

72023013 RAM TUBE (PLASTIC) PIVOT ROD HOLDER (1.5")

72023022 RAM TUBE (PLASTIC) PIVOT ROD HOLDER WITH FLUSH MOUNT



72023008 RAM FLY ROD HOLDER (1.5")



72023000 RAM TUBE (ALUMINUM) ROD HOLDER W/ 72023003 BASE (1.5")



72023001 RAM SMALL DIAMOND (1")

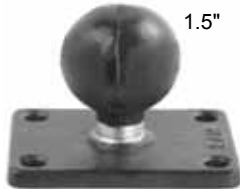

72023003 RAM 2 X 2.5 (1.5")



72023002 RAM SPACE SAVER (1.5")



72023015 ACCESSORY TUBE WEDGE MOUNT (1.5")



72023016 ACCESSORY TUBE WEDGE MOUNT (1")



72023004 RAM POST SCOTTY CONVERSION (1.5")



72023017 U-BOLT RAIL BASE (1")

- 72023000** RAM TUBE ROD HOLDER W/ BASE (1.5")
- 72023010** RAM TUBE ONLY (1.5")
- 72023001** RAM SMALL DIAMOND BASE (1")
- 72023002** RAM SPACE SAVER BASE (1.5")
- 72023003** RAM TUBE BASE 2 X 2.5 (1.5")
- 72023004** RAM POST CONV. ATTWOOD,SCOTTY (1.5")
- 72023008** RAM FLY ROD HOLDER W/BASE (1.5")
- 72023013** RAM (PLASTIC) PIVOT ROD HOLDER (1.5")
- 72023022** RAM PIVOT ROD HOLDER W/FLUSH MNT
- 72023014** RAM TUBE (PLASTIC) ROD HOLDER (1.5")
- 72023015** RAM ACCESS-TUBE WEDGE MOUNT (1.5")
- 72023016** RAM ACCESS-TUBE WEDGE MOUNT (1")
- 72023017** RAM U-BOLT RAIL BASE w/BALL (1")



# SCOTTY ROD HOLDERS / MOUNTS



FLY ROD HOLDER 80055001  
WITH DECK / SIDE MOUNT

**SCOTTY ROD HOLDER** Bait Caster/Spinning Rod Holder. Holds a baitcaster reel in a cushioned cradle. A slot in the front of the holder allows for a spinning reel to be securely held in position. The rod holder design has a side mounted flange, which leaves the bottom open. This allows for the rod holder to accommodate trigger sticks. Pistol grip rod butts easily clear the sides of the rod holder for quick rod retrieval. Rods can be secured in holder with a soft latching strap which snaps over the top. Fully adjustable up and down and rotates 360 degrees. Requires either the combination deck or side mounting bracket or flush deck mount (bolting dimensions - 1 5/16" x 3 3/16").



FLUSH MOUNT  
80049001



80048002  
Rod Holder Height Extender 8.5"



BAIT CASTER ROD HOLDER 80048001  
WITH DECK / SIDE MOUNT

- 80048001** Rod Holder - Bait Caster w/mount
- 80055001** Rod Holder - Fly Rod w/mount
- 80048002** Rod Holder Height Extender 8.5"
- 80048003** Rod Holder Height Extender 6.5"
- 80052001** Mount - Deck / Side
- 80049001** Mount - Flush
- 71330001** Gasket - Scotty Mount



**ROD HOLDER AND MOUNT**  
Removable, adjustable rod holder.  
**72070A ROD HOLDER**



**HOBIE MOLDED-IN ROD HOLDER EXTENSIONS** Keep your fishing rods secure and reels higher out of the water. These fit right into the molded-in rod holders and offer a larger diameter sleeve that is deeper. Leash the holder extension to the boat and the rod to the holder using the molded eyes.

**72020014 ROD HOLDER EXTENSION**

## HUNTING



**GUN MOUNT** for your kayak.  
Mounts to kayak rail for easy access.  
**72020013 GUN MOUNT**

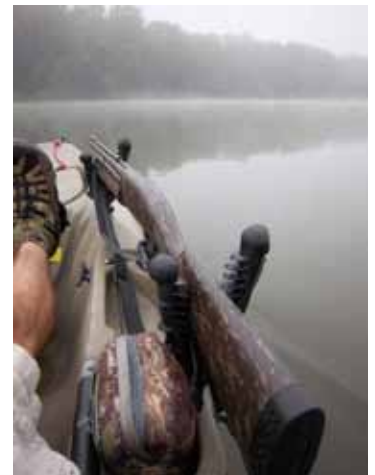

# LOWRANCE FISHFINDERS

COMPACT SERIES



## M68C S/MAP COMPACT FISHFINDER

- High-brightness 3.5" (8.9cm) diagonal 256-color, 1/4 VGA active matrix TFT transfective LCD
- Impressive 320V x 240H pixel resolution
- 12-parallel channel GPS+WAA S receiver with internal antenna
- 800 W peak-to-peak power
- Depth penetration to 600 feet (183 m)

Find fish and yourself in dazzling color, at a highly affordable price. Features high-detail hydrographic mapping and an internal GPS+WAA S receiver.

**72020017** M68C

(Use Ram Mount 72023007 & Installation Kit 72020011)



## X67C COMPACT FISHFINDER

- High-brightness 3.5" (8.9cm) diagonal 256-color, 1/4 VGA active matrix TFT transfective LCD
- Impressive 320H x 240W pixel resolution
- 800 W peak-to-peak (100 W RMS) power
- Low-profile high-performance 200 kHz Skimmer® - with built-in water surface temp sensor
- Depth penetration to 600 feet (183 m)

An exciting 256-color sonar performer with temp at a great low price. This unit packs a lot into a small package - 320x240 resolution, FishReveal™, HyperScroll™, ASP™, COLORLINE®, and more.

**72020016** X67C

(Use Ram Mount 72023007 & Installation Kit 72020011)



## X50 DS FISHFINDER

- Film SuperTwist LCD with 4-level gray scale
- Compact Dual-Search 83/200 kHz Skimmer® with dual beams producing up to 120 degrees of wide fishfinding coverage
- Depth penetration to 1000 feet (305 m)

Featuring the Lowrance Dual-Search (DS) 83/200 kHz technology, this convenient, space-saving sonar unit comes with a high-contrast 240x160, 4" Film SuperTwist display with 4 levels of gray scale definition.

**72020005** X-50 DS

(Use Ram Mount 72023007 & Installation Kit 72020011)

FULL SIZE SERIES



**NEW!**

## ELITE-5 FISHFINDER/GPS CHARTPLOTTER

- True 12.7 cm/5 in., 480x480 pixel SolarMAX™ 256-color TFT display
- Dual-frequency 83/200 kHz fishfinding
- Internal 16-channel GPS antenna
- Built-in background mapping/charting
- Navionics® and other chart options available
- Depth penetration to 1000 feet (305 m); 500 W RMS, 4,000 W Peak-To-Peak

The new color Elite-5 fishfinder/chartplotter brings high performance and high color to on-the-water enjoyment in every way, and without a high price. Get incredible precision and functionality, in addition to a spectacular new view.

**72020038** Elite 5 FishFinder / GPS Chartplotter

(Use Ram Mount 72023021 & Installation Kit 72020039)



**NEW!**

## ELITE-5X FISHFINDER

- True 12.7 cm/5 in., 480x480 pixel SolarMAX™ 256-color TFT display
- Dual-frequency 83/200 kHz Skimmer® transom-mount transducer with internal temp sensor and up to 120° of wider sonar coverage
- Unique TrackBack™ feature for multi-page scroll-back review of fishfinder history
- Depth penetration to 1000 feet (305 m); 500 W RMS, 4,000 W Peak-To-Peak

The color Elite-5X Fishfinder brings a level of high performance and high color to serious anglers for an amazing low price. And it comes fully packed with legendary Lowrance features, incredible precision and functionality, in addition to a spectacular new view.

**72020037** Mark-5X-Pro

(Use Ram Mount 72023021 & Installation Kit 72020039)



**NEW!**

## MARK-5X-PRO FISHFINDER

- High-resolution 5 in./12.7 cm, 480x480 pixel Film SuperTwist LCD
- Dual-frequency 83/200 kHz Skimmer® transom-mount transducer with internal temp sensor and up to 120° of wider sonar coverage
- Unique TrackBack™ feature offers immediate scroll-back to review multiple pages of echosounder history
- Depth penetration to 1000 feet (305 m); 300W RMS, 2,400W Peak-To-Peak

Powerful yet simplified performance, only Mark fishfinders offer legendary Lowrance features with a newly-optimized automatic mode for high-performance finding with turn-on-and-fish ease. Along with easy-to-use menus, there's also an Advanced User Mode for fine-tuning to water conditions.

**72020036** Mark-5X-Pro

(Use Ram Mount 72023021 & Installation Kit 72020039)



# MOUNT FISHFINDERS



**72023007**  
FISHFINDER  
COMPACT MOUNT



**72023021**  
FISHFINDER  
FULL-SIZE MOUNT

**RAM MOUNTS** We have chosen the best RAM mounts for use on the Hobie kayaks and our Lowrance Fishfinders.

## COMPACT FISHFINDER MOUNT

**72023007** FITS LOWRANCE X50DS, X67C, M68C; HUMMINBIRD PIRANHA MAX 10, 15, 20; EAGLE CUDA 240I, 240, 168, 128, FISHEASY 320C, FISHEASY 240

## FULL-SIZE FISHFINDER MOUNT

**72023021** FITS LOWRANCE MARK, ELITE SERIES AND HUMMINBIRD 100, 300, 500, MATRIX SERIES

# INSTALL FISHFINDERS

## COMPACT FISHFINDER INSTALLATION KIT



**72020011** COMPACT FISHFINDER INSTALL KIT  
**72021011** SPARE TRANSDUCER PAD

Hobie has taken the guess work out of installing a fishfinder by providing a simple yet complete installation kit. This kit is adaptable to virtually any kayak and will run most fishfinders on the market, like our Lowrance Compact Series fishfinders. The only thing you need to do is determine the location of your new unit! Kit includes: Dry Bag, Battery Harness, AA Batteries, Snap Connector, Foam Transducer Pad, Zip Ties, Marine Goop, Displacement Connectors, Rubber Grommet.

## FULL-SIZE FISHFINDER INSTALLATION KIT

**NEW!**



**72020039** FULL SIZE FISHFINDER INSTALL KIT  
**72021011** SPARE TRANSDUCER PAD

Hobie's full size fishfinder installation kit integrates a waterproof 10AH gel cell 12-volt battery to provide more power to run larger units like the Lowrance Full Size Series of fishfinders. It can also be used to run smaller units for longer periods of time. Kit includes: Waterproof 10AH gel cell 12-volt battery with attached waterproof wiring and connectors, 12-volt battery charger, foam battery pad, foam transducer pad, zip ties, marine goop, wire connectors, rubber grommet, wire cap

# ENDURA™ OUT&BACK GPS - COLOR

Smartly designed for easy, out-of-the-box use, the Out&Back's straightforward menu makes navigation simple. Its large color transfective touch-screen allows for easy viewing and operation, and its pre-loaded mapping content with key land features such as lakes, rivers, primary roads and key Points of Interest (POI) provides accurate situational awareness. Out&Back is also easy to customize, including a recording option that saves trails and routes allowing quick recall or sharing, a geocaching application providing paperless geocaching with Geocaching.com and power standby to conserve battery life as well as provide quick restart. The Out&Back supports a wide range of optional mapping content. Like all Endura handhelds, the Out&Back accepts public domain files and community-based content such as GPX trails, routes and general outdoor POIs.

**72020018** Endura Out&Back GPS  
(Use Ram Mount 72023018)



## GPS MOUNT

**72023018** RAM MOUNT LOWRANCE ENDURA



**72023018**  
ENDURA GPS MOUNT

## UNIVERSAL ELECTRONICS MOUNT

**72023006** RAM UNIVERSAL MOUNT 6 1/4 X 2



**72023006**  
UNIVERSAL MOUNT



**RITCHIE PANEL MOUNT COMPASS** When you're miles out to sea or simply trying to navigate your way through uncharted waterways, rest assured that you can make it back home with one of the worlds most innovative panel mounted compasses.

## FEATURES:

- 2" (5.08 cm) Direct Reading Dial
- Easily Installed, Fits Standard 2 1/16" (5.50 cm) Instrument Hole
- View Adjusts up to 30 degrees
- Scientifically Matched Sapphire Jewel & Hardened Steel Pivot Dial Movement
- Exclusive Built-in Green NiteVu Lighting
- High Temperature Composite Construction for Extended Operating Range
- DirectiveForce Magnets
- Exclusive 5-Year Ritchie Warranty

**72020004** RITCHIE COMPASS PANEL MNT X-21

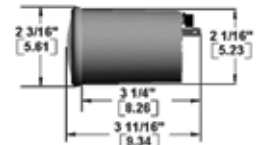





*Hobie Mirage Adventure Island*



*Hobie Mirage i12s Inflatable*





**ICAST** 2009  
New Product Showcase **WINNER**  
**Best of Show**



The **NEW** Hobie Mirage Pro Angler



Hobie Odyssey

POWERED BY



**HOBIE**  
MirageDrive™

# PURE ADVENTURE

Whether you're fishing, camping, or just taking a peaceful trip out on your local waters, Hobie has a kayak for everyone. From our line of traditional Paddle kayaks, to the innovative MirageDrive Pedal and Inflatable kayaks, building memories is what we're all about. And Hobie's new Mirage Pro Angler is the answer to every fisherman's dream.

Visit [hobie kayaks.com](http://hobie kayaks.com) and find the kayak for your next adventure.





**KAYAK CARTS** are a must for easily transporting your kayak from car to water's edge. Simply roll the kayak down to the water and off you go! All of the latest Hobie Kayaks can use "Plug-in" carts. "Plug-in" carts do just that...they plug right into the bottom of your kayak. Choose Standard for light duty and solid surfaces, Heavy Duty for heavy loads and rough terrain or the "all-terrain" Hobie Trax "2" version which is the best over soft sand. Each cart has a sturdy stainless steel frame. Some older models or other brands of kayaks may require the use of a cart that straps on.



**CART KEEPER FEATURE** Standard on Hobie Plug-in carts! After insertion of the cart, pull the dome pin out and re-insert as shown to keep the cart captive.



**POST COLLAR / CLAMP FEATURE** Collar clamps help to reduce the direct loading of the cart on your kayak's bottom / keel. Direct loads on hull bottoms can cause deformation of the kayak. Even loading at scuppers and hull bottom reduces hull-bottom deformation issues.

*Note: Be certain that the cart inserts clear through the kayak and protrudes into the cockpit / cargo area surface. Kayaks should never be left on carts for prolonged periods of time.*



**KAYAK CART "PLUG-IN" STANDARD**

Light weight with durable tires and strong spoked wheels. Stainless steel frame. Wheels are easily removable for storage. Also includes cart keeper feature and cart clamps. This cart has the medium capacity. (150 lb Capacity)

**80045001 STANDARD CART**

**80045101 i - KAYAK CART**

i - kayak cart (not pictured) plugs into an inflatable's MirageDrive well.



**KAYAK CART - "PLUG-IN" HEAVY DUTY**

Highest capacity cart with very durable knobby wheels. Welded Stainless steel frame. Wheels are easily removable for storage. Also includes cart keeper feature and cart clamps. This cart has the highest capacity. (225 lb Capacity) Recommended cart for Pro Angler and Tandem Island.

**80046001 HEAVY DUTY CART**



**KAYAK CART "PLUG-IN" HOBIE TRAX "2"**

The Trax "2" Cart has 24 cm (blow-molded polyurethane) pneumatic tires. These tires have a high capacity and are very durable! This is the best all around cart for soft sand and uneven terrain. The tires are wide and can be deflated for better performance over softer sand and soil. Welded Stainless steel frame. Wheels are easily removable for storage. (176 lb Capacity)

**80044101 TRAX "2" CART**



**KAYAK CART - UNIVERSAL**

This cart attaches to any kayak via straps and buckles. Pneumatic wheels allow this cart to roll more easily over rough terrain. Padded "hull-centering" bunks keep the kayak centered on the cart while the tie down straps hold the cart firmly to the boat. Carries loads up to 150 lbs. Welded Stainless steel construction. Wheels are easily removable.

**80041 UNIVERSAL CART**



**MINI KAYAK CART**

An easy way to pull your kayak around. Durable and lightweight, it simply straps on to the hull and off you go. Stores neatly in your hull's cargo bay while you're paddling. Best on smooth surfaces, not all-terrain.

**72080 MINI CART**



**POST COLLAR / CLAMP KIT**

Collar clamps help to reduce the direct loading of the cart on your kayak's bottom / keel. Direct loads on hull bottoms can cause deformation of the kayak. Even loading at scuppers and hull bottom reduces hull-bottom deformation issues. Fits all year-models of Hobie plug-in carts.

**80044201 COLLAR / CLAMP KIT**

**HEAVY DUTY UPGRADE KIT \***

Standard plug-in carts can be upgraded to heavy duty wheels. May require removal of welded washer on some versions.

(\*Not designed to fit Trax cart frame)

**80043 PLUG-IN UPGRADE KIT**





# HOBIE / TRAILEX ALUMINUM TRAILERS FOR KAYAKS

Hobie Trailex aluminum trailers were designed especially for the Adventure Island, but can easily be used for any single or multiple kayak load. Aluminum is light weight, tows easily and initial freight to dealer costs are reduced. Assembly is simple and well documented.

*Prices DO NOT include freight to dealer or assembly.*



- 72020400** AI CRADLE SET (Shown)
- 72020402** TI CRADLE SET
- 72020401** PRO ANGLER CRADLE SET  
(67" mount spacing required)

(1 7/8")



**STORAGE BOX "TOY BOX"** Roto-molded seamless with molded-in graphics. Big enough to hold paddles, MirageDrives, Seat backs, Life Vests and wet wear and have room left for odds and ends. The bottom is ribbed to allow wet things to drain. There is full access from front and back. Mounting hardware is not included. Length 10' 4", Width (rear) 21", Depth (rear) 13", Width (front) 19 1/2", Depth (front) 10", Weight 55 lb.

**1825WHT** One piece equipment box. Additional freight charges may apply.  
*Prices DO NOT include freight to dealer.*



### QUICK STRAP SPORTRACK

Easily installs on any vehicle with front and rear doors or opening windows. The straps secure inside the car, no gutter hooks are required. Packed in mesh storage bag (#72040 with bow and stern tie downs).

- 72040** QUICK STRAP SPORTRACK (30" PAIR)
- 72035** QUICK STRAP SPORTRACK (24" PAIR / NO LINES)

**KAYAK TRAILER** These trailers are versatile platforms that can be used for any kayaks. For carrying kayaks, order the basic single or double trailer to carry 1 or more kayaks inverted on the crossbars (crossbar padding is not provided). For the Adventure Island, add the custom designed hull cradle set. These are form fitted to the Adventure Island hull and carpet covered. Strap down your boat with the custom tie down set. For two Adventure Islands, add two cradle sets and the center Tower System. The Tower includes mast / sail hangers and is also designed to mount an equipment box on top. Easily mount the Hobie Toy Box on top of the Tower (Thule box shown). Trailers ride on 8" wheels.

*Trailer prices DO NOT include freight to dealer or assembly costs. Thule storage box shown is not included and not available through Hobie Cat.*



**38652000 TRAILER SINGLE**  
Shown with AI cradle set (#72020400)

**38652200 TRAILER DOUBLE**  
Shown with 2 AI and cradles sets (#72020400) and (#38652210) tower system.

**38652201 TRAILER DOUBLE / DOUBLE**  
Fits 2 Tandem Islands side by side (96" Crossbars).

**38652210 TOWER**  
Add the optional tower for equipment box mounting on a double trailer, multi kayak transport (Up to 4 kayaks leaned against tower). Also includes two mast carriers for 2x AI configuration.

- 72020400** CRADLE SET (1 boat) - ADVENTURE ISLAND
- 72020420** TIE DOWN SET (1 boat) - ADVENTURE ISLAND
- 72020402** CRADLE SET (1 boat) - TANDEM ISLAND
- 72020401** CRADLE SET (1 boat) - PRO ANGLER
- 38653300** UNIVERSAL PAD SET - ALL OTHER KAYAKS



### ROOF RACK PAD

Beefy car roof rack pads, made from durable black polyester with Hobie diamond logo. Easy-on split bottom with Velcro™ closure.

- 72045** 24" ROOF RACK PAD (PAIR)
- 72046** 36" ROOF RACK PAD (PAIR)



### TIE DOWN STRAPS

Car roof rack tie-down straps, made of durable black polypropylene webbing.

- 72042** TIE DOWNS 12' (PAIR)
- 72043** TIE DOWNS 15' (PAIR)



HOBIE TANDEM ISLAND SHOWN



# COVERS

**KAYAK COVERS** Protect your kayak from the effects of the weather, UV rays, dirt, leaves and birds. We have chosen four sizes to fit the entire line of Hobie Kayaks. These covers are easy to install or remove, fits over the hull (like a fitted sheet on a mattress). Straps and pull string adjust for a tight fit. Cross straps secure the cover on your hull for windy conditions. Heavy duty UV resistant canvas material in a neutral color for better aging. These covers fit over the hull when upright or upside down. To help prevent distortions to the hull bottom shape, Hobie recommends that our kayak hulls be stored upside down resting on the cockpit rails. This is also best for deflecting rainwater and prevents water pooling in the cockpit or on the cover. When planning to store a hull upright, be sure to properly support the hull bottom to prevent hull distortions.

**72050 KAYAK COVER / 9'-12'**

(LANAI, MAUI, SPORT, KONA-TIGHT)

**72051 KAYAK COVER / 12'-15'**

(KONA [LOOSE], PURSUIT, MIRAGE CLASSIC, TANDEM / OASIS, OUTFITTER, QUEST, OUTBACK, REVOLUTION, PRO ANGLER)

**72052 KAYAK COVER / 14'-16'**

(ADVENTURE, TANDEM/OASIS, ODYSSEY)

**72053 KAYAK COVER / 14'-16'6"**

(\*ADVENTURE ISLAND-FOLDED)

**72054 KAYAK COVER / 16'-18'6"**

(\*TANDEM ISLAND-FOLDED)



**MIRAGEDRIVE STOW BAG**

Protect your MirageDrive... and other goods in your car from the drive!

This heavy duty Cordura and mesh bag fits the complete MirageDrive with standard fins or the ST Turbo length. It has small pockets inside for the speedo tube, scupper plugs or spare parts. Has a carry handle and a shoulder carry strap. There is extra space in the bag for things like a life vest or drive well plug. Revised bag design is longer to better accommodate ST Turbo fins. Also includes "D" ring fittings to allow attachment to Inflatable rolling bags. Large enough to store your Inflatable's drive, pump and 4 piece paddle.

**80024 MIRAGE DRIVE BAG**

**SHOCKCORD BALL**

**TIES** Lashing equipment to your boat is quick and easy with this handy tie-down. Dozens of uses.

**370** Each



**TALIC SEAHORSE RACK** Portable storage for kayaks under 100 lbs. Made of corrosion resistant anodized aluminum. Can be used indoors or out. Raises your kayak up to accessible height for outfitting accessories, cleaning or just keeping it off the garage floor. Collapsible for storage.

**72088001** 31" Talic SeaHorse Rack





# HOBIE LUGGAGE

We now offer a selection of quality Hobie luggage. These three pieces represent the most popular luggage items. A back pack, rolling duffel and an expandable rolling suitcase are just the thing for the Hobie traveler! All bags are Army green.



## 72020500 HOBIE EXPANDABLE UPRIGHT

29" x 17" x 11"

## 72020501 HOBIE WHEELED DUFFLE

26" x 13" x 13"

## 72020502 HOBIE BACK PACK

21" x 14" x 9"

### HOBIE WHEELED DUFFLE

- Wheeled heavy duty duffel bag
- U-shaped main opening for easy access
- Zipped compartments on both sides, one with mesh pocket
- Shoe compartment with easy to clean lining material
- Sturdy bottom structure and edge guard
- Detachable inside supporting straps to keep bag standing
- Padded shoulder strap

### HOBIE EXPANDABLE UPRIGHT

- Main interior compartment includes top and side mesh pocket
- 3 zipped compartments in the front lid for easy access of small items and shoes
- Zipped packing compartment with straps inside lid provides better organization
- Smooth retractable handle and rolling wheels
- Padded top, side and two front handles make lifting easy
- TSA lock included
- Detachable toiletry bag included
- Integrated ID tag

### HOBIE BACK PACK

- 4 zipped compartments for better organizing contents
- Padded laptop sleeve in main compartment
- Organizer for cell phone and office items in front compartment
- Zipped media pocket for mp3 player
- Ergonomic padded shoulder straps with hardware adjusters and cross strap to stabilize the pack
- Molded form back panel with air flow channels for carrying comfort
- Side zipped pocket and mesh pocket to hold small items and water bottle
- Attached rain cover inside bottom zipped pocket



**GUSSETED STOW BAG** Our 6" by 12" gusseted tramp bag rises to the occasion. It has hooks on both ends to clip to your boat and carries the Hobie logo. Also available in 8" x 12" size. Securely stow tool, gloves or small parts for easy access on board your kayak.

**72000B** 6"x12" GUSSETED TRAMP BAG

**72005B** 8"x12" GUSSETED TRAMP BAG



**DRIVE WELL SEAL** Keeps the seat area drier. Seals the aft end of the MirageDrive well. Limits the incursion of water into the cockpit caused by the surge action of the drive fins. Testers also claim some improvement of forward thrust. Easily attaches to any MirageDrive. Kit includes one seal and two attachment "zip ties".

**81037001** Well Seal

**81038001** i - Well Seal



**LEASH KIT - MIRAGEDRIVE**

If you ever remove your MirageDrive while on the water... protect your investment from an accidental drop overboard. Includes hardware for attachment to the hull.

**74052101 LEASH KIT - MIRAGE DRIVE**



**PEDAL PAD KIT**

Softer on your feet! Neoprene pads are self adhesive and stick right to your pedals.

**72020034 PEDAL PAD KIT BLACK (PAIR)**



**PADDLE "T" HANDLE** Convert your kayak paddle to a canoe style paddle. Easier to store on many models of Hobie Mirage kayaks where paddle use is unnecessary while using the MirageDrive. Plugs into the female half of the kayak paddle.

**74049001 PADDLE "T" HANDLE**

**MIRAGE SEAT PAD - INFLATABLE**

**"I-COMFORT"** Adjustable comfort! Replaces the standard foam seat pad for the Hobie Mirage. Adjust the cushion by adding or releasing air pressure. Like an inflatable camping pad. Has an internal self inflating foam and an air valve through which the pad can be further inflated / deflated to suit the users comfort. Not designed for use on Hobie Mirage Inflatable kayaks. Can be used in combination (stacked) on the standard seat cushion.



**72020028 MIRAGE SEAT PAD - INFLATABLE "I-COMFORT"**

**STEERING KNOB ASSY** Get a grip on your steering. More comfortable hand position - better leverage. Fits Tandem Island and all 2011 Mirage model steering handles.

**88991355 KNOB ASSY**

**NEW!**



**HOBIE MIRAGE SPEEDO**

Removable, "pitot tube" speedometer measures your pedaling speed. Fits current MirageDrive systems only (Plastic spine on drive serial number 16054 and higher).

**80030001 SPEEDO**



**MIRAGEDRIVE SPARE PARTS KITS**

Spare parts kits include a fin, mast, sprocket, chain and appropriate parts for the drive version. Older drives have sprockets and masts that use a set screw connection. "V2" drives use threaded sprockets and masts. All in a handy zippered pouch. Don't waste a day on the water when your MirageDrive could be easily repaired. Available for the standard fin drive or a drive with the ST Turbo fins. Standard kit shown.

**80010201** Standard (Set Screw Sprocket)

**80013201** Turbo (Set Screw Sprocket)

**80010301** "V2" Standard (Threaded Sprocket)

**80013301** "V2" Turbo (Threaded Sprocket)



**MULTI STRAP SYSTEM**

Hang your kayak for storage, use as bow and stern lines or use them as carrying handles. Multi purpose straps can be attached to the boat and adjusted for many uses. Made from durable black polypropylene webbing.

**72041 MULTI STRAP** (Pair)



**THIGH CONTROL STRAPS**

Padded thigh control straps. Clip to standard kayaks. Hook over thigh/knees for better control and power when paddling.

**72500001 THIGH CONTROL STRAPS**



74050001

**PADDLE LEASH**

Secure paddle to your boats bow eye. Keep the paddle with the boat after a capsizes. By holding the paddle after a capsizes you can also be sure that the boat stays with you and cannot drift away. Web paddle leash is made from hollow webbing and an internal shock cord. Coil leash is elastic plastic coil.

**74050001 PADDLE LEASH - WEB 4.5'**

**74051001 PADDLE LEASH - COIL**



74051001



**KC WELDER PRO WITH HOBIE COLOR ROD STOCK**

80 Watt element, flat tip and a 3/16" hole in tip for rod insertion. Includes a selection of Hobie color welding rod. Fix holes and cracks or customize polyethylene products. Insert the rod into the tip and place against the product to be welded. The tip heats the plastic surface and the rod. As the materials melt, move the tip along the repair area while

pushing the rod into the tip to fill the repair area with new plastic material. Plug small holes after moving accessories. Rebuild keels after excessive wear from dragging.

**72097001 KC WELDER PRO**



**STAINLESS STEEL POCKET KNIVES**

**STANDARD** Marlin spike and single blade. 3.5 oz.

**1550** Standard

**DELUXE** Marlin spike, knife blade, shackle tool, and screwdriver. 4.0 oz.

**1551** Deluxe

**YACHTSMAN** Marlin spike, blade, shackle tool. 2.0 oz.

**1555** Yachtsman



**GERBER NEEDLENOSE MULTI-PLIER®**

Since 1939 Gerber has produced high quality innovative products for the outdoors. Features included in this model are; needlenose pliers, wire cutter, crimper, standard/ metric scale, lanyard ring, cross head screwdriver, bottle/can opener, serrated sheeps foot blade, large, medium, and small flathead screwdrivers, file, drop point blade, and it adapts to the Gerber Tool Kit! This Multi-Plier® comes with the S.A.F.T. PLUS™ System where each component opens independently of all others, locks tightly against a positive stop roll bar and stays tight until you unlock it. Stainless steel construction with a limited lifetime warranty!

**83102 GERBER TOOL**

**TECH TIP!**

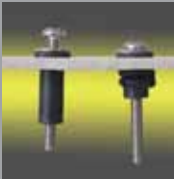

**"WELL NUT" FASTENERS** are tubular rubber fittings with an imbedded brass nut in the base. These are similar to a molly screw commonly used in sheet rock. They expand within the structure and give you a virtual backing nut and washer in an area that is inaccessible. Well nuts can be used for mounting many accessories to kayaks. Simply drill a hole as a net-fit dimension for the well nut. Insert the nut and position the hardware to be fastened. Insert and thread in the screw. Tighten until very snug. The brass nut is drawn up against the inside surface of the kayak which expands the rubber to a dimension that is too large to pull through the hole.

**KAYAK RIGGING KIT - HARDWARE**

Set of fasteners for rigging a kayak for fishing accessories. A custom selection of hardware chosen by the Hobie fishing experts. Includes stainless bolts, nuts, washers, well nuts and more. All packed in a handy Plano box. You can purchase any of the items separately. Purchase the kit and have it all, or pick and choose your own based on your individual needs. All included parts are listed below as well as many more in the numerical section of our catalog.

**72020300** Kayak rigging kit

ITEM	QTY	PART	ITEM
1	1	72020310	PLANO BOX - KAYAK RIG KIT
2	12	8031191	SCREW 1/4-20 X 1-1/4 PHMS
3	12	8030111	SCREW 10-32 X 1 PHMS-P SS
4	12	8030251	SCREW 10-32 X 1" FHMS
5	12	8030161	SCREW 10-32x1 1/2 RHMS-P SS
6	18	8080701	WASHER 1/4 X 1 SS HP
7	24	8080731	WASHER #10 FNDR SS
8	12	8050111	NUT 1/4-20 HX NYLOCK
9	24	8050201	NUT 10-32 NYLOCK LOPRO
10	12	8050221	NUT (WELL NUT) 10-32 x1
11	8	71110001	PAD EYE-BLK NYLON-3/8"
12	18	53410061	LINE HANGER
13	8	78510001	BUNGEE HOOK

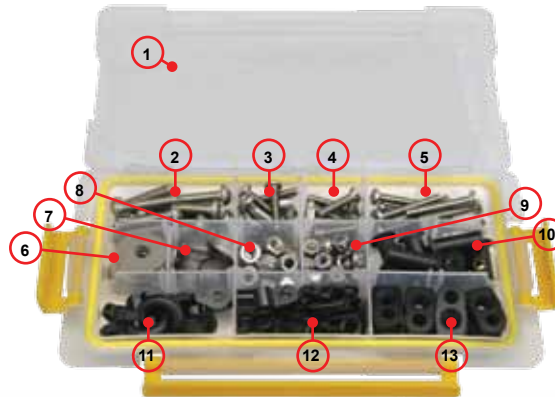

**HOG RING PLIERS** Cinch rings, hog rings, upholsterers clamp. They are all the same and these are the pliers to crimp them with. Use them on shockcord.

**83104** Each

**BOW SHACKLE - THREADED PIN**

Part #	Pin Dia.	Width	Length	Max Ld#
<b>SP150061</b>	1/4"	9/16"	15/16"	4400



**"D" SHACKLES - THREADED PIN**

Part #	Pin Dia.	Width	Length	Max Ld#
<b>SP150041</b>	5/32"	3/8"	5/8"	1100
<b>SP150051</b>	3/16"	1/2"	11/16"	2640
<b>SP150052</b>	3/16"	5/8"	15/16"	2640
<b>SP150053</b>	3/16"	5/8"	1 7/16"	2640



**SAFETY SHACKLE WITH 1/2 TURN CAPTIVE PIN**

Part #	Pin Dia.	Width	Length	Max Ld#
<b>SP185205</b>	3/16"	1/2"	1"	2640
<b>SP180005</b>	3/16"	5/8"	1 7/16"	2640
<b>SP180006</b>	1/4"	7/8"	1 5/8"	4400



**TWIST SHACKLE WITH 1/2 TURN PIN**

Part #	Pin Dia.	Width	Length	Max Ld#
<b>SP170005</b>	3/16"	1/2"	7/8"	2640
<b>SP170006</b>	1/4"	9/16"	1 3/8"	4400



**FAST SHACKLE** Avibank ball lock pin permanently wired to the shackle so it won't drop in the drink when released.

**3062** Each



**HARKEN 16MM AIR BLOCKS** Harken's newest small blocks for control lines. Accepts up to 7/32" line, 900 pound load, 5/8" sheave diameter. Ultra light weight.

- H404** Single
- H405** Single w/Becket
- H406** Double
- H407** Double w/Bckt



**HARKEN BULLET BLOCKS** Medium size blocks that work well for control lines. Accepts up to 5/16" line, 2000 pound load, 1 1/8" diameter sheave.

- H082** Single
- H083** Single /Becket
- H092** Cheek
- H166** Single w/Swivel
- H167** Single w/Swivel & Becket



**HARKEN MICRO BLOCKS** Small blocks with high load capabilities, but light weight. Accepts up to 1/4" line, 1200 pound load, 7/8" diameter sheave.

- H224** Single
- H225** Single w/Becket
- H233** Cheek



**REMOVABLE SHEAVE BLOCK**

Simply remove the clevis pin that acts as the sheave axle, slide the sheave out of the frame, place the frame through the fitting and reinstall the sheave.

**3103** Each



**SHOCKCORD SNAP HOOKS** Easy to install shockcord snap hook. No tools required. Reusable!

- 2101** Hook-1/4"
- 2102** Hook-5/16"



**SUPER LOW STRETCH LINE** Pre-stretched polyester line with superior fatigue and abrasion resistance. Our line (3/16"-3/8") tested as the lowest stretch (.5%) of any all polyester line available. Sold per foot.

- RH112WHT** 1/12" White
- RH018WHT** 1/8" White
- RH316WHT** 3/16" White
- RH014WHT** 1/4" White
- RH516WHT** 5/16" White
- RH038WHT** 3/8" White



**SPUN DACRON** Soft matte finish rope. Runs well thru blocks and fairleads, has good abrasion resistance, is spliceable and easy to hold with wet hands. Available in white, black, red, blue. This rope is not designed for winching. Sold per foot. Specify color choice. (White, Blue, Red or Black xxx = color)

- RM014WHT** 1/4" White
- RM014XXX** 1/4" Color
- RM516WHT** 5/16" White
- RM516XXX** 5/16" Color
- RM038WHT** 3/8" White
- RM038XXX** 3/8" Color
- RM716WHT** 7/16" White
- RM716XXX** 7/16" Color



**SUPER STRETCH SHOCKCORD** This midnight-black shockcord has double the stretch of ordinary cord. If you've been getting your shockcord from the hardware store, you're in for a treat. The durable black cover is woven around an extra-flexible rubber core.

- RS018BLK** 1/8"
- RS316BLK** 3/16"
- RS014BLK** 1/4"
- RS516BLK** 5/16"
- RS038BLK** 3/8"
- RS716BLK** 7/16"

- 53180011** 3/8" Hog ring
- 21180000** 1/2" Hog ring





**ONE WRAP VELCRO®** Cut this double faced Velcro® product to length and wrap it around items, line or whatever you need to secure. One side is hook and the other a loop, so a single piece is all you need.

**7904** One Wrap, per foot

**CLEAR SILICONE SEALER** Make sure your hulls are watertight! Clear Silicone seals leaks around all thru-hull fittings.

**376** 1.5 oz. Tube



## CLEATS

**HARKEN CAMMATIC CLEAT** Rounded jaws assure quick cleating/release action and smoother teeth mean longer life for your lines.

**H471** Micro Cleat, Carbo Jaw  
1/8" to 1/4" line



**HARKEN WEDGES** Fairleads and eyestraps designed specifically for each Cammatic, the wedges put the Cammatic on a 15 degree angle for ease of cleating or releasing. The fairleads are molded into a replacement base. The eyestraps are designed to be held in place over the cam by the mounting screws.

**H297** Wedge Kit

**H284** Wire Fairlead

**H281** Eye Strap

**TWO PART EPOXY PUTTY** Simple to use putty-like repair epoxy. Quick and easy, it works fast to patch up small dings and scratches in fiberglass or plastic parts. Just mix, let dry, sand lightly and you are ready to go.

**82300001** 1 Pound



**AQUASEAL MIRAZYME ODOR ELIMINATOR** There's nothing quite like the odor of damp gear left in your car trunk for a couple of days. With one application eliminate those odors from booties, wet-suits, dry-suits and the rest of your gear. A 100% biodegradable product made from a blend of 10 highly specialized, light activated microbial elements. Works by penetrating into pores of fabric, rubber and even hard surfaces to eliminate odor naturally.

**7003** 8oz.



**MAGICA RUST REMOVER** Easily clean rust stains from fiberglass, plastic surfaces, metal parts or fabrics. Although metal parts are made from high quality stainless steel, machining tools often leave carbon particles imbedded in the metal surfaces. This material can bleed a rust stain onto other surfaces. Magica simply dissolves the rust away.

**1603 MAGICA GEL** 8 oz. Bottle



**SILICONE SPRAY**

Dry silicone spray for sail luffs, cleats and bearings

**5106** Silicone 8oz



## HOBIE BOAT CLEANER AND UV PROTECTANT SYSTEM: CLEAN AND THEN PROTECT!



**HOBIE BOAT CLEANER – 160Z** Formulated with "Green Chemistry" to safely remove dirt and stains from Hobie products. Good on fiberglass, polyethylene, Vinyl (trampolines) and PVC (inflatables). Cleans the most stubborn stains off of hulls.

**7005 HOBIE BOAT CLEANER – 160Z**

**HOBIE UV PROTECTANT – 160Z** Protect and rejuvenate fiberglass, polyethylene, vinyl and PVC materials. Spray on, the protectant absorbs into the material and leaves a UV protective layer. Reduce the loss of essential oils and deflect the sun's harmful UV rays.

**7006 HOBIE UV PROTECTANT – 160Z**



**TEAR-AID** Each TEAR-AID® repair patch is made from an exceptionally tough, matte finish, abrasion resistant, elastomer that resists puncture and tearing. It is combined with an aggressive adhesive formulated for high bond strength to a variety of surfaces such as canvas, leather, rubber, nylon, most plastics, paints, aluminum, stainless steel, fiberglass, polyurethane,

polyethylene, polypropylene, vinyl and vinyl coated. TEAR-AID® Type A and TEAR-AID® Type B provide a simple and easy method of patching holes and tears, as well as an excellent protective film solution.

**EACH PATCH KIT CONTAINS:** (1) 3" x 12" TEAR-AID® Patch that cuts with scissors to any size, (1) 7/8" x 7/8" Patch, (1) 1 3/8" x 1 3/8" Patch, (1) 12" Reinforcement Filament for repairing tears at edges, (2) Alcohol Prep Pads, (1) Illustrated Instructions and a Product Repair List.

**72020030 TEAR-AID / TYPE A (POLY)**

**72020031 TEAR-AID / TYPE B (VINYL)**





# ENJOY THE RIDE

Powered by Hobie's patented MirageDrive® pedal system, the Hobie Mirage Pro Angler leaves your hands free to fish and has everything you need to maximize your angling experience.

- Protected horizontal storage for up to six rods and two additional vertical rod holders
- Space for 13 Plano® tackle boxes
- Three in-hull storage compartments
- Large front hatch with removable liner
- Large on-deck storage area for an optional livewell or cooler
- Fully-adjustable, breathable Cool Ride seat
- Finger-tip steering
- Work area/cutting board
- Replaceable mounting boards on each side to attach your fish finder, GPS, lights or downriggers

POWERED BY



**HOBIE**  
MirageDrive®





# HOBIE KAYAK SUPPORT / ONLINE SUPPORT - FAQs - FORUMS

For technical help, contact your dealer, see the Hobie website support area or visit our Hobie kayak user forums.

Our on-line support area and forums include FAQs with many technical and user topics.

Hobie Cat Company [hobiekatyaks.com](http://hobiekatyaks.com) / Hobie Australasia [hobiecat.com.au](http://hobiecat.com.au) / Hobie Kayak Europe [hobie-kayak.com](http://hobie-kayak.com)

## HOBIE KAYAK FAQ

**How watertight is my boat?** It is normal for any type of kayak to experience a small amount of seepage due to the installation of rivets, hatches, etc. Kayaks may take on a few cups of water while out paddling. If a kayak is taking on more than a small amount of water, check to make sure the drain plug is in, then check the rest of the boat for leaks. Silicone can be used to seal the rivets. If you have any questions, please call your dealer.

**How should I store my kayak?** It is best to store your kayak upside down or standing on end. If hanging your kayak, do not support from the handles. Best supported by wide webbing straps with the kayak upside down or on its side.

**Is my boat repairable?** Hobie kayaks are very durable, however, on occasion they may need some minor repairs. Linear polyethylene is repairable. Check with your dealer concerning repairs for your kayak.

**Is my boat recyclable?** Hobie will recycle your boat when you are done with it. To recycle a Hobie Kayak, it must be cut up so it fits in a box with the following dimensions: may not exceed 130" for the length plus girth, and maximum 108" for the length. Ship the boat to: Hobie Cat 4925 Oceanside Blvd. Oceanside, CA 92056. It is our hope that no Hobie Kayak will ever end up in a landfill!

## HOBIE CAT PARTS - WARRANTY POLICY

**HOBIE PARTS WARRANTY** Hobie Cat warrants all Hobie Cat manufactured parts and accessories against failure due to materials or workmanship defects for a period of one year.

**OTHER WARRANTY** Any accessories and other merchandise sold by Hobie Cat not mentioned in the paragraph above are not warranted by Hobie Cat. Said accessories and other merchandise may be covered by the manufacturer's warranty, a copy of which can be furnished by Hobie Cat upon written request.

**HOBIE CAT'S OBLIGATION** Hobie Cat at its option will repair or replace without charge any part or accessory which is found to be defective under the terms and within the period of this Warranty. Buyer must return the accessory with a sales slip as proof of purchase date.

**BUYER'S OBLIGATION** Upon discovery of a suspected defect, Buyer must-at his/her own expense-promptly return the equipment to the Hobie Kayak dealer for inspection. Warranty is void if equipment is operated after a suspected defect is, or should have been, discovered.

**WHO IS ENTITLED TO WARRANTY** Only the original Buyer of the equipment and accessories from Hobie Cat is entitled to warranty. Warranty may not be transferred.

**NO WARRANTY OF USED EQUIPMENT** Used equipment is sold AS IS; Hobie Cat makes NO WARRANTY concerning its merchantability, condition, durability, age or model year, or fitness for any purpose whatsoever.

**MUTUAL AGREEMENTS** It is agreed that this warranty sets forth Buyer's exclusive right and remedy against Hobie Cat with respect to the equipment and accessories. It is in lieu of all other express warranties and all implied warranties, including implied warranties of merchantability and fitness. Hobie Cat assumes no other like or unlike liability for loss of cargo, use, profit or consequential damages of any kind in connection with the sale, alteration, use, repair or replacement of equipment or any part thereof.

## LIVWELL PARTS



72021006



72021001



72020015



72021005



72021022



72021002



72021003



72021021



72021007



72021008



72021004



72021010



72021009



72021020

72021001	BATTERY	72021008	PUMP CONNECTOR MALE
72021002	BATTERY CHARGER	72021009	DOWNSPOUT FITTING
72021003	SWITCH	72021010	INTAKE 90 DEGREE
72021004	INTAKE TUBE ASSY	72020015	ROD HOLDER - LIVWELL
72021023	7" INTAKE TUBE (PRO A)	72021020	DOWNSPOUT TUBE
72021005	STRAP SET	72021021	TERMINAL COVER
72021006	BATTERY LID	72021022	ATTWOOD PUMP
72021007	PUMP CONNECTOR FEMALE	79050211	DRAIN PLUG

# Hobie Kayak - Common Parts

See model specific pages for model-specific parts

## TECH TIP!

**DECK FASTENERS** Customize your boat with the fasteners of your choice... where you want them. The Hobie screw-in fittings can be easily removed and replaced. Add an extra eye where we placed a hook, a cleat hook where a shockcord end is placed... You choose what works best for you. Use tool #71115101

## SCREW-IN FITTINGS



71116001  
PADEYE



71117001  
CLEAT



71115001  
SHOCKCORD END



71115101  
TOOL  
SCREW IN FITTINGS

79050211 DRAIN PLUG  
79050212 O-RING



10091000 DRAIN PLUG

81394001 RUDDER PIN  
81394021 RUDDER PIN 2011 CENTERLINE STYLE

SEE RUDDER PAGE 39  
FOR RUDDER SYSTEM DETAILS

80020001 RUDDER LINE  
REPLACEMENT KIT UNIVERSAL

81023001 SPECTRA CONTROL LINE  
8063001 SWEDGE  
81400001 TUBING  
81405001 TUBE HOLDER  
81405101 END CAP



71230001 ROD HOLDER COVER  
8031130 SCREW



81035001 UP / DOWN HANDLE  
W/ SET-SCREW



81392001 TWIST-N-STOW CONTROL ARM UP/DOWN  
81380001 OLDER - CONTROL ARM UP/DOWN  
81375001 SPRING  
8080691 NYLON WASHER  
81035011 BOLTED HANDLE AND CONTROL ARM KIT



RS316BLK 3/16" SHOCKCORD  
RS014BLK 1/4" SHOCKCORD  
79538201 WEB PULL TAB



53180011 3/8" HOG RING  
21180000 1/2" HOG RING



10730000 CLEAT  
8030111 SCREW



71110001 PADEYE  
8030031 SCREW  
8012001 RIVET



71120001 LASHING HOOK  
8030031 SCREW



78510001 BUNGEE HOOK  
8031961 SCREW



78520001 EYELET HOLD DOWN  
8032121 SCREW



2101 -SHOCKCORD  
FASTENER, 1/4"

81266001 SEATBACK / MIRAGE MODELS  
81268001 SEATBACK / MIRAGE MODELS 2010  
81259001 SEAT STRAP W/HOOK  
81266011 SEATBACK GEAR PACK



81265001 SEATBACK PLUG  
8031130 SCREW  
8080541 WASHER

81265101 SEATBACK  
ADJUSTABLE PLUG KIT



72402001 SEATBACK / PADDLE MODELS  
72409001 SEAT STRAP W/HOOK

81370001 - STEERING CRANK  
81372001 - CRANK AI-OUTFITTER  
H071 SPRING  
8080691 NYLON WASHER



81015001 - STEERING  
HANDLE W/ SET-SCREW

2011 MODELS  
81013001 HANDLE  
8030126 SCREW  
88991151 STICKER  
88991355 KNOB ASSY







72104001 HOOK



80012001 PEDAL RETAINER BUNGEE W/HOOK



81535001 MIRAGE CASSETTE PLUG



74076001 PADDLE 2 PC ALUMINUM  
74077001 PADDLE 4 PC ALUMINUM  
74075001 PADDLE 2 PC FIBER  
74010001 BLADE RIGHT  
74011001 BLADE LEFT  
74076101 BUTTON

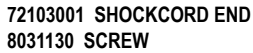

72103001 SHOCKCORD END  
8031130 SCREW



2008 AND OLDER  
81410001 CAM LOCK KNOB  
BOLTS VARY BY MODEL



74049001 PADDLE "T" HANDLE

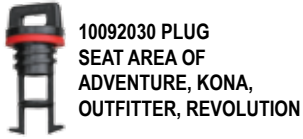

10092030 PLUG  
SEAT AREA OF  
ADVENTURE, KONA,  
OUTFITTER, REVOLUTION



81611101 CLICK-N-GO ASSY (L)  
81611201 CLICK-N-GO ASSY (R)



41220001 EYELET POST  
8031131 SCREW

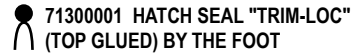

71300001 HATCH SEAL "TRIM-LOC"  
(TOP GLUED) BY THE FOOT

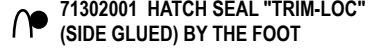

71302001 HATCH SEAL "TRIM-LOC"  
(SIDE GLUED) BY THE FOOT



76050001 BOW/ STERN HANDLE

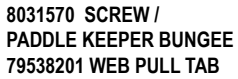

8031570 SCREW /  
PADDLE KEEPER BUNGEE  
79538201 WEB PULL TAB

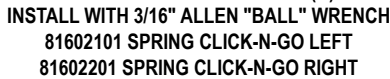

INSTALL WITH 3/16" ALLEN "BALL" WRENCH  
81602101 SPRING CLICK-N-GO LEFT  
81602201 SPRING CLICK-N-GO RIGHT



SEE MIRAGEDRIVE PAGE 36-37  
FOR DRIVE DETAILS

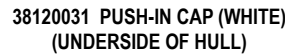

38120031 PUSH-IN CAP (WHITE)  
(UNDERSIDE OF HULL)



71220001 METAL PAD EYE  
8030071 SCREW



10730031 "PORT" SHOWN

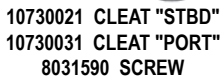

10730021 CLEAT "STBD"  
10730031 CLEAT "PORT"  
8031590 SCREW



81408001 UP / DOWN HANDLE  
81406001 DECAL - UP  
81407001 DECAL - DOWN  
8004531 LINE (BLK)



84550001 MAST RECEIVER  
84560001 MAST TUBE COVER  
8031151 SCREW

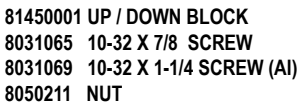

81450001 UP / DOWN BLOCK  
8031065 10-32 X 7/8 SCREW  
8031069 10-32 X 1-1/4 SCREW (AI)  
8050211 NUT



72012001 - SCUPPER  
PLUG QUEST & KONA



72010 - SCUPPER PLUG  
ODYSSEY



72009001 - SCUPPER PLUG  
PURSUIT/ MAUI/ LANAI



78560001 MESH STOWAGE POCKET  
8031501 SCREW



76055001 MIDSHIP HANDLE  
8032011 SCREW



71190001 WEBBING LIFT HANDLE  
8032011 SCREW  
8080571 WASHER



71702011 HATCH 8" TWIST-N-SEAL  
71702001 HATCH 8" TWIST-N-SEAL RETRO KIT  
71331001 FLANGE GASKET / 71702021 LID O-RING  
8031130 SCREW



71701011 HATCH 6" TWIST-N-SEAL  
71701001 HATCH 6" TWIST-N-SEAL RETRO KIT  
71321001 FLANGE GASKET / 71701021 LID O-RING  
8031130 SCREW



71130001  
HATCH 5" SCREW-IN  
8031130 SCREW

## HATCHES

# Hobie MirageDrive "V2"

WHAT MAKES A "V2" DRIVE? V2 DRUMS, V2 CHAINS, V2 IDLER CABLE AND V2 (THREADED) MASTS / SPROCKETS (2009 PRODUCTION AND NEWER)

- 80010001 MIRAGEDRIVE "V2"
- 80013011 MIRAGEDRIVE I-SERIES "V2"
- 80013001 MIRAGEDRIVE ST TURBO "V2"

- 81203001 IDLER CABLE V2
- 8050111 NUT
- 81121001 IDLER PULLEY
- 53170020 SET SCREW
- 81110001 PULLY SHAFT

- 81222001 PEDAL/CRANK ASSY. (R)
- 81221001 PEDAL/CRANK ASSY. (L)
- 81222101 CAP - PEDAL CRANK
- 81222011 PEDAL ONLY (R)
- 81221011 PEDAL ONLY (L)
- 81226001 PEDAL STRAP (R)
- 81227001 PEDAL STRAP (L)

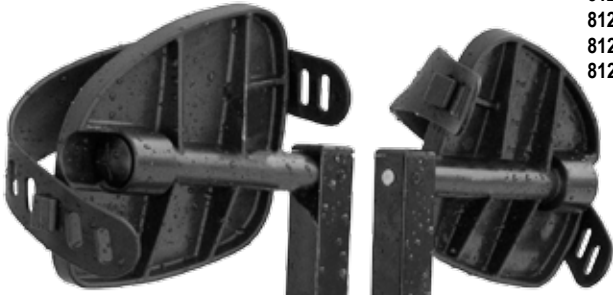

72020034 PEDAL PAD KIT



- 81236001 PEDAL ADJ ASSY  
INCLUDES:  
81240001 PLASTIC HANDLE
- 81230001 PIN
- 8031201 SCREW
- 81242001 SPRING
- ALLEN WRENCH



81172001 PEDAL ADJUSTMENT DECAL

81173001 DRUM V2

- 81202001 CHAIN ASSY V2
- 8050111 NUT

81155001 BOLT

81090001 DRUM SHAFT

- DRIVE SEAL
- 81037001 STD
- 81038001 I - SERIES
- 8031581 SCREW
- 8080461 WASHER

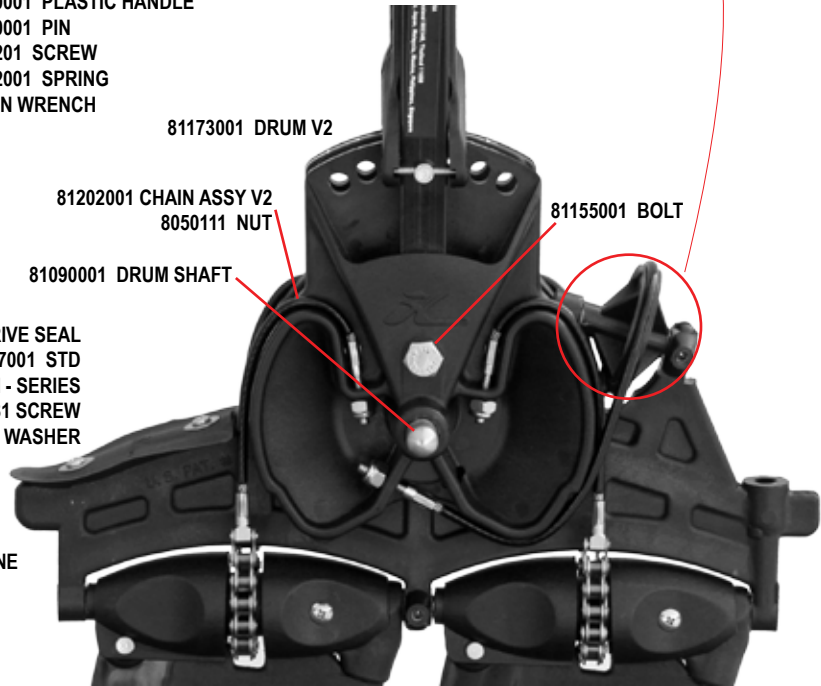

81181001 SPINE

- 81080001 SPROCKET SHAFT
- 53170020 SET SCREW

- 81050001 OUTHAUL BLOCK
- 8020041 CLEVIS PIN
- 10860001 LOCK RING

- 81055001 SPROCKET GUARD FWD
- 8031451 SCREW



- 81190001 STANDARD FIN
- 81193001 ST FIN
- 81192001 ST TURBO FIN

81129001 SPROCKET "V2" THREADED

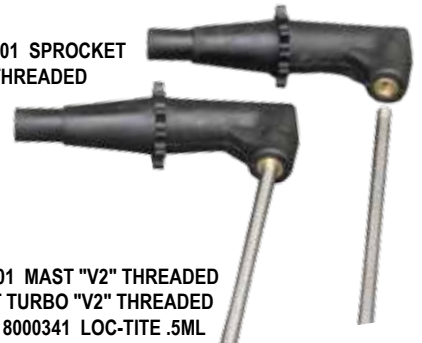

"V2" SPROCKET UPDATE KIT  
(2 "V2" SPROCKETS AND 2 "V2" MASTS)  
81129022 "V2" STANDARD MAST KIT  
81129122 "V2" TURBO MAST KIT

- 81163001 MAST "V2" THREADED
- 81198101 MAST / ST TURBO "V2" THREADED
- 8000341 LOC-TITE .5ML



# Hobie MirageDrive "V1"

DRIVE WITH OLDER P-LASTIC DRUM, PLASTIC SPINE, SPROCKET / MAST CONNECTION IS SET SCREW



## MIRAGEDRIVE SPARE PARTS KITS

Spare parts kits include a spare fin, mast, sprocket, chain, clevis pin and ring. All in a handy zippered pouch. Available for the standard fin drives or drives with ST Turbo fins. Standard kit shown.

## MIRAGEDRIVE "V2" (THREADED MAST STYLE)

Includes parts listed above for V2 "threaded mast" drives.

**80010301** KIT "V2" STANDARD FIN

**80013301** KIT "V2" TURBO FIN

## MIRAGEDRIVE OLDER (SET SCREW MAST STYLE)

Includes parts listed above plus: Set screw, allen wrench, and a cotter key.

**80010201** KIT STANDARD FIN

**80013201** KIT TURBO FIN

# Hobie MirageDrive Older

ORIGINAL DRIVE WITH ALUMINUM SPINE, STAINLESS SPROCKET / MAST CONNECTION IS COTTER KEY

- 81130001 SPROCKET (STAINLESS)
- 81340001 SPROCKET BUSHING (SS SPKT)
- 81420001 SPROCKET GUARD
- 8060111 COTTER KEY (MAST / SS SPKT)
- 81040001 OUTHAUL BLOCK (SS SPKT)
- 8020061 CLEVIS PIN
- 10860001 LOCK RING
- 81211001 IDLER CABLE 14 3/4" (SOLID PULLY)
- 81150001 DRUM BUSHING (ALUM DRUM)
- 81105001 CRANK ARM RIGHT, THREADED
- 81100001 CRANK ARM LEFT, THREADED

## Rudder Systems

### Twist-n-Stow Rudder

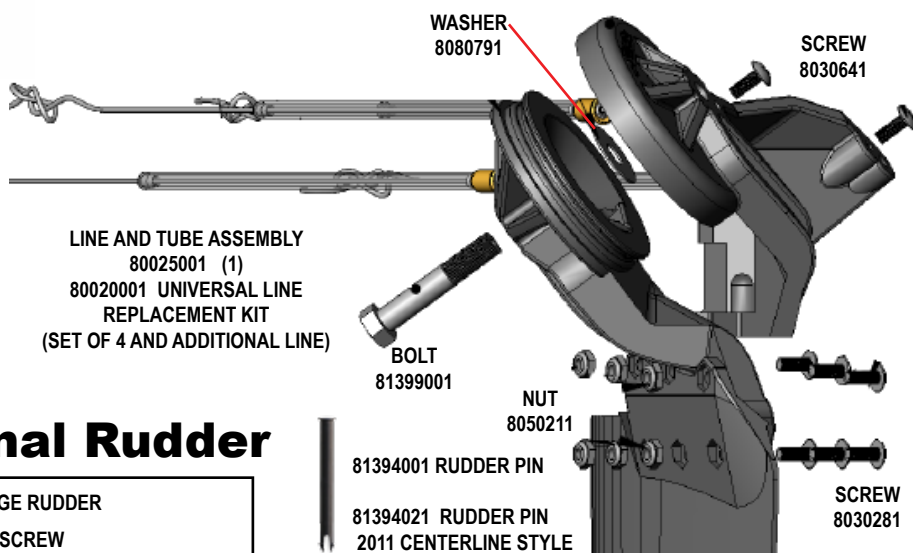

### Original Rudder

#### EARLY MIRAGE RUDDER

- 8030171 SCREW
- 8080541 WASHER

- 81350001 RUDDER MOUNT

- 81360001 S.S. RUDDER PIN

- 81390001 RUDDER BLADE

- TWIST-N-STOW RUDDER ASSEMBLY
- 81395001 SM BLADE
- 81396001 LG BLADE

- RUDDER BLADE
- 81395201 SM
- 81397001 LG

### TECH TIP

**MAINTENANCE AND TUNING** Maintenance and tuning information for MirageDrives and Twist-n-Stow rudder systems is available on the Hobie Cat website support area.

[www.hobiecat.com/support](http://www.hobiecat.com/support)

Direct link to the support pages for kayaks is here:

<http://www.hobiecat.com/support/index-kayak.html>

# Hobie Mirage Series

## Mirage Sport

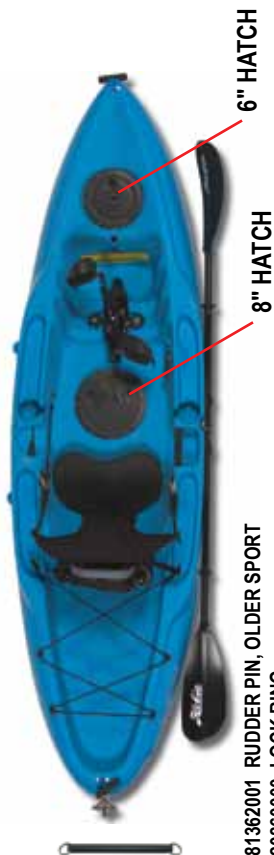

81361001 RUDDER PIN, CLASSIC  
20860000 LOCK RING

RUDDER LINE  
REPLACEMENT KIT  
80020001

## Mirage Outback

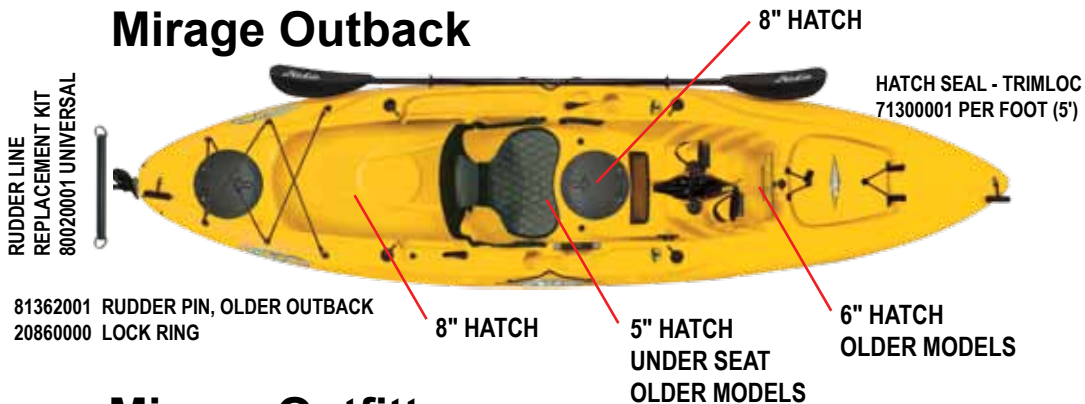

RUDDER LINE  
REPLACEMENT KIT  
80020001 UNIVERSAL

81362001 RUDDER PIN, OLDER OUTBACK  
20860000 LOCK RING

HATCH SEAL - TRIMLOC  
71300001 PER FOOT (5')

## Mirage Outfitter

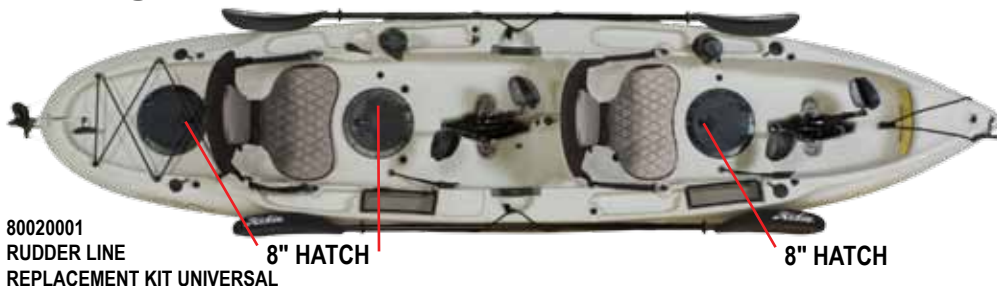

80020001  
RUDDER LINE  
REPLACEMENT KIT UNIVERSAL

## Mirage Classic



MIRAGE CLASSIC & PURSUIT  
71201 - CARGO COVER  
71300001 - LOC SEAL, 6.5FT

## Mirage Revolution



HATCH SEAL - TRIMLOC  
71300001 PER FOOT (5')

## Mirage Oasis

RUDDER LINE  
REPLACEMENT KIT  
80020001

81362001 RUDDER PIN, OLDER TANDEM  
20860000 LOCK RING

## Mirage Adventure

79050211 NEWER DRAIN  
PLUG

80020001  
RUDDER LINE  
REPLACEMENT KIT

HATCH SEAL - TRIMLOC  
71300001 PER FOOT (5')

**WATER BOTTLE GUIDE**  
71999011 SMALL BOTTLE 16OZ  
SPORT/OUTBACK/QUEST/KONA  
71997001 MEDIUM BOTTLE 18OZ  
ODYSSEY/LANAI/MAUI  
71998001 LARGE BOTTLE 32OZ  
REVOLUTION/ADVENTURE/ADVENTURE  
ISLAND/OUTFITTER/OASIS



# Hobie Paddle Series

Lanai / Maui



**Kona**

8" HATCH

8" HATCH

QUEST RUDDER SYSTEM  
78501 TWIST-N-STOW RUDDER KIT  
78551001 RUDDER MOUNT TNS  
8032011 RUDDER SCREWS

HATCH SEAL - TRIMLOC  
71300001 PER FOOT (5')

**Quest**



8" HATCH

61070000 CLEAT  
37380001 CLAM CLEAT 8031130 SCREW

78540001 TRACK / FOOT BRACE  
78535001 FOOT BRACE / LEFT  
78536001 FOOT BRACE / RIGHT

**Odyssey**



8" HATCH

6" HATCH

# Hobie Mirage i - Series



79052007 SEATBACK / I-SERIES

79050061 I-SERIES CASSETTE PLUG  
79050021 CLICK AND GO SPRING

71702011 HATCH 8" TWIST-N-SEAL  
71331001 FLANGE GASKET / 71702021 LID O-RING  
8031130 SCREW

79052017 VALVE ASSY

81394001 RUDDER PIN  
81395201 SMALL RUDDER BLADE  
81395001 RUDDER ASSY. W/ SM. BLADE

76050001 BOW/ STERN HANDLE

79050211 DRAIN PLUG

79052019 PADDLE HOLDER 74077001 PADDLE 4 PC ALUMINUM SHAFT 80012001 PEDAL RETAINER BUNGEE W/HOOK

79052000



**79052203** i-Series Sail Kit (White/Turq)  
**79052204** i-Series Sail Kit (Silver/White)

**79052000 I - ACCESSORY HOLDER KIT**

Designed to allow the attachment of rod holders and other accessories to the Hobie Mirage inflatable kayaks. The accessory kit comes with 2 mount plates and attachment glue. 4 hole pattern fits Scotty mount and RAM / Scotty hole pattern products. Mount the 80052001 Scotty Deck/Side mount and Scotty rod holders or adapt for the RAM products by adding 72023004 RAM Ball Scotty adapter. (1/4-20 Screws sold separately, check length for desired accessory / #8030380 7/8" length for Scotty deck mount).

**79052006 I - HARDWARE ACCESSORY KIT**

Includes padeyes, spare cleats and glue. Customize your Hobie inflatable.

**79052001 I - CAN HOLDER KIT**

Includes 2 flexible can / cup holders and glue. Customize your Hobie inflatable.

79052006



79052001



79052015 and 16



**80045101 i - KAYAK CART "PLUG-IN"**

**79052015 I - TRI RING KIT / SAGE**

**79052016 I - TRI RING KIT / SUNDANCE**

Includes 2 "Tri" rings mounted on round patches ready for installation. Customize.

**79052009 I - HULL REPAIR KIT**

Includes 2 colors of repair vinyl and glue, valve tool and instructions. Repair or customize a Hobie Mirage Inflatable kayak.

**79052005 I - ELECTRIC INFLATION PUMP**

Electric pump connects to car 12v outlet. Quickly and easily fill your Hobie inflatable. This is a high volume / low pressure pump. Use the standard pump to bring chambers to full pressure.

**79052003 I - STANDARD INFLATION PUMP**

Standard hand pump for Hobie inflatable.

79052009



# Adventure Island

- 79510001 '07 MAST ISLAND (2 PC)
- 79510011 '08 MAST ISLAND (2 PC)
- 79511021 MAST SWIVEL TIP

- 79512001 FURLER DRUM
- 79511001 '07 MAST BASE / PIN
- 79511101 '08 MAST BASE / HOLE
- 79510101 MAST BASE COLLAR KIT



- 79509001 SAIL GRAY/WHT
- 79516001 SAIL PAPAYA/TURQ/WHT
- 79515001 SAIL RED/GRAY/WHT

- 91051011 BATTEN 9' 2"
- 91041011 BATTEN 7' 8.5"
- 91011001 BATTEN CAP
- 22080011 BATTEN LUFF CAP SET

- 79531001 XBAR FWD ASSY
- 8030781 SOC CAP SCREW

- 79520001 AKA FWD (L/R)

- 79535001 AKA CONNECTOR PIN
- RS316BLK 3/16" SHOCK CORD (9")
- 53180011 HOG RING

- 71190001 LIFT HANDLE
- 8032011 SCREW
- 8080571 WASHER

- 79545001 AMA "HOBIE" DOME LOGO
- 88991355 2011 STEER KNOB ASSY

- 79538101 PADDLE HOLDER KIT
- 79538001 PADDLE RETAINER CLIP

- 79521001 AKA LEFT REAR

- | 2011 MODEL AI (V2) XBAR / AKAS |                     |
|--------------------------------|---------------------|
| 79512201                       | AKA AI V2 - RT FWD  |
| 79512301                       | AKA AI V2 - LT FWD  |
| 79512401                       | AKA AI V2 - LT REAR |
| 79512501                       | AKA AI V2 - RT REAR |
| 79512601                       | XBAR AI V2 - FWD    |
| 79512701                       | XBAR AI V2 - REAR   |

- RM014BLK MAINSHEET (32')
- 38670011 "S" HOOK

- H082 BULLET BLOCK

- H083 BULLET BLOCK W/BECKET

- 79526001 AKA CARRY BAG

- 79510201 MAST / SAIL BAG

- 79514001 '07 MAST RECEIVER
- 79514101 '08 MAST RECEIVER
- 8030261 SCREW
- 8080211 WASHER

- 71320001 GASKET
- 79513001 BACKUP RING



- 8032011 STEP PLATE SCREW

- 79517001 V-FRAME STRUT
- 79528001 SCREW SOCKET SET



- 79519001 V-FRAME TURNBUCKLE

- 79533001 MAST BEARING PLATE (REQ 2)
- 8031231 SCREW
- 8050801 NUT
- 90610111 BEARINGS (EA / REQ 24)
- 79532001 MAST RETAINER SPRING
- 8004381 (12') FURLING LINE

- H233 CHEEK BLOCK
- 8030150 SCREW
- 8080500 WASHER
- 8050211 NYLOCK NUT

- H424B FAIRLEAD
- H471 CLEAT

- 8031481 SCREW
- 79531101 CLEAT WEDGE WITH FAIRLEAD
- 79531111 MAIN CLEAT WEDGE
- RM014BLK MAINSHEET (32')

- 79501001 FOAM PLUG / DAGGER WELL

- 79502001 DAGGER BOARD

- 79525001 BALL / BRACE
- 8030212 SCREW

- 79522001 AKA RIGHT REAR

- 79537001 BRACE RETAINER CLIP

- 79530001 XBAR REAR ASSY
- 8030781 SOC CAP SCREW

- 79518001 V-FRAME BASE
- 71116001 EYE

- 71115001 END FITTING
- RS014BLK SHOCK CORD (1')

- 41220001 EYELET POST
- 8031130 SCREW

- 79520201 AKA COLLAR
- 8010181 RIVET

- 79520301 AKA END CAP

- 99303001 AMA PAPAYA
- 99304001 AMA HIBISCUS
- 99305001 AMA DUNE

- 10091000 DRAIN PLUG

- 79523101 AKA BRACE ASSY
- 79523201 AKA BRACE ASSY - V2 XBAR

- 79050211 DRAIN PLUG
- 79050212 O-RING



- 79524001 CAP / AKA BRACE LOCK
- 79523001 SOCKET / AKA BRACE LOCK
- 81242001 SPRING / AKA BRACE LOCK
- 8030781 SOC CAP SCREW

- 8032081 SHEAR BOLT
- 8052081 NUT
- 79536001 BRACE CONNECTOR
- 8020381 CLEVIS PIN
- 20860000 SPLIT RING

- 10091000 DRAIN PLUG

- 81396001 TWIST-N-STOW RUDDER ASSY / LG BLADE
- 81397001 LARGE SAILING RUDDER BLADE
- 81394001 RUDDER PIN
- 81394021 RUDDER PIN 2011 CENTERLINE STYLE

- 81391002 RUDDER UP/DOWN LINE KIT

- 80020001 RUDDER LINE REPLACEMENT KIT UNIVERSAL

- 79050211 DRAIN PLUG
- 79050212 O-RING



# Tandem Island

- 88991121 MAST TANDEM ISLAND (2 PC)
- 79511021 MAST SWIVEL TIP
- 88991071 FURLER DRUM
- 79511101 MAST BASE
- 88991071 COLLAR

- 88998514 SAIL DUNE
- 88998515 SAIL SMOKE
- 88998516 SAIL BREEZE



- 88998521 BATTEN #1 (1/4" 186")
- 88998531 BATTEN CAP 1/4"
- 88998522 BATTEN #2 (3/16" 42 1/2")
- 88998523 BATTEN #3 (3/16" 39 1/2")
- 91011001 BATTEN CAP 3/16"

- 22080011 BATTEN LUFF CAP SET

- 79520311 AKA FWD (L)

- 79531201 XBAR FWD ASSY
- 8030451 SCREW (CUP ATTACH)
- 8050111 NUT (CUP ATTACH)
- 8032088 SCREW (XBAR ATTACH)
- 8080561 WASHER (XBAR ATTACH)

- 71190001 AMA LIFT HANDLE
- 8032011 SCREW
- 8080571 WASHER
- 79545001 AMA "HOBIE" DOME LOGO

- 88991061 HULL LIFT HANDLE
- 8032011 SCREW

- 88991301 STEERING HANDLE
- 8030125 SCREW
- 88991151 STICKER

- 88991355 (2011) STEER KNOB ASSY

- 79530201 XBAR REAR ASSY

- 79520401 AKA LEFT REAR

- 79538101 PADDLE HOLDER KIT
- 79538001 PADDLE RETAINER CLIP

- 79050211 DRAIN PLUG
- 79050212 O-RING



- 79526002 AKA CARRY BAG

- 79510202 MAST / SAIL BAG



- 79533001 MAST BEARING PLATE (REQ 2)
- 8031231 SCREW
- 8050801 NUT
- 90610111 BEARINGS (EA / REQ 24)
- 79532001 MAST RETAINER SPRING
- 8004381 (12') FURLING LINE

- H233 CHEEK BLOCK
- 8030150 SCREW
- 8080500 WASHER
- 8050211 NYLOCK NUT



- H424B FAIRLEAD
- H471 CLEAT 8031481 SCREW
- 79531101 CLEAT WEDGE / FAIRLEAD
- 79531111 MAIN CLEAT WEDGE

- 88991101 CENTERBOARD
- 88991021 CENTERBOARD PIN
- 88991031 PIN HOLDER
- 8031461 SCREW
- 8030671 SCREW
- 88991011 COVER
- 8030071 SCREW (4)
- 81242001 SPRING
- 88991041 KNOB
- 88991150 CAP

- 79520501 AKA RIGHT REAR
- 79537001 BRACE RETAINER CLIP

- 79525001 BALL / BRACE
- 8030212 SCREW

- MAINSHEET SYSTEM
- 38670011 "S" HOOK
- H083 BLOCK-BULLET W/BECKET
- RM014BLK LINE (55')
- H2655 BLOCK, 40MM CARBO FIDDLE

- 79050211 DRAIN PLUG
- 79050212 O-RING

- 88991185 RUDDER ASSY / TI BLADE
- 88991187 RUDDER BLADE TI
- 88991094 GUDGEON
- 88991101 TI RUDDER PIN

- 80020001 RUDDER LINE REPLACEMENT KIT UNIVERSAL



- 79514101 MAST RECEIVER
- 8030261 SCREW
- 8080211 WASHER
- 71320001 GASKET
- 79513001 BACKUP RING
- 8032011 STEP PLATE SCREW



- 88991191 V-FRAME STRUT
- 79528001 SCREW SOCKET SET

- 88991201 V-FRAME TURNBUCKLE

- 88991201 V-FRAME BASE



- 71116001 EYE



- 71115001 END FITTING
- RS014BLK SHOCK CORD (1')



- 41220001 EYELET POST
- 8031130 SCREW



- 79520201 AKA COLLAR
- 8010181 RIVET



- 79520301 AKA END CAP

- 88991303 AMA PAPAYA
- 88991304 AMA HIBISCUS
- 88991305 AMA DUNE

- 88523101 AKA BRACE ASSY



- 79524001 CAP / AKA BRACE LOCK
- 79523001 SOCKET / AKA BRACE LOCK
- 81242001 SPRING / AKA BRACE LOCK
- 8030781 SOC CAP SCREW
- 8032081 SHEAR BOLT
- 8052081 NUT
- 88536001 BRACE CONNECTOR
- 8020381 CLEVIS PIN
- 20860000 SPLIT RING

# Pro Angler



**NEW!!**  
**STEERING (PRO A) REVERSIBLE**  
**ASSY KIT INCLUDES ALL PARTS**  
**TO REPLICATE 2011 STEERING ON**  
**OLDER MODELS. MOUNT ON PORT**  
**OR STARBOARD SIDES**  
**84506201**

84504501 HANDLE - BOW  
 8030361 SCREW SOC CAP

79545001 "HOBIE" DOME LOGO



84501901 HATCH LINER FWD - PRO ANGLER

ROD HOLDER STORAGE  
 84500911 ROD HOLDER ASSY LEFT  
 84500921 ROD HOLDER ASSY RIGHT

84502001 MOUNTING BOARD, RT  
 84502101 MOUNTING BOARD, LT  
 8030341 SCREW  
 8032085 SCREW  
 8050111 NUT

84502401 FLOOR MAT RT  
 84502501 FLOOR MAT LT-BLK

72020311 PLANO BOX - SMALL YELLOW  
 72020321 PLANO BOX - MEDIUM BLUE  
 72020331 PLANO BOX - LARGE RED



84505001 STORAGE BUCKET ASSY  
 (INCLUDES COMPARTMENT WITH DIVIDERS)  
 84505101 STORAGE BUCKET COMPARTMENT  
 84505201 REPLACEMENT COMPARTMENT DIVIDERS  
 (SOLD AS EACH / REQ 7)

84506001 STEERING ASSEMBLY  
 (INCLUDES HANDLE, TUBES AND LINE  
 ASSEMBLED)

84501301 HANDLE  
 84501531 BALL  
 8030111 SCREW  
 WASHER



See Tension Knob

8030981 SCREW  
 8050211 NUT  
 81023001 SPECTRA  
 CONTROL LINE (14')

84501511 TENSION KNOB  
 84501521 RBR WASHER  
 8080551 WASHER  
 8050231 NUT  
 84502601 TENSION SCREW



84501401 HOUSING  
 8030981 SCREW (2)



84501601 TUBE CONNECTOR, STEERING

80074001 STEERING LINE TUBE (2)  
 8003171 BLK PVC TUBE COVER (26")  
 84501201 THRU HULL BARB CONNECTOR  
 81030001 ZIP TIE (BLK) (2)



84500601 COVER PLT, RDR SYSTEM  
 8031051 SCREW (4)  
 84500801 TUBE RESTRICTOR (2)  
 84500501 RDR STEERING DRUM  
 81245001 ROLL PIN  
 84500201 RUDDER HOUSING, UNDER HULL  
 84502301 SISTER SCREW, PRO RDR ASSY  
 8031490 SCREW  
 84500401 RDR MOUNT, UNDER HULL  
 84504001 TORSION SPRING, RUDDER  
 84500101 RUDDER BLADE, PRO A



84502201 CUTTING BRD, CNTR, BLACK  
 8030071 SCREW  
 8050111 NUT

84500001 SEAT ASSEMBLY - PRO ANGLER  
 84500011 LUMBAR SUPPORT PAD  
 84502901 KNOB, SEAT FRAME FRONT  
 8031811 STUD (FWD)  
 8042151 BOLT SHOULDER (REAR)  
 84500021 SEAT STRAP ASSY (ONE SIDE)  
 8011231 RIVET

84504101 UNIVERSAL SIDE HANDLE ASSY  
 84504401 HANDLE END FITTING  
 8031781 SCREW SOC CAP  
 84504301 DECAL, RULER

71996001 BOTTLE/CAN HOLDER  
 74035001 FOLDING PADDLE CLIP

71702011 HATCH 8" TWIST-N-SEAL

84504201 TUBE, STERN HANDLE  
 84504401 HANDLE END FITTING  
 8031781 SCREW SOC CAP

72013001 SKID GUARD, PRO  
 8030641 SCREW  
 10091000 DRAIN PLUG



Part	Description	OS			
278	WINDTRONIC 2 W/ BELT POUCH		8031481	SCREW 8-32 X 1-1/4 PHMS-P	
330	WIND METER HAND HELD-MPH		8031490	SCREW 8-32 X 1/2 FHMS-P	
334	AIR FLOW TELS		8031581	SCREW #8 X 5/8" PHMS-SS PH	
370	SHOCK CORD BALL TIES		8031590	SCREW 8 X 3/4" FHMS-P SS	
376	SILICON RTV 100% 3 OZ.		8031781	SCREW 5/16-18 X 1 E/S SOC	
615	BOOK, PENGUIN BOAT FLIPPERS		8031811	STUD 5/16-18 X 1-1/4" 18-8 SS	
1550	KNIFE, STD. STAINLESS RIGGING		8031961	SCREW 12-24 x 1-1/4 P-OHMS SS	
1551	KNIFE, DLX STAINLESS		8032011	SCREW 1/4-20x1/2 RHMS-P SS	
1555	KNIFE, YACHTSMAN POCKET		8032061	SCREW 1/4-20x1 1/4 PHPMS	
1603	MAGICA RUST REMOVER GEL 8 OZ B		8032081	SCREW 1/4-20 X 1-1/4 CAP SCREW	
1619	TRAMP CLEANER, SEASPRAY		8032085	SCREW 1/4-20 X 1-1/4 FHMS-P	
2082	SCALE - DOWN HAUL / FISH		8032088	SCREW 1/4-20 x 2-1/4 HX CAP	
2101	SHOCK CORD HOOK 1/4" - HOBIE		8034061	ALLEN WRENCH 1/8"	
2102	SHOCK CORD FASTENER (SCH) 5/16		8034071	ALLEN WRENCH 5/64"	
2105	SHOCK CORD HOOK 1/4"		8040526	BOLT, CAM LOCK KNOB, 3.25 " NO	
3043	LICENSE FRAME - CHROME "HOBIE"		8040531	BOLT 3/8-16 X 1-1/2 HEX CAP-S	
3044	LICENSE FRAME - CHROME "KAYAK"		8040535	BOLT 3/8-16 x 1-3/4" SCKT HEAD	
3062	SHACKLE, FAST		8042151	BOLT 5/16-18 X 1/2 SHOULDER	
3091	PADDLE, TELESCOPING 20"-39"		8050111	NUT 1/4-20 HX NYLOCK	
3103	BLOCK, MINI W/AXLE		8050211	NUT 10-32 NYLOCK LOPRO	
5106	SILICONE SPRAY PUMP 8oz		8050221	NUT (WELL NUT) 10-32 x1	
5411	FAT BAG-5"		8050231	NUT 10-32 HEX	
5421	HATCH BAG KIT KAYAK		8050540	NUT 3/8-16 HX NYLOCK-LP	
7003	MIRA ZYME 8 oz ODOR ELIMINATOR		8050801	NUT 8-32 MACH/SCREW SS	
7005	HOBIE BOAT CLEANER - 16oz		8052081	NUT 1/4-20 NYLON	
7006	HOBIE UV PROTECTANT - 16oz		8060111	COTTER PIN 3/32 X 3/4 SS	
7904	VELCRO ONE WRAP 1" BLACK		8061961	SCREW 12-24 x 1-1/4 P-OHMS SS	
20501	HAIRPIN COTTER 5/16" 302 SS		8080211	WASHER #12 FLAT	
71172	B/U RING 8.0" FOR PTL-8		8080461	WASHER #10 FLAT-.25 OD X .56 I	
71201	CARGO COVER ASSY-PUR/MIR		8080500	WASHER #10 FINISH	
71311	GASKET KAYAK 5"		8080541	WASHER 1/4 X 5/8 FLAT SS	
72010	KEY FLOAT/SCUPPER PLUG- MFG		8080551	WASHER-FLAT .227 X .453 SS	
72035	QUICK STRAP SOFT RACK-24.0"		8080561	WASHER 1/4 X 1/2 X .032 SS	
72040	QUICK STRAP RACK W/TIE DN		8080571	WASHER FLAT 1/4x3/4x.063 SS	
72041	MULTI STRAP SYSTEM		8080691	WASHER 3/8 X 3/4 NYLON-FLAT	
72042	TIE DOWN STRAPS - 12 FOOT		8080731	WASHER #10 FNDR SS	
72043	TIE DOWN STRAPS - 15 FOOT		8080791	WASHER NYLON FLAT (TNS)	
72045	RACK PADS -24.0"		10091000	DRAIN PLUG W/GASKET	
72046	RACK PADS -36.0"		10092030	DRAIN PLUG w/GASKET- SEAT: KON	
72050	KAYAK COVER / 9-12'		10730000	CLEAT-MAST	
72051	KAYAK COVER / 12-15'		10730021	CLAMCLEAT STBD BLACK	
72052	KAYAK COVER / 14-16'		10730031	CLAMCLEAT PORT BLACK	
72053	KAYAK COVER / 14-16' 6"		10860001	LOCK RING 3/16"	
72054	KAYAK COVER / 16-18' 6"		10860100	LOCK RING 3/16" - 100 PACK	
72065	ST-TURBO FIN KIT		12451031	DECAL "HOBIE" DIAMOND-TURQ/SLV	
72080	MINI KAYAK CART		12451050	DECAL "HOBIE" SCRIPT BLACK	
72700	BIMINI / CHARCOAL - MANTIS JR		12451051	DECAL "HOBIE" SCRIPT WHT	
72701	BIMINI / BLUE - MANTIS JR PRO		12453011	DECAL - HOBIE KAYAKS	
72702	BIMINI / GREEN - MANTIS JR PRO		12453021	DECAL - HOBIE KAYAK FISHING	
72710	MOUNT - BIMINI MANTIS JR PRO		12453031	DECAL - HOBIE CAT TEQ	
72720	KAYAK DODGER - CAMO		13001001	DECAL BOW - FLYING "H" BLK	
72721	KAYAK DODGER - SILVER		20860000	LARGE CLEVIS RING	
72722	KAYAK DODGER - YELLOW		20860100	LARGE CLEVIS RING / 100 PACK	
78501	QUEST RUDDER KIT/TWIST N STOW		21180000	HOG RING 1/2" S/S, BLUNT, 14 G	
80024	BAG, MIRAGEDRIVE CARRY		22080011	JIB BATTEN PKT PROT W/SCREWS	
80039	COOLER, KAYAK BLUE		36601000	DECAL FLYING "H" SMALL BLK	
80041	KAYAK CART - "HEAVY DUTY"		36601011	DECAL FLYING "H" SMALL WHT	
80043	PLUG IN CART HD UPGRADE KIT		37380001	CLAMCLEAT MINI GETAWAY	
81024	LINE 5/32" NYLON BRAID-BLACK		38120031	NYLON PUSH-IN PANEL RIVET	
81380	CONTROL ARM - UP/DOWN		38652000	TRAILER HOBIE ALUM KAYAK SINGL	OS
83102	TOOL GERBER MULTI-PLIER 600		38652200	TRAILER HOBIE ALUM KAYAK DOUBL	OS
83104	TOOL, HOG RING PLIERS		38652201	TRAILER ALUM KAYAK DOUBLE DOUB	OS
84503	SAIL KAYAK MAST 2-PC		38652210	TOWER - TRAILER HOBIE ALUM DOU	OS
84511	BATTEN KAYAK SAIL 4.583 FT		38653300	TRAILER PAD KIT - KAYAKS	
84950	BAG - KAYAK SAIL RIG		38670011	"S" HOOK,WAVE HALYD DWNHL	
84960	MIRAGE TDM SAIL ADAPTER KIT-SM		41220001	EYELET POST	
84961	MIRAGE TDM SAIL ADAPTER KIT-LG		41370001	HATCH SCREW-IN W/LIP-WHT 5"	
8000341	LOCTITE, BLUE, 5 ML CAPSULE		53170020	SCREW 1/4-20 X 1/2 SKTST (ABA)	
8003171	TUBE 1/2" ID X 5/8" OD-PVC BLK		53180011	HOG RING 3/8" S/S FOR 3/16" BU	
8004381	LINE 5 MM, DK GRAY w/MANGO TRA		53410061	LINE HANGER	
8004531	LINE 1/8 NYLON BRAID BLK		61070000	CLAMCLEAT JUNIOR CL203	
8010181	RIVET 6-4 PN HD		71110001	PAD EYE-BLK NYLON-3/8"	
8012001	RIVET 6-9 BULB TYPE-KAYAK		71115001	SHOCK CORD END - SCREW-IN (UAI)	
8020041	CLEVIS PIN 3/16x.570 GRIP		71115101	TOOL - SCREW IN FITTINGS	
8020061	CLEVIS PIN 3/16x.753 GRIP		71116001	PADEYE - SCREW-IN (UAI)	
8020381	CLEVIS PIN 1/4x.578 GRIP		71117001	CLEAT - SCREW-IN	
8030031	SCREW #10x3/4 OHMS-P		71120001	LASHING HOOK-BLACK	
8030037	SCREW #6-32 x 3/4 PHMS		71130001	HATCH SCREW-IN w/LIP-BLK 5"	
8030071	SCREW 10-32 X 1/2 FHMS		71171001	B/U RING W/LIP FOR PTL-6	
8030111	SCREW 10-32 X 1 PHMS-P SS		71175001	HATCH BAG 6.0 DIA.-RED	
8030125	SCREW 10-32 x 1/2 BTN HD SCKT		71190001	HANDLE - LIFTING (WEB - KAYAK)	
8030126	SCREW 10-32 x 3/8 FLNG BTN HX		71220001	PAD EYE - CHROME	
8030150	SCREW 10-32 x 1/2 PHMS-P		71230001	COVER, ROD HOLDER	
8030161	SCREW 10-32 X 1-1/2 RHMS-P SS		71250001	SHOCK CORD ASSY, KONA FWD DECK	
8030171	SCREW 12-24 X 3/4 RHMS-P SS* (		71251001	SHOCK CORD ASSY, PDL HOLDER	
8030212	SCREW 1/4-20 X 1" OHMS-PH SS		71253001	SHOCK CORD ASSY, ADV PDL HOLDE	
8030251	SCREW 10-32 X 1" FHMS		71300001	TRIM-LOC SEAL (TOP GLUED)	
8030261	SCREW #10 X 1-1/4 PHMS-P		71302001	TRIM-LOC SEAL (SIDE GLUED)	
8030361	SCREW 5/16-18 X 1-1/4 SOC HD		71320001	GASKET 5.0" & 7-1/8" SET	
8030451	SCREW 1/4-20 X 1-3/4 SCKT HD		71330001	GASKET KAYAK HATCH 6"	
8030641	SCREW 10-32 X 1/2 THMS-P SS		71330001	GASKET - SCOTTY ROD HLDR MOUNT	
8030671	SCREW 8-32 X 5/8 PHMS-P		71331001	GASKET KAYAK HATCH 8"	
8030781	SCREW 1/4-20 X 1/2" SOC CAP		71552001	SHOCK CORD ASSY, ADV FWD HATCH	
8030981	SCREW 10-32 x 3/4 PHPMS		71554001	SHOCK CORD ASSY, QUEST	
8031051	SCREW #10 X 1/2 FHMS-P TF		71701001	HATCH 6" TWIST-N-SEAL RETRO	
8031065	SCREW 10-32 x 7/8" THMS-P		71701011	HATCH 6" TWIST-N-SEAL	
8031081	SCREW 10-32 x1 3/4 PHMS-S SS		71701021	O RING 6" TWIST-N-SEAL	
8031111	SCREW 1/4-20x1 PHMS -P		71702001	HATCH 8" TWIST-N-SEAL RETRO	
8031131	SCREW #10x 3/4 PHSM-PH SS(ABA)		71702011	HATCH 8" TWIST-N-SEAL	
8031151	SCREW #10 X 1/2 PHMS-P TF-16		71702021	O RING 8" TWIST-N-SEAL	
8031191	SCREW 1/4-20 X 1-1/4"PHMS		71703001	HOBIE DRY BAG 8.0"	
8031201	SCREW 8-32 X 1-1/4 SOC SET CUP		71704001	GEAR BUCKET	
8031231	SCREW 8-32 X 7/8" FHMS		71705001	GEAR BUCKET BAG	
8031451	SCREW #8-32 x 5/16 P-THMS SS		71706001	GEAR BUCKET 3 PAK W/BAG	
8031461	SCREW 8-32 x 1" PHMS		71995001	WATER BOTTLE - STAINLESS	
			71996001	BOTTLE/CAN HOLDER	

71997001	WATER BOTTLE MED SMOKE 18oz	72023022	RAM TUBE 2000 HOLDER w/FLUSH M
71998001	WATER BOTTLE LARGE SMOKE 32oz	72025001	BATTERY - 12v FISHFINDER
71999011	WATER BOTTLE SMALL SMOKE 16oz	72025002	BATTERY CHARGER - 12v FF
72009001	SCUPPER PLUG-PSUIT/MAUI/LANAI	72025003	PIGTAIL WIRE / 12v FF
72012001	SCUPPER PLUG KONA/QUEST	72062001	SIDEKICK - LOCK PIN SINGLE
72013001	SKID GUARD, PRO	72062011	SIDEKICK - MOUNT BRACKET BOTTO
72020000	HOBIE GEAR KEEPER 2.5oz 36"	72062021	SIDEKICK - MOUNT BRACKET TOP
72020001	HOBIE GEAR KEEPER 36"	72062041	SIDEKICK - CROSSBAR MIDDLE
72020002	SAFETY FLAG 4' (W/STUD)	72062061	SIDEKICK - ADP PLATES +07 ADVE
72020003	HYDRO STAR SOS DLX LIGHT	72062062	SIDEKICK - MOUNT KIT W/CTR BAR
72020004	RITCHIE COMPASS PANEL MNT X-21	72062101	SIDEKICK AMA KIT - LT GRAY
72020005	FISHFINDER - LOWRANCE X-50 DS	72062111	SIDEKICK - FLOAT LT GRAY W/ QU
72020007	HOBIE LIVEWELL	72062201	SIDEKICK - BENT ARM
72020008	HOBIE ANCHOR TROLLEY KIT	72063101	SIDEKICK AMA KIT - DK GREEN
72020009	HOBIE DRIFT CHUTE	72063111	SIDEKICK - FLOAT DK GREEN W/ Q
72020010	HOBIE SAFETY KIT	72066001	ST-TURBO FIN KIT V2 - THREADED
72020011	FISHFINDER INSTALLATION KIT	72076001	STAKEOUT POLE - KAYAK FISHING
72020012	MOUNT - SAFETY FLAG	72088001	KAYAK STAND 31" (PR) TALIC
72020013	KAYAK GUN MOUNT (PAIR)	72097001	KC WELDER PRO WITH ROD STOCK
72020014	ROD HOLDER EXTENSION	72103001	SHOCK CORD MOUNT
72020015	ROD HOLDER - LIVEWELL w/FASTEN	72104001	ADJ SHOCK CORD HOOK 3/8"
72020016	FISHFINDER-LOWRANCE 67C	72402001	KAYAK SEAT - PADDLE 2010
72020017	FISHFINDER/GPS-LOWRANCE M68C	72409001	STRAP W/HOOK - PADDLE SERIES B
72020018	GPS ENDURA-OUT&BACK	72500001	STRAPS THIGH CNTRL PADDED ASSY
72020019	FISH GRIP	72730001	DODGER - ISLAND / YELLOW
72020020	FISHFINDER PACKAGE	72730002	DODGER - ISLAND / SILVER
72020021	ULTIMATE KAYAK FISHING PACKAGE	72730003	DODGER-PRO ANGLER CAMO
72020022	KAYAK FLY FISHING PACKAGE	74010001	PADDLE BLADE RIGHT
72020023	KAYAK CUSTOMIZATION PACKAGE	74011001	PADDLE BLADE LEFT
72020024	MIRAGE PERFORMANCE PACKAGE V2	74035001	FOLDING PADDLE CLIP, 1-1/8"
72020025	KAYAK TRAVEL PACKAGE	74049001	T- HANDLE, PADDLE
72020026	KAYAK SAFETY PACKAGE	74050001	PADDLE LEASH-WEB/ELASTIC
72020028	MIRAGE SEAT PAD - INFLATABLE	74051001	PADDLE LEASH-COIL
72020030	TEAR-AID / TYPE A (POLY)	74052001	HOBIE FISH ROD LEASH- WEBBING
72020031	TEAR-AID / TYPE B (VINYL)	74052101	LEASH KIT - MIRAGEDRIVE
72020032	BILGE - HAND PUMP	74053001	FISH ROD LEASH - HD COIL
72020033	ULTIMATE KAYAK NAVIGATION PACK	74075001	PADDLE 230 cm HOBIE FIBER SHAF
72020034	PEDAL PAD KIT BLACK (PAIR)	74076001	PADDLE - HOBIE 231 cm
72020036	FISHFINDER-LOWRANCE MARK PRO	74076101	BUTTON ASSY - PADDLE FERRULE
72020037	FISHFINDER-LOWRANCE ELITE-5X	74077001	i - PADDLE, 4 PIECE
72020038	FISHFINDER/CHART PLOTTER-LOWRA	76050001	HANDLE KAYAK (MOLDED)
72020039	FISHFINDER FULL SIZE INSTALL K	76055001	HANDLE, MIDSHIP
72020300	KAYAK RIGGING KIT - HARDWARE	78000001	OWNER'S MANUAL-QUEST
72020311	TACKLE BOX - SMALL YELLOW	78510001	BUNGEE HOOK
72020321	TACKLE BOX - MEDIUM BLUE	78520001	EYELET HOLD DOWN
72020331	TACKLE BOX - LARGE RED	78535001	FOOT BRACE ASSY-LT
72020400	CRADLE SET - ADV ISL TRAILER	78536001	FOOT BRACE ASSY-RT
72020401	CRADLE SET - PRO ANGLER TRAILER	78540001	TRACK ADJ - BRACE/QUEST
72020402	CRADLE SET - TDM ISL TRAILER	78551001	RUDDER BRACKET - QUEST (T-N-S)
72020420	TIE DOWN KIT / ADVENTURE ISLAN	78560001	MAP POCKET FRAME w/MESH
72020500	HOBIE EXPANDABLE UPRIGHT	79050011	CAM LEVER / CLICK-N-GO WELL
72020501	HOBIE WHEELED DUFFEL	79050021	SPRING / i - CLICK-N-GO WELL
72020502	HOBIE BACK PACK	79050041	BOLT, SHOULDER 1/4 " / CLICK-
72021001	BATTERY - LIVEWELL	79050061	CASSETTE PLUG/i- SERIES
72021002	BATTERY CHARGER - LIVEWELL	79050211	DRAIN PLUG - i /LIVEWELL/ '10-
72021003	SWITCH - LIVEWELL	79050212	O-Ring ,299ID x .505OD Neopren
72021004	INTAKE TUBE ASSY - LIVEWELL	79050400	i - WRENCH-MIRAGE DRIVE SS
72021005	STRAP SET - LIVEWELL	79052000	i - ACCESSORY HOLDER KIT
72021006	BATTERY LID - LIVEWELL	79052001	i - CUP HOLDER KIT
72021007	PUMP CONNECTOR FEMALE - LIVEVE	79052003	i - INFLATION PUMP / STANDARD
72021008	PUMP CONNECTOR MALE - LIVEWELL	79052005	i - INFLATION PUMP / ELECTRIC
72021009	DOWNSPOUT FITTING - LIVEWELL	79052006	i - HARDWARE ACCESSORY KIT
72021010	INTAKE 90 DEGREE - LIVEWELL	79052007	i - SEATBACK
72021011	INSTALATION PAD, FISHFINDER	79052009	i - HULL REPAIR KIT
72021020	DOWNSPOUT TUBE - LIVEWELL	79052010	i - ROLLING TRAVEL BAG/ i - 12
72021021	TERMINAL COVER - LIVEWELL	79052011	i - ROLLING TRAVEL BAG/ i - 14
72021022	PUMP ATTWOOD - LIVEWELL	79052012	i - ROLLING TRAVEL BAG/ i - 9
72021023	INTAKE TUBE 7" ONLY - LIVEWEL	79052013	i - O RING LG - INFLATION PUM
72021030	EVOLVE TORQEEDO MOTOR KIT - K	79052014	i - O RING SM - INFLATION PUMP
72021040	EVOLVE TORQEEDO MOTOR KIT - i	79052015	i - TRI RING KIT / SAGE
72021031	EVOLVE CABLE KIT (2ND HULL)	79052016	i - TRI RING KIT / SUNDANCE
72021108	PROP, HOBIE DESIGN, TORQ MOTOR	79052017	i - VALVE ASSEMBLY
72021113	THRU HULL FITTING, PWR PLUG, T	79052018	i - GLUE 30g TUBE
72021114	BACKING RING, PWR PLG THRU HUL	79052019	i - PADDLE HOLDER
72021115	MNTG PLT, M12 CABLE GLAND	79052203	i - SAIL KIT WHITE-TURQ
72021116	BACKING RING, MNTG PLT, M12 CA	79052204	i - SAIL KIT SILVER-WHITE
72021119	GASKET PACK, CABLE MOUNTS	79052251	SAIL KAYAK MAST 4-PC
72021120	CAP, PWR PLUG, FEMALE	79051001	DAGGERBOARD WELL PLUG - ADV
72021122	LANYARD, TYCO CNCTR CAP	79052001	DAGGERBOARD / ADV - MOLDED
72021123	CAP, M12 CNCTR, FEMALE CVR	79050901	SAIL ADV ISL WHT/GRAY/WHT
72021124	CAP, M12 CNCTR, MALE CVR	79510001	MAST - ADV ISLAND ('07 / MALE
72021128	CAP ASSY POWER PLUG MALE	79510011	MAST - ADV ISLAND ('08 / FEMA
72021130	MOTOR W/225 PROPELLER,	79510201	BAG - ADV ISLAND MAST / SAIL
72021131	ULTRALIGHT BATTERY, TORQEEDO	79510202	BAG - TANDEM ISLAND MAST/SAIL
72021132	CHARGER UNIT, TORQEEDO	79510721	MOUNT XBAR V2 - TOP
72021133	REMOTE THROTTLE, TORQEEDO	79510731	MOUNT XBAR V2 - BOTTOM
72021134	CABLE, POWER EXTENSION, 170"	79511001	BASE / PIN - ISLAND MAST
72021135	CABLE, M12, THROTTLE BOX CONEC	79511021	MAST CAP - ISLAND (SWIVEL TIP)
72021136	CABLE, M12, THROTTLE CONTROL	79511101	BASE / HOLE - '08 ISLAND MAST
72021137	KEY W/LANYARD AND CLIP	79512001	DRUM - ISLAND MAST FURLER
72023000	RAM TUBE ROD HOLDER W/ BASE	79512201	AKA AI V2 - RT FWD
72023001	RAM SMALL DIAMOND BASE	79512301	AKA AI V2 - LT FWD
72023002	RAM SPACE SAVER BASE	79512401	AKA AI V2 - LT REAR
72023003	RAM TUBE BASE 2 X 2.5	79512501	AKA AI V2 - RT REAR
72023004	RAM POST CONV. ATTWOOD,SCOTTY	79512601	XBAR AI V2 - FWD
72023006	RAM UNIV MOUNT 6 1/4 X 2	79513001	BACKING RING, AI MAST RECEIVER
72023007	RAM FISHFINDER MOUNT COMPACT S	79514001	MAST RECEIVER, ADV ISL (FIBER)
72023008	RAM FLY ROD HOLDER W/ BASE	79514101	MAST RECEIVER CUP ASSY AI '08
72023010	RAM TUBE ROD HOLDER - NO BASE	79515001	SAIL ADV ISL RED/GRAY/WHT
72023013	RAM TUBE (PLASTIC PIVOT) ROD H	79516001	SAIL ADV ISL TURQ/PAPAYA/WHT
72023014	RAM TUBE (PLASTIC) ROD HOLDER*	79517001	V-FRAME, STRUT
72023015	RAM MAST-TUBE WEDGE MOUNT 1.5"	79518001	V-FRAME, BASE
72023016	RAM MAST-TUBE WEDGE MOUNT 1"	79519001	V-FRAME, TURNBUCKLE-BRASS
72023017	RAM U-BOLT 1" RAIL BASE w/BALL	79520001	AKA - FWD AI
72023018	RAM MOUNT LOWRANCE ENDURA	79520201	COLLAR - AKA
72023021	RAM FISHFINDER MOUNT - FULL SI	79520211	AKA, RT FWD - TI



79520301	END CAP - AKA	81221011	PEDAL REPLACEMENT LEFT
79520311	AKA, LT FWD - TI	81222001	PEDAL / CRANK ASSY RIGHT
79520401	AKA, LT REAR - TI	81222011	PEDAL REPLACEMENT RIGHT
79520501	AKA, RT REAR - TI	81222101	CAP - PEDAL CRANK
79521001	AKA - LEFT/REAR AI	81226001	PEDAL STRAP REPLACEMENT RIGHT
79522001	AKA - RIGHT/REAR AI	81227001	PEDAL STRAP REPLACEMENT LEFT
79522201	LOCK BEARING, AKA XBAR	81230001	PEDAL ADJUSTMENT PIN
79523001	SOCKET - AKA BRACE LOCK	81236001	PEDAL ADJUST HANDLE ASSY
79523101	BRACE ASSY - AKA	81240001	ADJUSTMENT HANDLE (OSP)
79523201	BRACE ASSY - AKA V2 XBAR	81242001	SPRING COMPRESSION 1-1/4" LNG
79524001	CAP - AKA BRACE LOCK	81245001	ROLL PIN 1/8 x 1-1/4 (420 SS)
79525001	BALL - AKA BRACE	81259001	SEAT STRAP w/HOOK
79526001	BAG - AKA CARRY - AI	81265001	PLUG-IN SEAT PEG (OLDER)
79526002	BAG - AKA CARRY - TI	81265101	PLUG-IN SEAT CONNECTOR KIT ADJ
79526201	ISLAND PADDLE / AKA BRACE KIT	81266001	BACKREST MIRAGE 2009
79526211	PADDLE STORAGE WEB ASSY	81266011	SEATBACK GEAR PACK
79527001	TRAMP SET AI - BLACK	81267001	HOOK, KAYAK SEAT
79527011	TRAMP SET AI - GREY	81268001	KAYAK BACKREST MIRAGE 2010
79527101	LACING ROD - AI TRAMP	81340001	BUSHING - STAINLESS SPROCKET
79527201	TRAMP AI - WEB/BUCKLE ASSY	81350001	RUDDER MOUNT-MIR
79528001	SCREW 1/4-20 X 1-1/4 SCKT SET	81360001	RUDDER PIN MIRAGE S.S.
79530001	XBAR - REAR ASSY AI	81361001	RUDDER MOUNT PIN MIR 4-1/2"
79530201	XBAR, REAR - TI	81362001	RUDDER MOUNT PIN TDM/OUT/SPT
79531001	XBAR - FWD ASSY AI	81370001	STEERING CRANK
79531101	CLEAT SUPPORT WEDGE w/FAIRLEAD	81372001	STEERING CRANK ADV/OUTFITTER
79531111	CLEAT SUPPORT WEDGE	81375001	COMPRESSION SPRING (1)
79531201	XBAR, FWD - TI	81380001	CONTROL ARM - UP/DOWN
79532001	SPRING ASSEMBLY, ISLAND ADV	81390001	RUDDER MIRAGE - ORIGINAL STYLE
79533001	BEARING PLATE, MAST FURLER	81391002	RUDDER UP/DOWN LINE SYSTEM
79535001	CONNECTION PIN, AKA/XBAR	81392001	CONTROL ARM, TWIST-N-STOW RDR
79536001	CONNECTOR, AKA BRACE	81393001	THUMB SCREW 1/4-20 BLK NYLON
79537001	CLIP, ISLAND AKA BRACE KIT (2)	81394001	RUDDER PIN, TWIST N' STOW RDR
79538001	PADDLE CLIP, ISLAND XBAR	81394001	RUDDER PIN, TWIST N' STOW 2011 CENTERL
79538101	ISLAND PADDLE HOLDER KIT	81395001	RUDDER ASSY W/SM BLADE - TWIST
79538201	PULL TAB - WEBBING LOOP	81395201	RUDDER BLADE - SMALL / TWIST-N
79545001	DECAL, HOBIE DOME, BLK/GRAY	81396001	RUDDER ASSY W/LRG BLADE - TWIS
80010001	MIRAGE DRIVE	81397001	RUDDER BLADE - LARGE / TWIST-N
80010201	MIRAGEDRIVE SPARE PARTS KIT	81397101	i / QUEST - RUDDER BLADE - LAR
80010301	MIRAGEDRIVE "V2" SPARE PARTS K	81399001	BOLT TWIST-N-STOW DRUM
80012001	PEDAL RETAINER BUNJEE ASSY	81400001	TUBING HI-DENSITY PE
80013001	MIRAGE DRIVE - ST TURBO	81405001	STEERING TUBE HOLDER (UAI)
80013011	MIRAGE DRIVE - i SERIES	81405101	CAP - STEERING TUBE "O" RETAIN
80013201	MIRAGEDRIVE TURBO SPARE PARTS	81406001	DECAL / HANDLE - UP
80013301	MIRAGEDRIVE "V2" TURBO SPARE P	81407001	DECAL / HANDLE - DOWN
80020001	LINE KIT MIRAGE RUDDER / UNIVE	81408001	HANDLE, RUDDER PULL CORD
80025001	LINE CONTROL ASSY - (1) LINE A	81410001	CAM LOCK KNOB
80030001	SPEEDOMETER MIRAGE DRIVE	81420001	SPROCKET GUARD URE
80044021	HOBIE-TRAX CART FRAME	81450001	CHEEK BLOCK - HOBIE
80044031	HOBIE-TRAX CART PAD	81535001	CASSETTE PLUG-BLK (UAI)
80044051	HOBIE-TRAX HUB LOCK KNOB	81602101	SPRING CLICK-N-GO LEFT
80044101	HOBIE TRAX "2" CART PLUG-IN	81602201	SPRING CLICK-N-GO RIGHT
80044111	HOBIE TRAX "2" WHEEL REPLACE	81611101	CLICK-N-GO ASSY LEFT/PORT
80044201	CART POST COLLAR/CLAMP KIT	81611201	CLICK-N-GO ASSY RIGHT/STBD
80045000	CAP - HOBIE CART DOME	82300001	HOBIE STUFF
80045001	HOBIE STANDARD PLUG-IN CART	84431001	DVD / HOBIE - FISH THE WORLD
80045041	HOBIE STANDARD CART - WHEEL	84500001	SEAT ASSEMBLY - PRO ANGLER
80045101	i - HOBIE PLUG-IN CART / STAND	84500011	LUMBAR PAD PRO ANGLER
80046001	HOBIE HVY DUTY PLUG-IN CART	84500021	SEAT STRAP ASSY - PRO A
80048001	ROD HOLDER-BAIT CASTER w/LABEL	84500031	SEAT STRAP BUCKLE SS - PRO A
80048002	ROD HOLDER HEIGHT EXTENDER 8.5	84500101	RUDDER BLADE, PRO A
80048003	ROD HOLDER HEIGHT EXTENDER 6.5	84500201	RUDDER HOUSING, UNDER HULL
80049001	FLUSH DECK MOUNT, BLK	84500401	RDR MOUNT, UNDER HULL
80052001	SIDE/DECK MOUNT, BLK	84500501	RDR STEERING DRUM
80055001	ROD HOLDER-FLY w/DECK MNT	84500601	COVER PLT, RDR SYSTEM
80074001	STEERING LINE TUBE 68" (Pro A)	84500801	STEERING TUBE RESTRICTOR
81013001	STEERING HANDLE 2011	84500911	ROD HOLDER ASSY (L) - PRO A
81015001	STEERING HANDLE ASSY MIRAGE	84500921	ROD HOLDER ASSY (R) - PRO A
81023001	LINE-CONTROL 1.75 MM	84501001	B/U PLATE, ROD HOLDER
81030001	ZIP TIE, 6-5/16", BLK NYLON	84501101	GASKET, ROD HOLDER PLT
81035001	RUDDER UP/DOWN HANDLE ASSY W/S	84501201	THRU HULL BARB CONNECTOR
81035011	HANDLE - UP/DOWN RETRO KIT	84501301	HANDLE, STEERING SYSTEM
81037001	DRIVE SEAL / MIRAGE DRIVE	84501401	HOUSING, STEERING SYSTEM
81038001	DRIVE SEAL / i - MIRAGE DRIVE	84501511	KNOB, STEERING TENSION
81040001	OUTHHAUL BLOCK (STNLS SPKT)	84501521	WASHER, 3/16x 1/2 OD, RUBBER
81050001	OUTHHAUL BLOCK (INJ/MOLD)	84501531	BALL, STEERING SYSTEM, PRO A
81055001	SPROCKET GUARD FWD (INJ/MLD)	84501601	TUBE CONNECTOR, STEERING
81080001	SPROCKET SHAFT MIRAGE	84501901	HATCH LINER FWD - PRO ANGLER
81090001	DRUM SHAFT MIRAGE	84502001	MOUNTING BRD, RT, BLK
81100001	CRANK LEFT MIRAGE (THREADED)	84502101	MOUNTING BOARD, LT
81105001	CRANK RIGHT MIRAGE (THREADED)	84502201	CUTTING BRD, CNTR, BLACK
81110001	SHAFT #5 MIRAGE	84502301	SISTER SCREW, PRO RDR ASSY
81121001	IDLER PULLEY (PLASTIC DRUM)	84502601	STEERING TENSION SCREW
81128001	SPROCKET W/SET SCREW (INJ/MLD)	84502901	KNOB, SEAT FRONT
81129001	SPROCKET V2 - THREADED W/GUARD	84504001	TORSION SPRING, RUDDER
81129022	V2 SPROCKET / MAST KIT STD (PA	84504101	SIDE HANDLE ASSY - UNIVERSAL
81129122	V2 SPROCKET / MAST KIT TURBO (	84504201	TUBE, STERN HANDLE
81130001	SPROCKET MIRAGE - STAINLESS	84504301	DECAL, RULER
81155001	BOLT DRUM/CRANK	84504401	HANDLE END FITTING
81160001	MAST, MIRAGE DRIVE, STD (UNIVE	84504501	HANDLE BOW - PRO ANGLER
81163001	MAST - V2 STANDARD - THREADED	84505001	STORAGE BUCKET ASSY
81171001	DRUM PLASTIC MIRAGE	84505101	STORAGE BUCKET COMPARTMENT
81172001	DECAL, PEDAL ADJUSTMENT	84505201	STORAGE BUCKET COMPARTMENT DIV
81173001	DRUM - V2	84506001	STEERING ASSEMBLY (Pro A)
81181001	SPINE MIRAGE DRIVE - PLASTIC	84506201	STEERING (PRO A) REVERSIBLE AS
81190001	FIN - MIRAGEDRIVE STANDARD	84509001	BATTEN CAP 1/8 DIA - KAYAK SAI
81192001	MIRAGE ST TURBO FIN (w/PIN & R	84513001	SAIL KIT KAYAK TURQ/PAPAYA
81193001	MIRAGE ST FIN (w/PIN & RING)	84514001	SAIL KIT KAYAK WHITE/RED
81198001	MAST - ST TURBO FIN/UNIVERSAL	84515001	SAIL KIT KAYAK WHITE/TURQ
81198101	MAST - V2 ST TURBO - THREADED	84516001	SAIL KIT KAYAK SILVER/WHITE
81201001	MIRAGEDRIVE CHAIN ASSY MIRAGE	84550001	MAST RECEIVER - MIRAGE KAYAK S
81202001	CHAIN ASSY, MIRAGEDRIVE V2	84560001	CAP PLASTIC MAST RECEIVER
81203001	IDLER CABLE, MIRAGEDRIVE V2	84965001	DOWNHAUL HOOK-SAIL ADAPTOR
81211001	IDLER CABLE ASSY (14 3/4) MIRA	86000001	OWNER'S MANUAL-MIRAGE
81212001	IDLER CABLE ASSY (14 1/4") MIR	88523101	BRACE ASSY - AKA TI
81214201	SPRING COMPRESSION 1-1/4" LNG	88527001	TRAMP SET TI - BLACK
81221001	PEDAL / CRANK ASSY LEFT	88527011	TRAMP SET TI - GREY

OS  
OS  
OS  
OS

88536001	CONNECTOR, AKA BRACE TI		5131LG	T-SHIRT FISHING LG
88991001	CENTERBOARD TDM ISLAND		5131MD	T-SHIRT FISHING MD
88991011	CENTERBOARD TOP CVR-TDM ISLAND		5131XL	T-SHIRT FISHING XL
88991021	CENTERBOARD PIN-TDM ISLAND		5131XXL	T-SHIRT FISHING XXL
88991031	PIN HOLDER-TDM ISLAND		5351B	HATCH COVER KIT 5" BLACK
88991041	KNOB-TDM ISLAND		5351W	HATCH COVER KIT 5" WHITE
88991061	SIDE CARRY HANDLE-TDM ISLAND		72000B	POUCH GUSSETED 6x12
88991071	FURLER DRUM - TDM ISLAND		72005B	POUCH SUPER GUSSETED 8x15
88991094	GUDGEON, AI/TI		72070A	ROD HOLDER ASSY (KAYAK)
88991101	RUDDER PIN-TDM ISLAND		72210T	SEE BAG 8" x 14"
88991121	MAST-TDM ISLAND (550 CM)		72230T	SEE BAG 11" x 19"
88991150	KNOB CAP-TDM ISLAND		80035A	ANCHOR w/BAG & LINE (3 LB)
88991151	DOVE DECAL, H LOGO		H082	BLOCK-SINGLE BULLET
88991185	RUDDER ASSY TI		H083	BLOCK-BULLET W/BECKET
88991187	RUDDER BLADE TI		H092	BLOCK-BULLET CHEEK
88991191	V-FRAME STRUT 3/8-TDM ISLAND		H166	BLOCK-BULLET SWIVEL
88991201	V-FRAME BASE 3/8-TDM ISLAND		H167	BLOCK-BULLET SWIVEL W/BECKET
88991301	STEERING HANDLE-TDM ISLAND (UA)		H224	BLOCK-MICRO SINGLE
88991303	AMA - TDM ISLAND PAPAYA		H225	BLOCK-MICRO W/BECKET
88991304	AMA - TDM ISLAND HIBISCUS		H233	BLOCK-MICRO CHEEK
88991305	AMA - TDM ISLAND DUNE		H2655	BLOCK, 40mm CARBO FIDDLE
88991351	KNOB - STEERING HANDLE		H281	EYESTRAP-MICRO SS
88991352	KNOB CAP		H284	KIT-MICRO WIRE FAIRLEAD
88991355	KNOB ASSY, STEERING HANDLE		H297	WEDGE KIT-MICRO CAM
88998521	BATTEN TI #1 1/4" x 186" W/CAP		H350	29mm CARBO CHEEK
88998522	BATTEN TI #2 3/16" x 42.5" W/		H404	BLOCK-16MM AIR FXD SGL
88998523	BATTEN TI #3 3/16" x 39.5" W/		H405	BLOCK-16MM AIR FIXED SGL W/BKT
88998531	BATTEN CAP 1/4 DIA		H406	BLOCK-16MM AIR FIXED DOUBLE
89000001	OWNER'S MANUAL-MIRAGE SPORT		H407	BLOCK-16MM AIR FIXED DBL W/BKT
89500001	OWNER'S MANUAL-ADVENTURE/OUTFI		H424B	FAIRLEAD MICRO CAM - BLK
90610111	DELRLN BALL 3/8 DIA - FURLERS		H427	CAM-MICRO CARBO W/WIRE FAIRLEA
91011001	BATTEN CAP 3/16 DIA		H471	CAM CLEAT-MICRO CARBO
91041011	BATTEN 3/16 FG ROD, 7' 8-1/2"		RH014WHT	LINE 1/4" STRAIT-CORE POLY
91050010	HOOK WHT NYLON SEW-ON		RH018WHT	LINE 1/8" NYLON BRAID WHITE
91050020	HOOK BLK NYLON SEW-ON		RH038WHT	LINE 3/8" STRAIT-CORE POLY
91051011	BATTEN 3/16 FG ROD, 9' 2"		RH112WHT	LINE 1/12" NYLON BRAID WHITE
99303001	ISLAND AMA REPL-PAPAYA	OS	RH316WHT	LINE 3/16" STRAIT-CORE POLY
99304001	ISLAND AMA REPL-HIBISCUS	OS	RH516WHT	LINE 5/16" STRAIT-CORE POLY
99305001	ISLAND AMA REPL-DUNE	OS	RM014BLK	LINE 1/4" SPUN DACRON - BLACK
99403001	ISLAND AMA KIT - PAPAYA	OS	RM014BLU	LINE 1/4" SPUN DACRON - BLUE
99404001	ISLAND AMA KIT - HIBISCUS	OS	RM014RED	LINE 1/4" SPUN DACRON - RED
99405001	ISLAND AMA KIT - DUNE	OS	RM014WHT	LINE 1/4" SPUN DBL BRD - WHITE
99503001	ISLAND CONVERSION KIT - PAPAYA	OS	RM038BLK	LINE 3/8" SPUN DACRON - BLACK
99504001	ISLAND CONVERSION KIT-HIBISCUS	OS	RM038BLU	LINE 3/8" SPUN DACRON - BLUE
99505001	ISLAND CONVERSION KIT - DUNE	OS	RM038RED	LINE 3/8" SPUN DACRON - RED
99600001	INSTALL TOOLS - MAST HOLE SAW		RM038WHT	LINE 3/8" SPUN DBL BRD - WHITE
99603001	ISLAND SAIL KIT - YELLOW-WHT	OS	RM516BLK	LINE 5/16" SPUN DACRON - BLK
99604001	ISLAND SAIL KIT - RED-WHT	OS	RM516BLU	LINE 5/16" SPUN DACRON - BLUE
99605001	ISLAND SAIL KIT - SILVER-WHT	OS	RM516RED	LINE 5/16" SPUN DACRON - RED
1553CR	CROAKIES "HOBIE"		RM516WHT	LINE 5/16" SPUN DBL BRD-WHITE
1553L	LID LATCH MULTI-COLOR		RM716BLK	LINE 7/16" SPUN DACRON - BLACK
1562BLK	SUNGLASS HOBIE PLAYA BLACK		RM716BLU	LINE 7/16" SPUN DACRON - BLUE
1563BLK	SUNGLASS HOBIE O'SIDE BLACK		RM716RED	LINE 7/16" SPUN DACRON - RED
1825WHT	TOYBOX	OS	RM716WHT	LINE 7/16" SPUN DACRON - WHITE
3187LG	GLOVES - FULL FINGER LARGE		RS014BLK	SHOCKCORD 1/4" BLACK
3187MD	GLOVES - FULL FINGER MEDIUM		RS018BLK	SHOCKCORD 1/8" BLACK
3187SM	GLOVES - FULL FINGER SMALL		RS038BLK	SHOCKCORD 3/8" BLACK
3187XL	GLOVES - FULL FINGER X LARGE		RS316BLK	SHOCKCORD 3/16" BLACK
3187XS	GLOVES - FULL FINGER X SMALL		RS516BLK	SHOCKCORD 5/16" BLACK
3187XXS	GLOVES - FULL FINGER XX SMALL		RS716BLK	SHOCKCORD 7/16" BLACK
3188LG	GLOVES HOBIE LARGE		S6142LG	PFD WEDGE-E ST'QUIST LG
3188MD	GLOVES HOBIE MEDIUM		S6142MD	PFD WEDGE-E ST'QUIST MD
3188SM	GLOVES HOBIE SMALL		S6142SM	PFD WEDGE-E ST'QUIST SM
3188XL	GLOVES HOBIE X LARGE		S6142XL	PFD WEDGE-E ST'QUIST XL
3850LG	HOBIE SPRAY TOP LG		S6142XXL	PFD WEDGE-E ST'QUIST XXL
3850MD	HOBIE SPRAY TOP MD		S6143LXL	PFD HI-BACK ZIP MANGO LXL
3850SM	HOBIE SPRAY TOP SM		S6143SMD	PFD HI-BACK ZIP MANGO SMD
3850XL	HOBIE SPRAY TOP XL		S6143XXL	PFD HI-BACK ZIP MANGO XXL
3851MD	HOBIE RASHGUARD - SS MD		S6144LXL	PFD HI-BACK ZIP GREEN LXL
3851XL	HOBIE RASHGUARD - SS XL		S6144SMD	PFD HI-BACK ZIP GREEN SM
3852MD	HOBIE RASHGUARD - LS MD		S6144XXL	PFD HI-BACK ZIP GREEN XXL
3853LG	HOBIE - SHORTY 2/2 LG RED/BLK		S6145LXL	PFD HIBACK MANGO LXL -ULC
3853MD	HOBIE - SHORTY 2/2 MD RED/BLK		S6145SMD	PFD HIBACK MANGO SMD -ULC
3853SM	HOBIE - SHORTY 2/2 SM RED/BLK		S6146MLG	PFD HI-BACK P-BLUE (W) MLG
3853XL	HOBIE - SHORTY 2/2 XL RED/BL		S6146PS	PFD HI-BACK P-BLUE (W) PS
3854LG	HOBIE - FULL 3/2 LG RED/BLK		S6146XSS	PFD HI-BACK P-BLUE (W) XSS
3854MD	HOBIE - FULL 3/2 MD RED/BLK		S6779R	PFD INFLATABLE REARM KIT
3854SM	HOBIE - FULL 3/2 SM RED/BLK		S6779RG	PFD INFLATABLE RED/GRAY
3854XL	HOBIE - FULL 3/2 XL RED/BLK		S6779TG	PFD INFLATABLE TAN/GRAY
3855LG	HOBIE - SHORTY 2/2 LG BLACK		S6780RG	PFD BELT PACK INFLATABLE RED/G
3855MD	HOBIE - SHORTY 2/2 MD BLACK		SBV3120YEL	PFD CHILD (30-50LB) RED
3855SM	HOBIE - SHORTY 2/2 SM BLACK		SBV3122YEL	PFD YOUTH (50-90LB) RED
3855XL	HOBIE - SHORTY 2/2 XL BLACK		SP150041	SHACKLE 5/32 X 3/8 X 5/8
3856LG	HOBIE - FULL 3/2 LG BLACK		SP150051	SHACKLE 3/16x1/2x11/16
3856MD	HOBIE - FULL 3/2 MD BLACK		SP150052	SHACKLE 3/16 x 5/8 x 5/16
3856XL	HOBIE - FULL 3/2 XL BLACK		SP150053	SHACKLE 3/16 X 5/8 X 1-7/16
5018BK	HAT HOBIE "H" BLACK		SP150061	SHACKLE 1/4x9/16x15/16
5018BL	HAT HOBIE "H" BLUE / GOLD		SP170005	SHACKLE TWISTED SS 3/16
5018GM	HAT HOBIE "H" GREY MESH		SP170006	SHACKLE TWISTED SS 1/4
5018RM	HAT HOBIE "H" RED MESH		SP180005	SHACKLE KEY PIN 3/16"
5018TG	HAT HOBIE "H" TAN w/ GREEN LOG		SP180006	SHACKLE KEY PIN 1/4"
5019BK	HAT "HOBIE" 6-PANEL LO PRO BLK		SP185205	SHACKLE KEY PIN 3/16"
5022FK	HAT - FISH FLEXFIT KHAKI		V1093	SCREW-IN DECKPLATE 5" CRVD WH
5022FO	HAT - FISH FLEXFIT OLIVE		V1130	SCREW-IN DECKPLATE 4" CRVD WH
5022TK	HAT - FISH TRUCKER KAHKI		V1131	SCREW-IN DECKPLATE 4" CRVD BL
5022TO	HAT - FISH TRUCKER OLIVE		V1145	SCREW-IN DECKPLATE 6" WHITE W
5023PP	HAT-PERFORMANCE CAP PUMPKIN		V1146	SCREW-IN DECKPLATE 6" BLACK W
5023TO	HAT-TWILL CAP OAR WASHED			
5023TS	HAT-TRUCKER BOA GREEN/STONE			
5023VS	HAT-VISOR STONE WASHED TWILL			
5129LG	T-SHIRT KAYAK LG BLK			
5129MD	T-SHIRT KAYAK MD BLK			
5129XL	T-SHIRT KAYAK XL BLK			
5130LG	T-SHIRT KAYAK LG GREY			
5130MD	T-SHIRT KAYAK MD GREY			
5130XL	T-SHIRT KAYAK XL GREY			



# Hobie®

# ENJOY THE RIDE



The Hobie MirageDrive is redefining how the world views inflatable kayaks. With the supplied pump, they inflate easily, deflate quickly, and are ideal for the kayaker who's short on space and storage. Packed in their own rolling travel bags, they fit easily in the trunk of your car, on your boat or in your RV - you can even take them on your next vacation.



[hobie kayaks.com](http://hobie kayaks.com)

 H O B I E





**HOBIE CAT COMPANY**  
Oceanside, California U.S.A.  
1-800-HOBIE-49  
hobiecat.com

**HOBIE CAT AUSTRALASIA**  
Huskisson, New South Wales Australia  
1-800-4-HOBIE  
hobiecat.com.au

**HOBIE KAYAK EUROPE**  
Stellendam  
The Netherlands  
+31 (0) 187 499 440  
hobie-kayak.com

**ENJOY THE  
RIDE**



**PARTS & ACCESSORIES**

[hobiecat.com](http://hobiecat.com)

